

Total Area Approx sq ft

95 Roundhill Crescent, Brighton, BN2 3GP

To view, contact John Hilton:
52 High Street, Rottingdean, BN2 7HF
132-135 Lewes Road, Brighton, BN2 3LG
01273 608151 or sales@johnhiltons.co.uk

PCM £1,500 PCM

95 Roundhill Crescent, Brighton, BN2

3GP

A high quality, refurbished one double bedroom property available at £1,500pcm available from 03 September 2026. The property is fully furnished throughout and benefits from all new white goods, including a washer/dryer. It offers a separate living room with a bay window, a modern newly fitted bathroom with a contemporary shower, and access to a private patio garden. Located in a popular residential area close to well-regarded schools, the property is ideal for a professional tenant.

- 1 Double Bedroom Property £1500pcm
- 03 September 2026
- High quality newly refurbished property, fully furnished.
- All new white goods including a washer/dryer.
- Separate living room with bay window
- New bathroom with modern shower.
- Patio garden
- Popular location, schools
- No pets. (building policy)
- Council tax band A
- 11 month tenancy.

- A holding deposit of £346.15 will be required to secure the Property which is equivalent to 1 weeks rent. Once referencing is complete the Holding Deposit will go towards the first month's rent
- The above details are intended for information purposes only and do not constitute an offer or form part of a contract. A tenancy will be granted subject to referencing and contracts

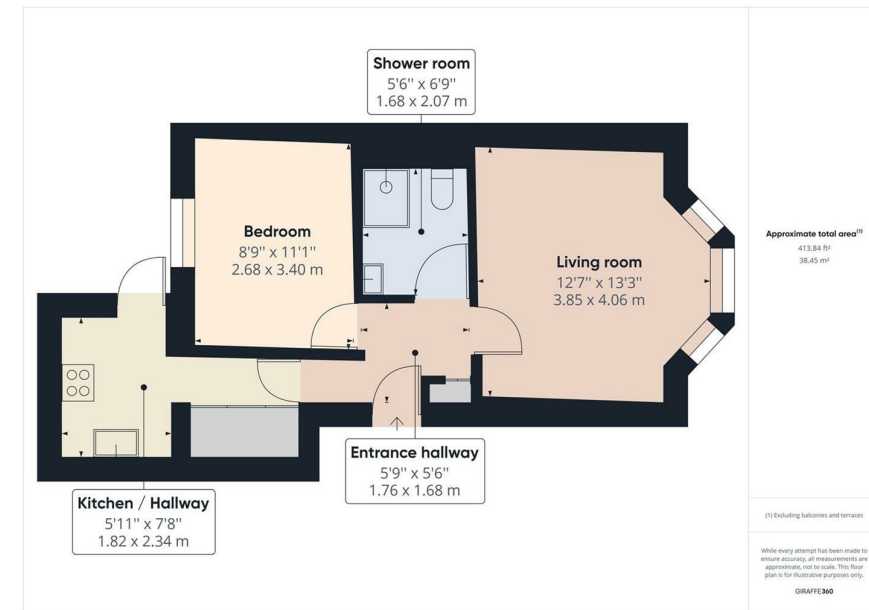

Energy Efficiency Rating		Current	Potential
Very energy efficient - lower running costs			
(92 plus) A			
(81-91) B			
(69-80) C			
(55-68) D			
(39-54) E			
(21-38) F			
(1-20) G			
Not energy efficient - higher running costs			
England & Wales	EU Directive 2002/91/EC		

Council Tax Band: **A**