



Jermyn Street, SW1Y

£495 Per week

A charming, furnished studio on the third floor with lift access and on site porter. The property comprises an open plan kitchen and separate bathroom.

The building is located in the centre of London's oldest district and is close to the many amenities of St. James's, Mayfair, Piccadilly and Soho. Piccadilly and Green Park are the nearest tube stations offering variety of train lines such as the Piccadilly, Jubilee and Victoria lines.

Features

Well-Presented Studio
Furnished
Third Floor
Lift Access
Porter
Excellent Location



Jermyn Street, SW1Y



Jermyn Street,
London, SW1Y

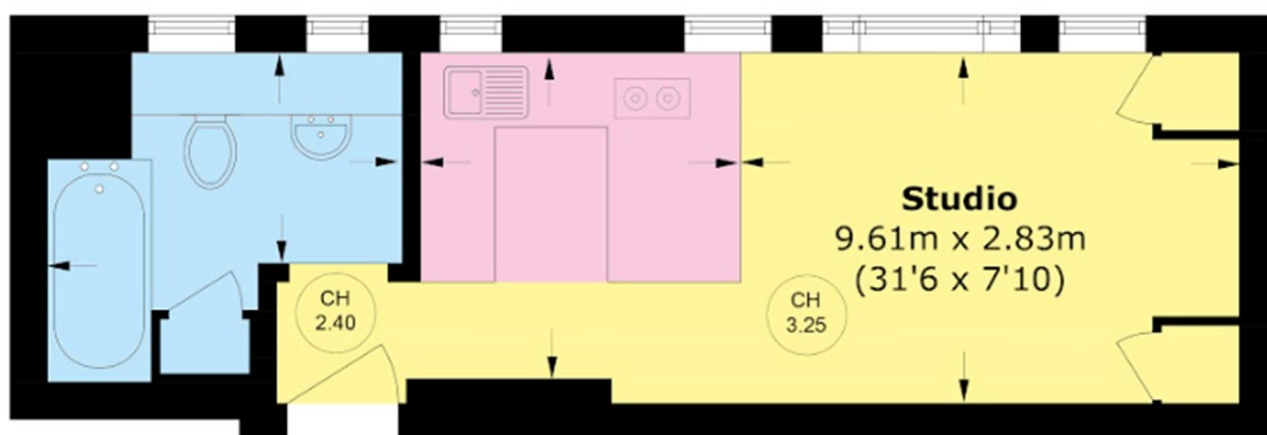

Second Floor

Total area (approx.): 26.8 sq. m (288.4 sq. ft)

Dexters

Wetherell
102 Mount Street
London
W1K 2TH
Lettings
020 7529 5588

Energy Rating: . We aim to make our particulars both accurate and reliable. However they are not guaranteed; nor do they form part of an offer or contract. If you require clarification on any points then please contact us, especially if you're traveling some distance to view. Please note that appliances and heating systems have not been tested and therefore no warranties can be given as to their good working order.



dexters.co.uk