



The Barons, TW1

£599,950

Situated on a sought after road within St Margarets village, is this spacious two bedroom period conversion apartment featuring high ceilings and plenty of charm and character. The property is well-presented, sold with no onward chain and includes a private rear garden. This property is not to be missed.

The Barons is a popular residential road in St Margarets village, ideal for local amenities such as a selection of cafés, restaurants, shops and train station to London Waterloo. The River Thames, Marble Hill Park and Moor Mead Park are also close by. As well as local primary and secondary schools such as St. Stephen's C.E. Primary School and Orleans Park School.

Features

- Two Bedroom Apartment
- Private Rear Garden
- No Onward Chain
- Off-Street Parking
- Beautifully Presented
- Central Village Location

The Barons, St Margarets, TW1

Ground Floor

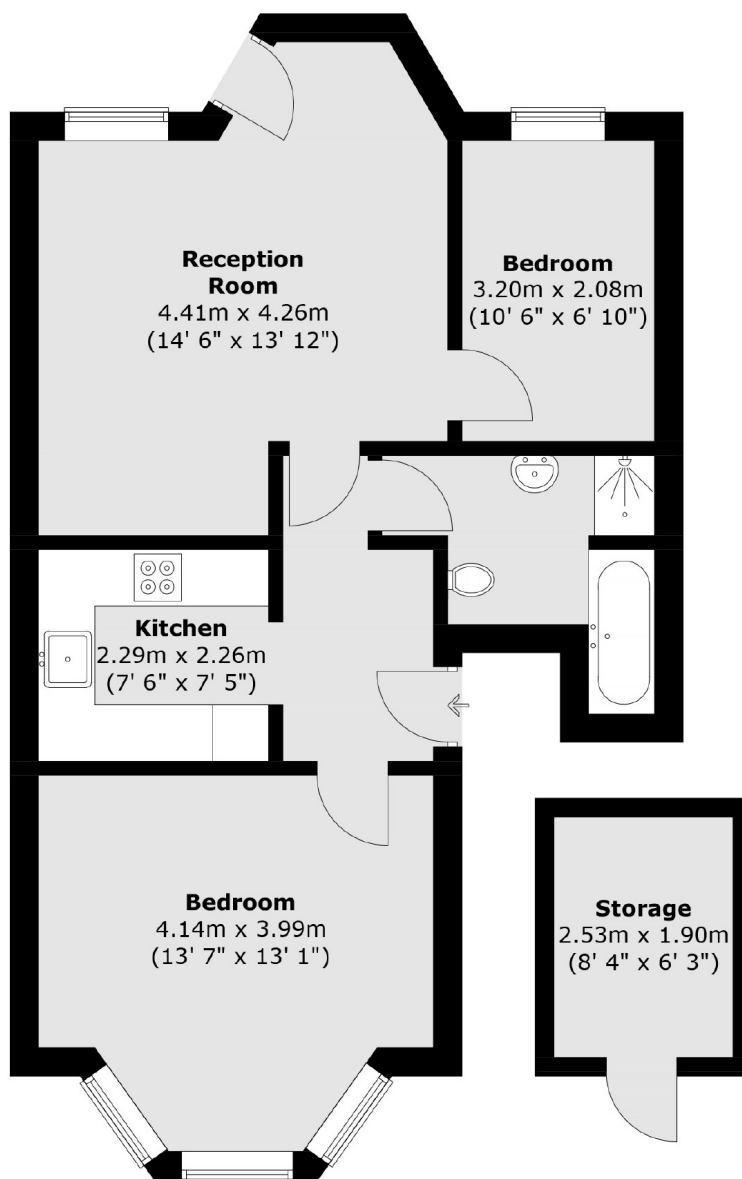

Total area (approx.) : 59.7 sq. m (643 sq. ft)
Total storage area (approx.) : 5 sq. m (54 sq. ft)