



KENSINGTON CHURCH STREET, W8

£500,000

- One bedroom
- One bathrooms
- Study
- Includes branded appliances
- Great Kensington location
- Leasehold



ABOUT THE PROPERTY

A one bedroom flat with a study and has had a full back to brick refurbishment to include branded appliances with wooden floors in a prime Kensington location.

Superbly located in this thriving part of Kensington with a truly impressive array of eateries, cafes, restaurants and shops on your doorstep. Both Kensington High Street and Notting Hill Gate are a short walk away and the wonderful open spaces of Kensington Gardens and Hyde Park are also close by.



STEP INSIDE

KENSINGTON CHURCH STREET

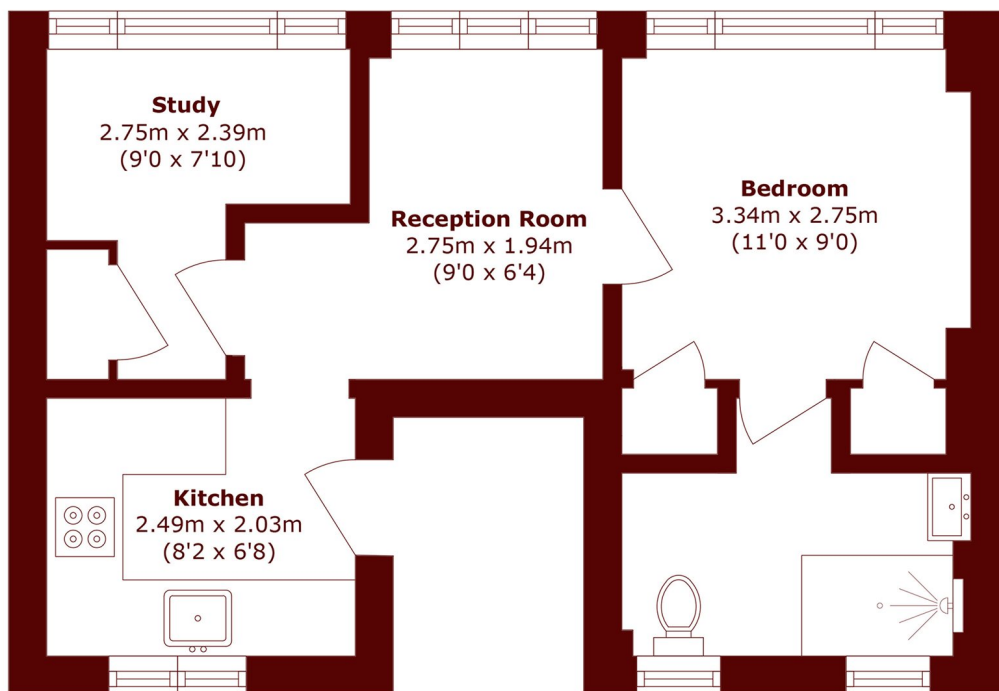

First Floor

Total area (approx.): 30.2 sq. m (325.0 sq. ft)

Kensington
020 7368 4450

Energy Rating: C We aim to make our particulars both accurate and reliable. However, they are not guaranteed; nor do they form part of an offer or contract. If you require clarification on any points then please contact us, especially if you're traveling some distance to view. Please note that appliances and heating systems have not been tested and therefore no warranties can be given as to their good working order

MARSH &
PARSONS