

York Road

Approximate Gross Internal Area = 695 sq ft / 64.6 sq m

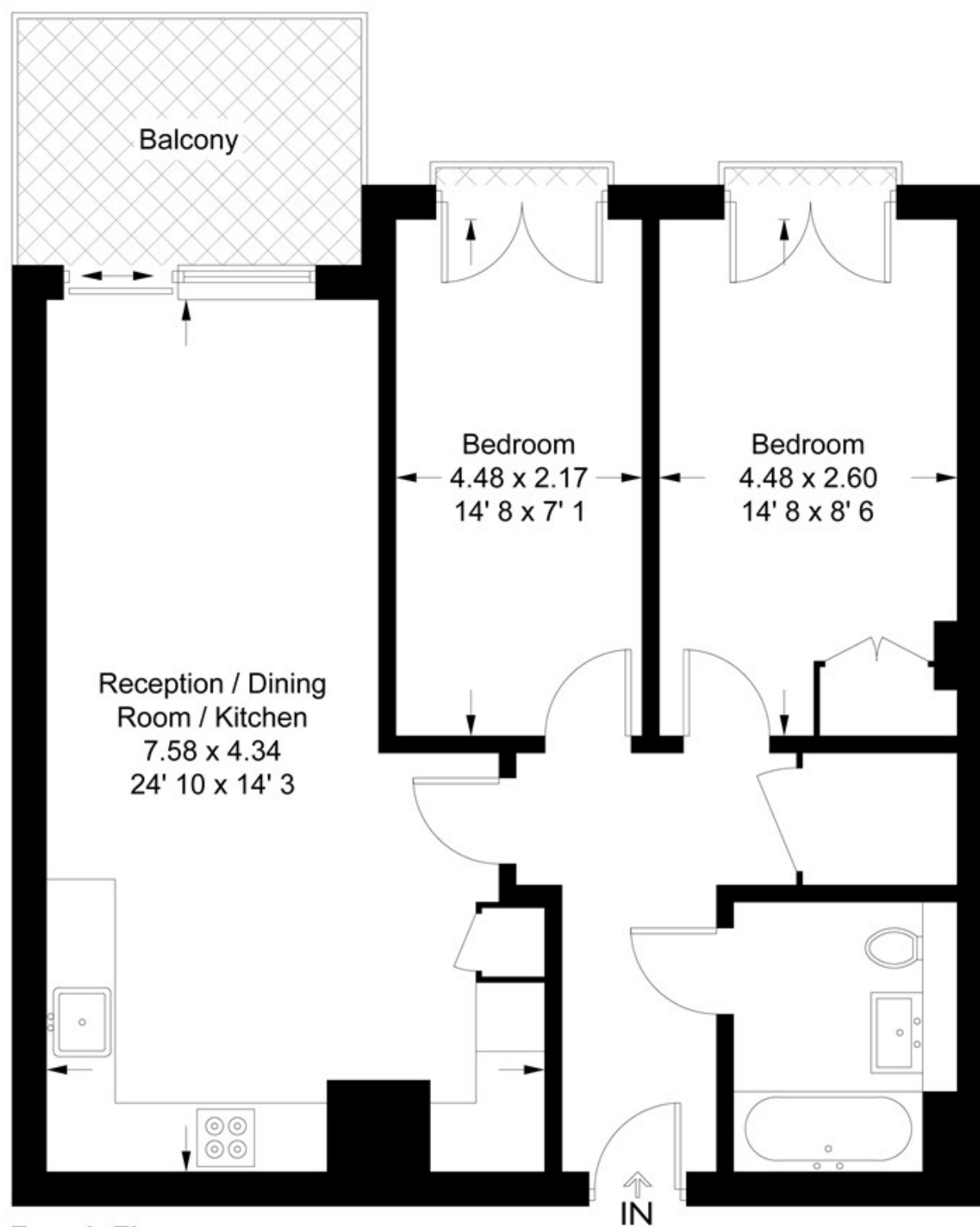

Fourth Floor

This plan is not to scale and must be used as layout guidance only. All measurements and areas are approximate and should not be relied upon to provide accurate information. This plan must not be relied upon when making property valuations, design considerations or any other such relevant decisions. We accept no responsibility or liability (whether in contract, tort or otherwise) in relation to any loss whatsoever arising from or in connection with any use of this plan or the adequacy, accuracy or completeness of it or any information within it.



York Road, Battersea

£2,650 PCM

- Two bedrooms
- Dishwasher
- Concierge
- Balcony
- Fitted kitchen
- Underfloor heating
- Communal garden
- Bike storage

York Road, Battersea

Petty Son & Prestwich are thrilled to offer to rent this spacious two double bedroom apartment situated in the New York Road development, featuring a private balcony and communal gardens.

 2

 1

 1

 B

Council Tax Band: E



Close to the open green space of Battersea Park and Clapham Junction station, the property is perfectly situated to offer residents everything within a short walk from the front door.

The property is comprised of a generous reception with direct access to a private balcony, two bedrooms and a modern fitted kitchen and bathroom. The finish of the new flat is superb, the stylish kitchen benefits from a range of integrated appliances, including a dishwasher and washer/dryer. The fifth floor provides access to the buildings lovely communal garden. The development also benefits from a concierge service, underfloor heating and bike storage.

Available 24th March 2026

Furnished

EPC Rating: B86

Council Tax Band: E

1 Week Holding Deposit: £611

5 Week Total Deposit: £3057

NEW ASSURED SHORTHOLD TENANCIES (ASTs)
SIGNED ON OR AFTER 1 JUNE 2019*

Holding Deposit (per tenancy) - One week's rent. This is to reserve a property. Please Note: This will be withheld if any relevant person (including any guarantor(s)) withdraw from the tenancy, fail a Right-to-Rent check, provide materially significant false or misleading information, or fail to sign their tenancy agreement (and / or Deed of Guarantee) within 15 calendar days (or other Deadline for Agreement as mutually agreed in writing).

Security Deposit (per tenancy and where Rent is under £50,000 per year) - Five weeks' rent. This covers damages or defaults on the part of the tenant during the tenancy.

Security Deposit (per tenancy and where Rent of £50,000 or over per year) - Six weeks' rent. This covers damages or defaults on the part of the tenant during the tenancy.

Unpaid Rent - Interest at 3% above the Bank of England Base Rate from Rent Due Date until paid in order to pursue non-payment of rent. Please Note: This will not be levied until the rent is more than 14 days in arrears.

Lost Key(s) or other Security Device(s) - Tenants are liable to the actual cost of replacing any lost key(s) or other security device(s). If the loss results in locks needing to be changed, the actual costs of a locksmith, new lock and replacement keys for the tenant, landlord any other persons requiring keys will be charged to the tenant. If extra costs are incurred there will be a charge of £15 per hour (inc. VAT) for the time taken replacing lost key(s) or other security device(s).

Variation of Contact (Tenants Request) - £50 (inc. VAT) per agreed variation. To cover the costs associated with taking landlord's instructions as well as the preparation and execution of new legal documents.

Change of Sharer (Tenant's Request) - £50 (inc. VAT) per replacement tenant or any reasonable costs incurred if higher. To cover the costs associated with taking landlord's instructions, new tenant referencing and Right-to-Rent checks, deposit registration as well as the preparation and execution of new legal documents.

Early Termination (Tenant's Request) - Should the tenant wish to leave their contract early, they shall be liable to the landlord's costs in re-letting the property as well as all rent due under the tenancy until the start date of the replacement tenancy. These costs will be no more than the maximum amount of rent outstanding on the tenancy.

Please ask a member of staff if you have any questions about our fees.