



Manchester Street, W1U

£775 Per week

This ground floor apartment forms part of a Georgian conversion in the heart of Marylebone Village, with a double bedroom and reception to the front of the building, and a large kitchen/diner and separate shower room to the rear.

Manchester Street is moments from Marylebone High Street, which is home to a variety of boutique shops, bars, cafes and restaurants. Bond Street and Baker Street stations are close by.

Features

- Ground Floor Flat
- One Bedroom
- Shower Room
- Owned and Managed by The Portman Estate
- Complimentary Membership to Portman Concierge

Manchester Street, London, W1U

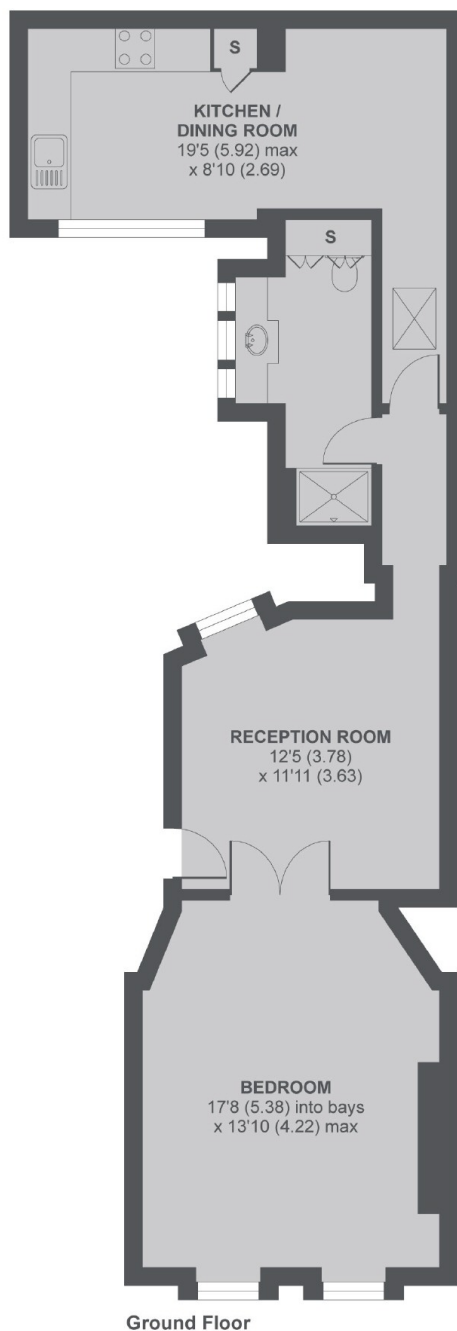

Manchester Street, London, W1U

MAIN HOUSE APPROX FLOOR AREA 681 SQ.FT 63.2 SQ.M

Copyright nichecom.co.uk 2017 REF : 214070

Dexters

Marylebone
53-55 Weymouth Street
London
W1G 8NJ
Lettings
0207 224 5545

Energy Rating: C. We aim to make our particulars both accurate and reliable. However they are not guaranteed; nor do they form part of an offer or contract. If you require clarification on any points then please contact us, especially if you're traveling some distance to view. Please note that appliances and heating systems have not been tested and therefore no warranties can be given as to their good working order.

 **RICS** | Regulated
Estate Agent
and Letting Agent

dexters.co.uk