



Stockwell Road, SW9

£2,700 Per calendar month

Internally this three double bedroom flat offers a reception room, spacious kitchen with a small balcony and a modern family bathroom. Ideal for professional sharers who regularly commute into the City.

Burford House on Stockwell Road is located between both Stockwell tube station and Brixton tube/overground station, with many local amenities close by.

Features

- Three Double Bedrooms
- Reception Room
- Modern Kitchen
- Small Balcony
- Family Bathroom
- Close To Tube

Stockwell Road,
London, SW9

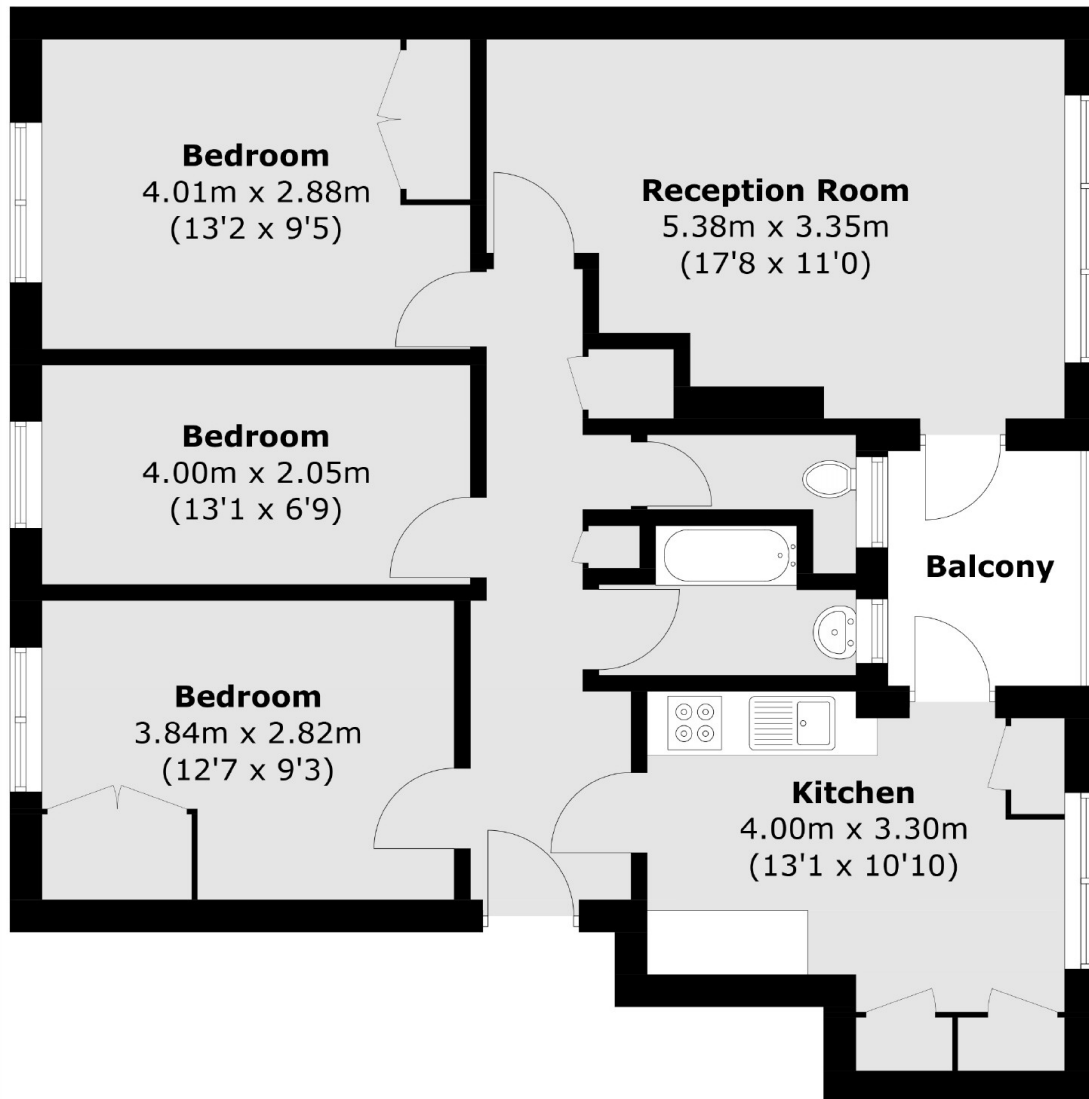

Total area (approx.): 76.3 sq. m (821.2 sq. ft)
Balcony: 3.9 sq. m (41.9 sq. ft)

Dexters

Clapham High Street
55 Clapham High Street
London
SW4 7TG
Lettings
020 7483 6364

Energy Rating: C. We aim to make our particulars both accurate and reliable. However they are not guaranteed; nor do they form part of an offer or contract. If you require clarification on any points then please contact us, especially if you're traveling some distance to view. Please note that appliances and heating systems have not been tested and therefore no warranties can be given as to their good working order.

 **RICS** | Regulated
Estate Agent
and Letting Agent

dexters.co.uk