



55 Helston Drive, Royton, Oldham, OL2 6JT

£249,950

3 1 3

- Extended Semi Detached
- Three/Four Bedrooms
- Three/Four Reception Rooms
- Fantastic Area
- Lovely Size Driveway
- West Facing Rear Garden
- EV Charging
- EPC: C



Offered for sale is this lovely extended three bedroom semi detached family home.

Located in this popular development in Royton.

Accommodation comprising: Entrance hallway, lounge, kitchen, dining room, snug/living room and a conservatory with a solid roof.

To the first floor there are three bedrooms and a bathroom.

Externally there is a west facing rear garden and block built 12 x 6 shed.

To the front is a good size block paved driveway and EV charger.

Close to quality schools and Royton.

Contact us today to book a viewing.



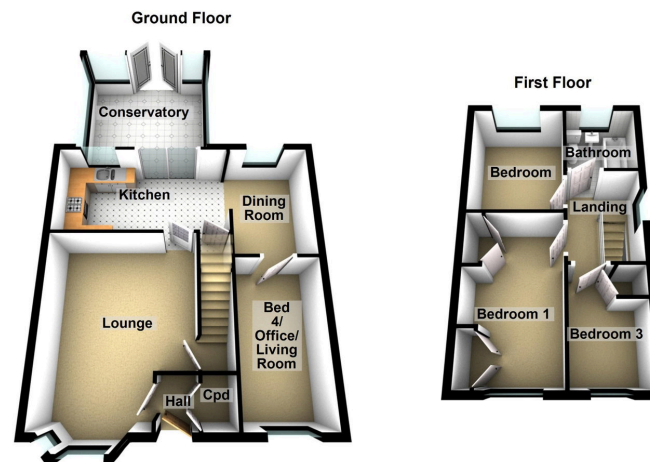

Energy Efficiency Rating		
	Current	Potential
<i>Very energy efficient - lower running costs</i>		
(92 plus) A		
(81-91) B		87
(69-80) C	75	
(55-68) D		
(39-54) E		
(21-38) F		
(1-20) G		
<i>Not energy efficient - higher running costs</i>		
England & Wales	EU Directive 2002/91/EC	

Chadderton Office
 509 Middleton Road,
 Chadderton, Oldham,
 OL9 9SH

chadderton@kirkham-property.co.uk
 t: 0161 626 5688