



Inglemere Road, CR4 £500,000

A two bedroom, two bathroom lateral apartment with a parking space available for purchase by separate negotiation. This EPC rated 'A' property, with two large bedrooms, plenty of storage and a large balcony/roof terrace. You will be able to enjoy very low bills in your new home thanks to, rainwater harvesting, solar panels, electricity storage and a mechanical ventilation system.

Amplified by an extensive bus network, every facet of city life and beyond is at your doorstep when residing at Park Apartments. Dive into the perfect blend of comfort and connectivity in Tooting's premier residence!

Features

- Last Few Homes Available
- Two Double Bedrooms
- Large Balcony/Terrace
- Solar Panels
- Highly Energy Efficient
- Mechanical Ventilation System
- Close To The Station

Inglemere Road,
Tooting, CR4

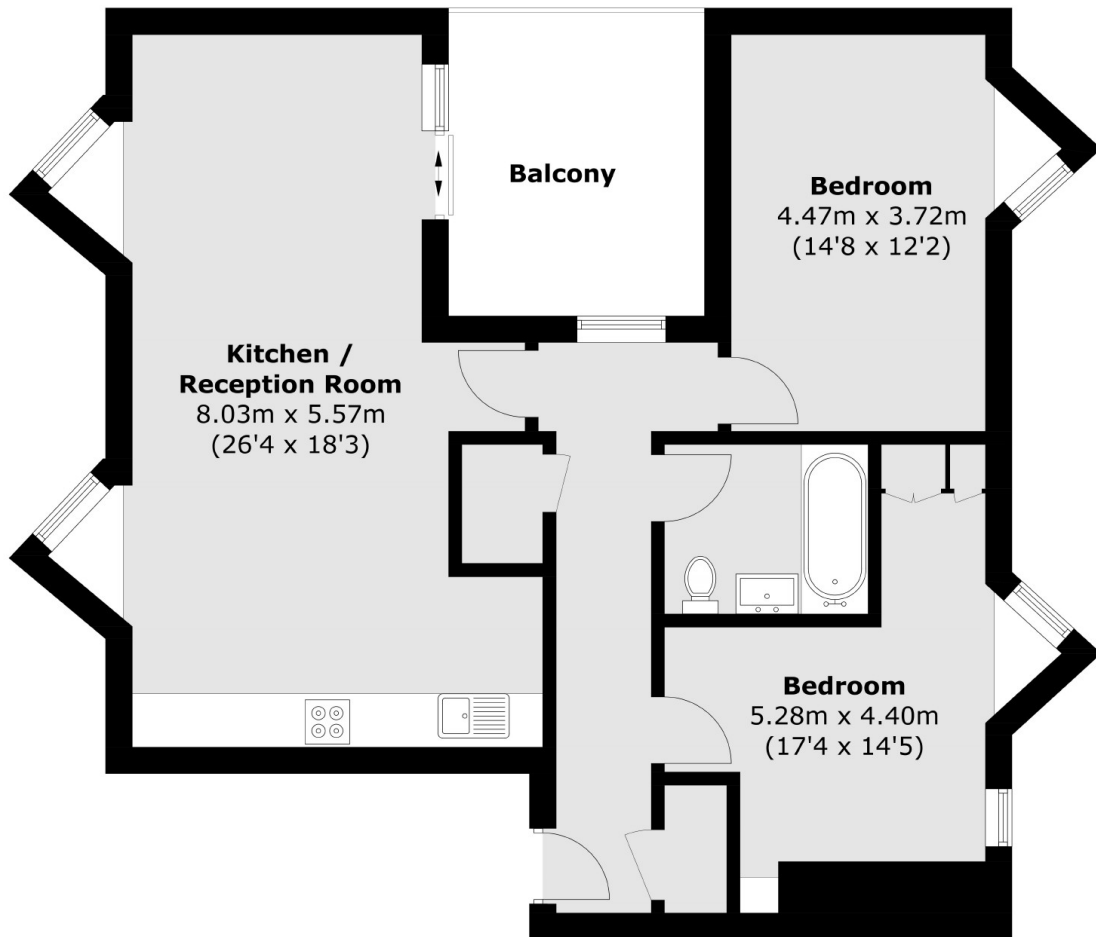

Total area (approx.): 77.3 sq. m (832.0 sq. ft)
Balcony (approx.): 9.8 sq. m (105.5 sq. ft)