



Clevedon House offers over £200,000

- NO CHAIN
- Three Double Bedrooms
- Parking Available
- Spacious Reception Room
- Council tax band E
- EPC Rating: C



 3  1  1



About the property

Presenting a neutrally decorated maisonette, listed for sale in a sought-after location. This property is ideally suited to first-time buyers, families and investors. It showcases a blend of comfort and convenience, with local amenities, public transport links, nearby schools, and green spaces all within easy reach.

The property boasts three double bedrooms offering ample space for rest and relaxation. The bedrooms are light-filled and well-presented, providing a tranquil retreat at the end of the day.

The heart of this home is undoubtedly its well-proportioned reception room. Large windows flood the space with natural light creating a warm and inviting atmosphere, making it a perfect setting for both relaxation and entertaining.

The property also features a kitchen. Whether you are an experienced cook or an enthusiast, this kitchen provides a delightful space to prepare your meals.

Serving your daily needs is a well-appointed bathroom, although further details are not specified, it certainly contributes to the overall functionality of the property.

This maisonette also comes with the added benefit of parking, eliminating any worries about finding a space when you get home.

In summary, this property combines a superb location with well-presented, neutrally decorated interiors, making it a compelling choice for those looking to step onto the property ladder or add to their investment portfolio.



Accommodation

Living Room/Diner

21' 4" x 11' 7" (6.50m x 3.53m)

Kitchen

8' 9" x 8' 6" (2.67m x 2.59m)

Utility Room

5' x 9' 5" (1.52m x 2.87m)

Bedroom One

9' 5" x 12' 9" (2.87m x 3.89m)

Bedroom Two

9' x 11' (2.74m x 3.35m)

Bedroom Three

8' x 12' 9" (2.44m x 3.89m)

Bathroom

5' 1" x 9' 6" (1.55m x 2.90m)

01633 221892

newport@peteralan.co.uk

Floorplan

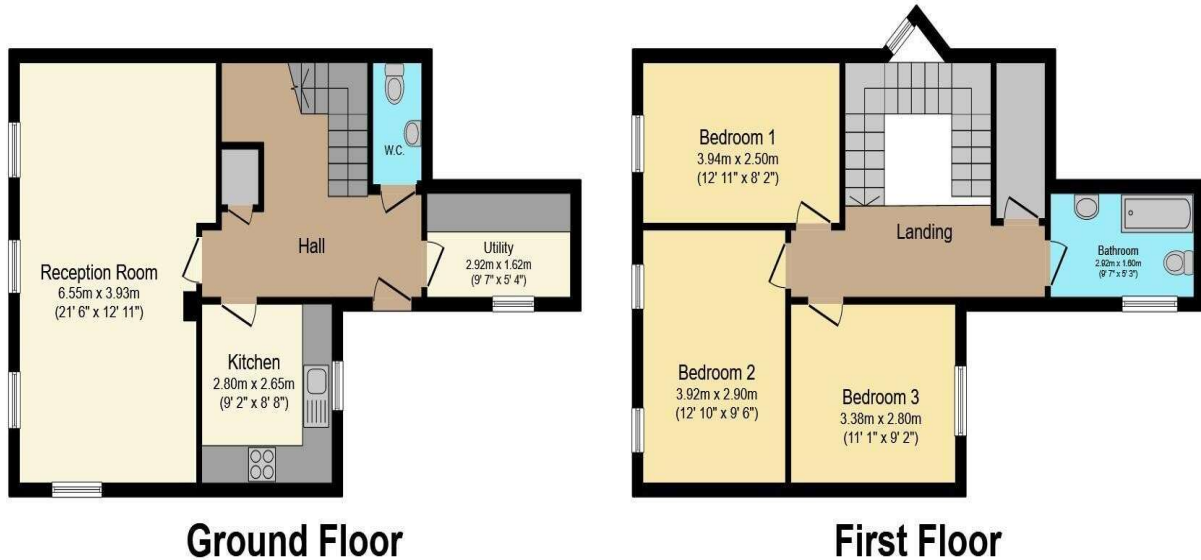

Total floor area 106.6 sq.m. (1,147 sq.ft.) approx

This floor plan is for illustrative purposes only. It is not drawn to scale. Any measurements, floor areas (including any total floor area), openings and orientation are approximate. No details are guaranteed, they cannot be relied upon for any purpose and they do not form part of any agreement. No liability is taken for any error, omission or misstatement. A party must rely upon its own inspection(s).

Powered by www.focalagent.com

Important Information

Note while we endeavour to make our sales details accurate and reliable, if there is any point which is of particular interest to you, please contact the office and we will be pleased to confirm the position for you. We have not personally tested any apparatus, equipment, fixtures, fittings or services and cannot verify they are in working order or fit for their purposes. Nothing in these particulars is intended to indicate that carpets or curtains, furnishings or fittings, electrical goods (whether wired or not). Gas fires or light fittings or any other fixtures not expressly included form part of the property offered for sale. This computer generated Floorplan, if applicable, is intended as a general guide to the layout and design of the property. It is not to scale and should not be relied upon for dimensions. Tenure: We cannot confirm the tenure of the property as we have not had access to the legal documents. The buyer is advised to obtain verification from their solicitor or surveyor.

Peter Alan Limited is registered in England and Wales under company number 2073153, Registered Office is Cumbria House, 16-20 Hockliffe Street, Leighton Buzzard, Bedfordshire, LU7 1GN. VAT Registration Number is 500 2481 05. For activities relating to regulated mortgages and non-investment insurance contracts, Peter Alan Limited is an appointed representative of Connells Limited which is authorised and regulated by the Financial Conduct Authority. Connells Limited's Financial Services Register number is 302221. Most buy-to-let

pa peter
alan