



📍 16 High Street, Potterne, Wiltshire, SN10 5PY

🏠 £285,000

A characterful and spacious 3-bedroom home situated in the heart of the popular village of Potterne.

- Characterful period home
- Semi-detached
- Spacious accommodation
- 3-bedrooms
- Heart of the village
- Off road parking
- Pretty rear garden
- New roof in 2025

🏡 Freehold

📊 EPC Rating F



Situated in the heart of the ever-popular village of Potterne, this characterful and deceptively spacious three-bedroom semi-detached home offers a blend of charm, practicality and village living.

The property enjoys a central position, right next door to the well-known George & Dragon public house, a historic fifteenth century inn that sits at the heart of the village community. Potterne itself is highly regarded, offering a strong sense of community along with a village shop, church, school and excellent access to Devizes and surrounding countryside.

Internally, the accommodation is well-balanced and full of character, with generous living space arranged across two floors. The ground floor offers a comfortable living room, leading through to a separate dining room, ideal for both everyday use and entertaining. To the rear, a spacious kitchen/dining room provides a sociable hub of the home with ample worktop, storage space and also houses the multi-fuel stove.

Upstairs, there are three well-proportioned bedrooms, all served by a family bathroom.

The property has also benefitted from a new roof within the last year, offering peace of mind for prospective purchasers.

Externally, there is off-street parking to the front, while the rear garden is a particularly attractive feature. Thoughtfully arranged, it offers a patio seating area along with raised sections planted with mature shrubs, creating a private and established feel. At the far end, a useful shed/workshop provides excellent additional storage or hobby space.

A charming village home with plenty of character, well-suited to those looking for space, convenience and a strong community setting.

#### **Situation**

The property is set in the heart of the village, with easy access to amenities and countryside walks. The charming village of Potterne has a thriving community and provides a pre-school, a lovely public house called The George and Dragon, church, an active village hall, plus a very useful newsagents/village shop/post office. A primary school is located in the neighbouring village of Worton just up the road. The historic market town of Devizes is approximately two miles to the North offering a more comprehensive range of shopping, transport and leisure facilities, a cinema, museum and thriving weekly market. The major centres of Bath, Chippenham, Salisbury, Swindon and Marlborough are all within a 25 mile radius.

#### **Property information**

Multi-fuel stove with back boiler providing central heating. We are advised mains water, drainage and electricity are connected.

Tenure: Freehold

EPC rating: F

Council tax band: D



# High Street, Potterne, Devizes, SN10

Approximate Area = 1193 sq ft / 110.8 sq m

Outbuilding = 133 sq ft / 12.3 sq m

Total = 1326 sq ft / 123.1 sq m

For identification only - Not to scale

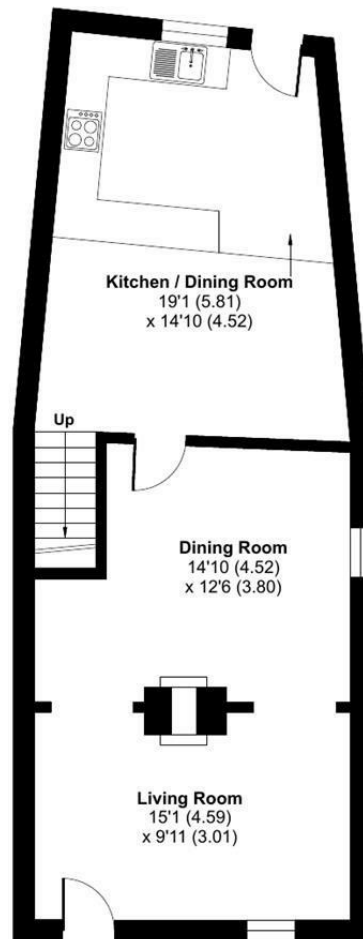

GROUND FLOOR

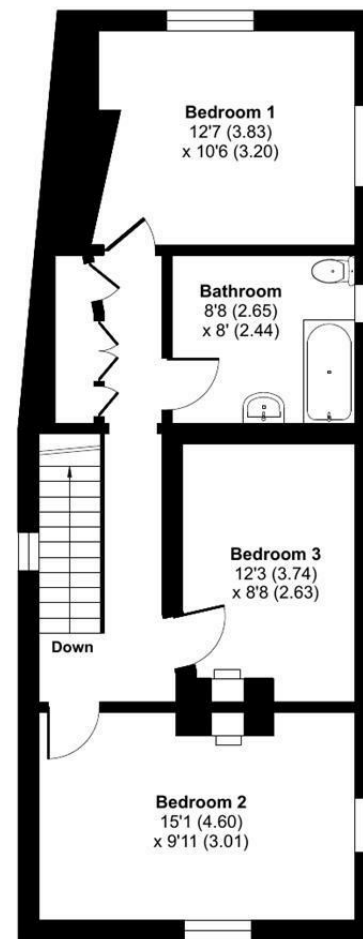

FIRST FLOOR

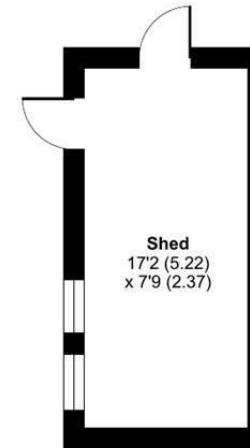

OUTBUILDING

 Floor plan produced in accordance with RICS Property Measurement 2nd Edition, Incorporating International Property Measurement Standards (IPMS2 Residential). © ntechcom 2026. Produced for Strakers. REF: 1452781

Disclaimer These particulars, whilst believed to be accurate are set out as a general outline only for guidance and do not constitute any part of an offer or contract. Intending purchasers should not rely on them as statements of representation of fact, but must satisfy themselves by inspection or otherwise as to their accuracy. No person in this firm's employment has the authority to make or give any representation or warranty in respect of the property. All measurements and distances are approximate only. Your home is at risk if you do not keep up repayments on a mortgage or other loan secured on it.