

9 Stewart Court

Epping

Council Tax band: D

Tenure: Leasehold

- Ground floor apartment
- Retirement Living
- Parking & communal gardens
- Double glazed and underfloor heating
- Communal reception area, laundry room and guest suite
- Short walk to Epping station and high street
- Shower Room



Hallway

Lounge/ Diner

Kitchen

6' 9" x 6' 2" (2.05m x 1.89m)

Bedroom

16' 1" x 9' 10" (4.90m x 3.00m)

Shower Room

6' 9" x 5' 4" (2.05m x 1.63m)





Ground Floor

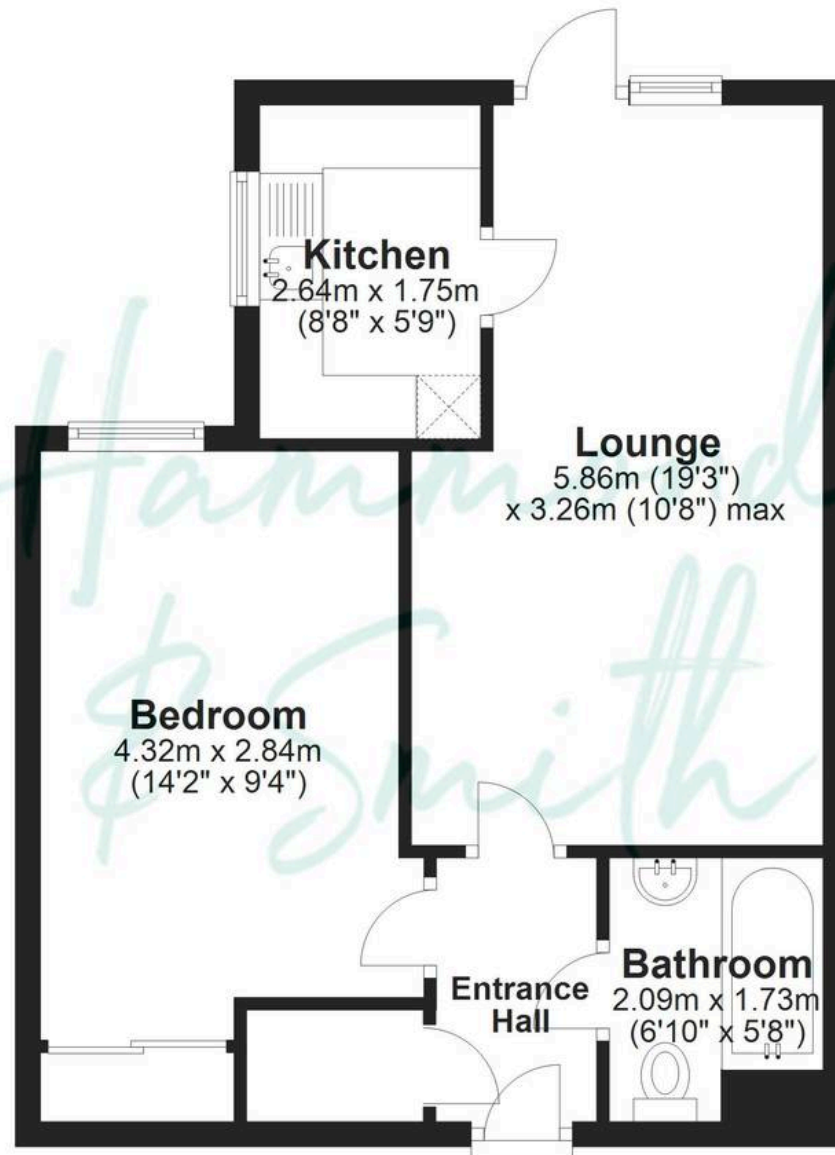

Total area: approx. 45.1 sq. metres (485.7 sq. feet)

Floorplans are provided for guidance only. They are not to scale & must not form any part of a legal contract or be reproduced

Plan produced using PlanUp.