



2 Westminster Close, Coton Hill, Shrewsbury, SY1 2DA

2 bedroom detached bungalow — £275,000 Leasehold

2 Westminster Close, Coton Hill, Shrewsbury, SY1 2DA

Coopergreenpooks.co.uk

£275,000 Leasehold — 2 bedroom detached bungalow

sales@cgpooks.co.uk

Conveniently situated within walking distance of the town centre, this individual detached bungalow offers very well-proportioned and thoughtfully designed accommodation, while benefitting from a lovely private garden, driveway parking, and large attached garage.

KEY FEATURES

- Good-sized entrance hall with useful walk-in store cupboard and cloakroom/WC
- Living room with feature fireplace, window to rear, and glazed doors opening to the conservatory which has double doors onto the garden
- Separate dining room, which is also open plan to the living area, creating a light and versatile space
- Fitted kitchen, complete with a range of units and space for appliances, very practical pantry, and rear hallway with access to the garden
- Impressive master bedroom with multiple built-in wardrobes and a well-appointed en-suite shower room
- The second bedroom is also a generous double, with integral access to the garage
- uPVC double glazed windows and gas fired central heating throughout
- Private rear garden, mostly paved for easy maintenance, with a variety of seating areas, planted borders, a selection of specimen plants and shrubs, and secure gate to side
- To the front of the property is a neatly kept lawn, block paved driveway providing plenty of parking, and the large attached garage
- A very popular and convenient location, just a short walk from the train station and town centre, as well as some lovely countryside and riverside walks
- The property is currently leasehold, with a 67 year lease and a modest service charge. However, we have been advised that the freehold could be purchased. As things stand, the management company, Barchester Healthcare, are responsible for the external maintenance and front garden, with additional benefits and services offered within the Westminster Close retirement facility if required
- Please note that to live in the bungalow residents must be over 55 years old
- Sold vacant with no upward chain

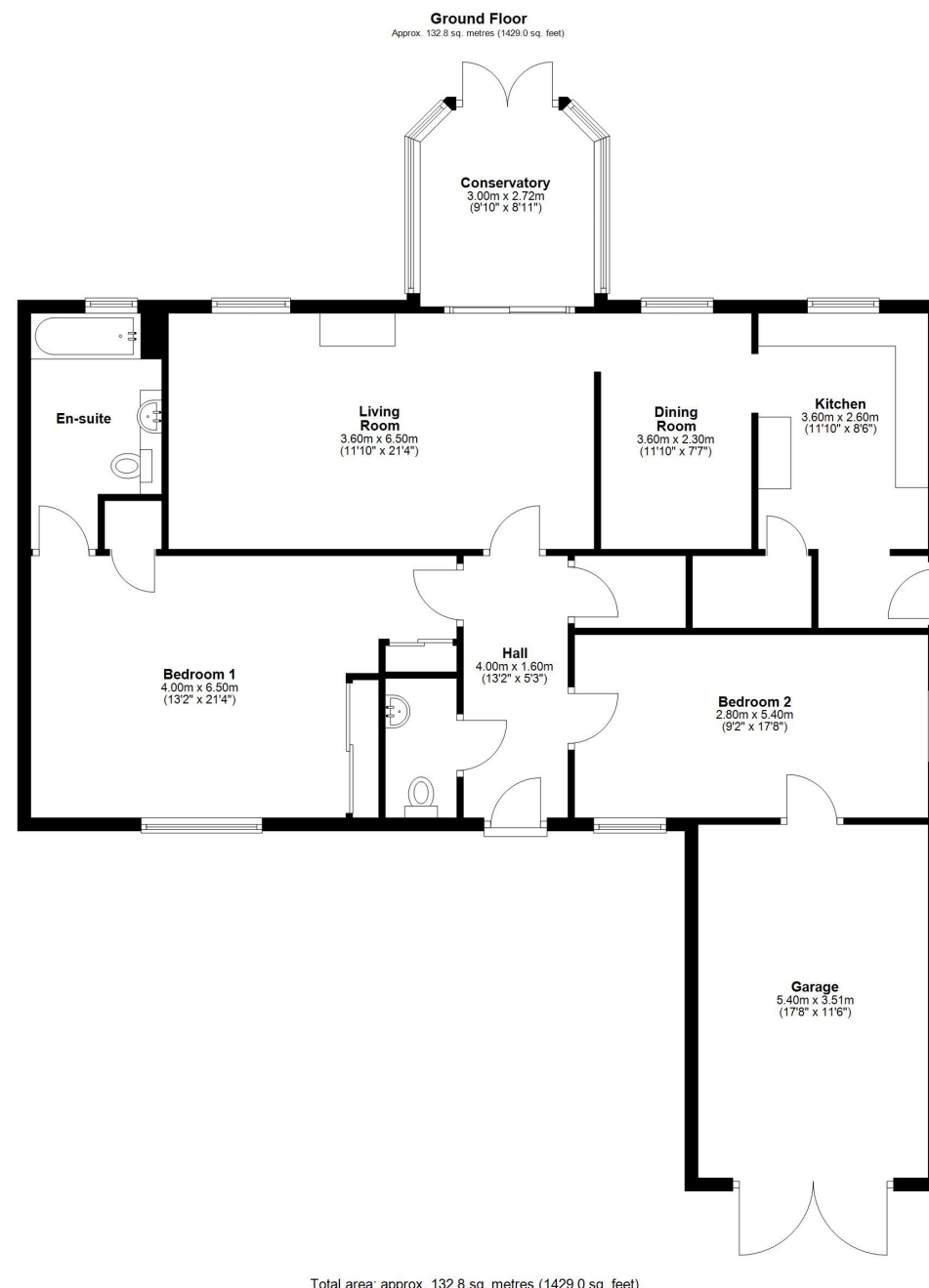

Total area: approx. 132.8 sq. metres (1429.0 sq. feet)











2 Westminster Close, Coton Hill, Shrewsbury, SY1 2DA

Coopergreenpooks.co.uk

£275,000 Leasehold — 2 bedroom detached bungalow

sales@cgpooks.co.uk

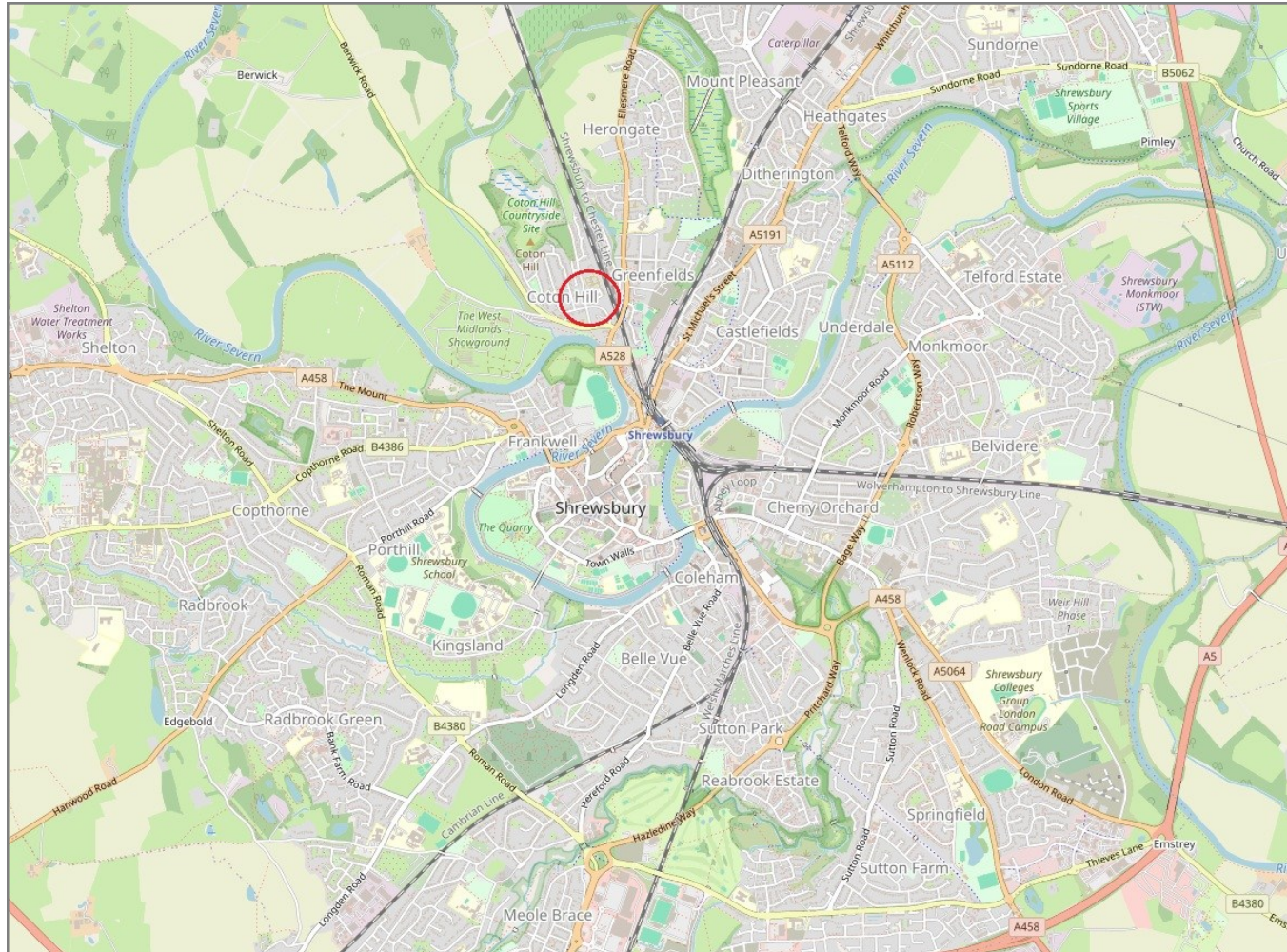

IMPORTANT NOTICE: Cooper Green Pooks for themselves and for the lessors or vendors of this property whose agents they are give notice that: 1 No appliances, services or service installations have been tested and no warranty as to suitability or serviceability is implied. Any prospective purchaser or lessee is advised to obtain verification from their surveyor or solicitor. 2. The particulars are set out as a general outline only for the guidance of the intended purchasers or lessees and do not constitute, nor constitute part of, an offer or contract. 3. All descriptions, reference to condition and necessary permissions for use and occupation and other details are given in good faith and are believed to be correct but any intending purchasers or lessees should not rely on them as statements or representation of fact but satisfy themselves by inspection or otherwise as to the correctness of each of them. 4. No person in the employment of Cooper Green Pooks has any authority to make or give any representation or warranty whatsoever in relation to this property. 5. All rentals and prices are quoted exclusive of Stamp Duty, legal and surveyors fees and any other associated purchasers or lessees costs. 6. Floor plans are indicative only and should not be relied on. 7. The plan showing the boundary of the property is indicative only and has not been checked against the legal title so should not be relied on. 8. All dimensions, floor areas and site areas are only approximate and should not be relied on. Dimensions are generally maximum room dimension.