

Hartmann Close, Cleobury Mortimer, Kidderminster, DY14 8DE

Guide Price £210,000

1 1 1



- Quote PC0649 Agent - Phil Cook
- Two Bedrooms
- Recently Refitted Windows and External Doors
- Quiet Cul de Sac Location
- Book a Viewing Now to Avoid Disappointment
- A Well Presented Semi-Detached Modern Property
- Open Plan Lounge and Breakfast Kitchen
- Convenient Village Location
- Driveway Parking
- Hit 'Request Details'/'Email Agent' to secure a viewing now!

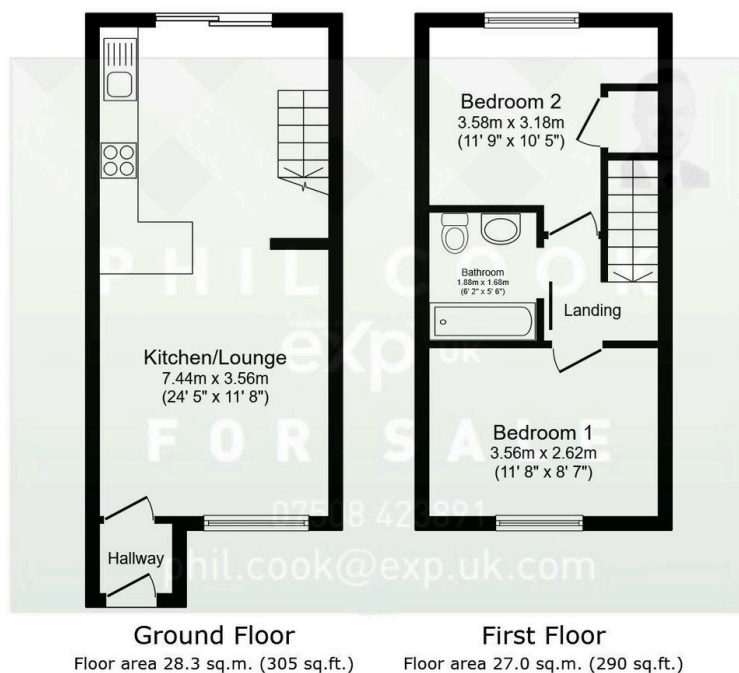

Total floor area: 55.3 sq.m. (595 sq.ft.)

This floor plan is for illustrative purposes only. It is not drawn to scale. Any measurements, floor areas (including any total floor area), openings and orientations are approximate. No details are guaranteed, they cannot be relied upon for any purpose and do not form any part of any agreement. No liability is taken for any error, omission or misstatement. A party must rely upon its own inspection(s). Powered by www.Propertybox.io

Quote PC0649 Phil Cook. Hit 'Request Details'/'Email Agent' to secure a viewing now! Well Presented modern two double bedroom semi-detached house with rear garden and recently re-fitted kitchen, and an open plan lounge, driveway parking to the side, perfect for first time buyers or downsizers. Located on a quiet residential road, close to local amenities in the sought after village of Cleobury Mortimer.

The property comprises of entrance hall, kitchen and lounge room, two double bedrooms and a

PHIL COOK



@ phil.cook@exp.uk.com

 philcook.exp.uk.com

 07508 423 891

house bathroom. To the rear of the property there is a private garden with gate to the driveway to the front. Newly fitted double glazing. Centrally heated with electric heating. Early viewing advised. Hit 'Request Details'/'Email Agent' to secure a viewing now!