



Creswick Road, W3

£425,000

A well presented two bedroom apartment on the top floor of a modern development near Springfield Gardens. The property also comes with off street parking available. The property also has the benefit of shared gardens and no charges or ground rents.

Creswick Road is located a short walk from the Elizabeth Line with quick commutes into central London. The amenities of Churchfield Road are nearby as well. The property is sold chain free.

Features

- No onward chain
- Two bedrooms
- Off street parking
- Communal Gardens
- Tree lined road.
- Close to Acton stations

Creswick Road, London, W3

Second Floor

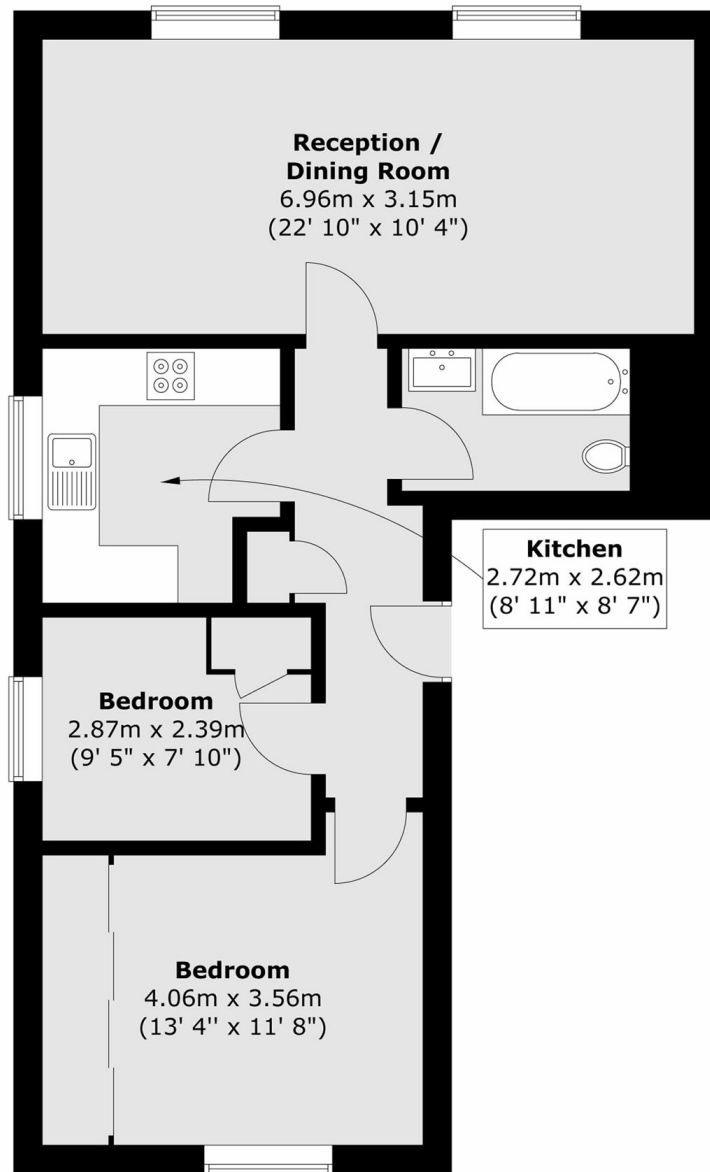

Total area (approx.) : 62.2 sq. m (669 sq. ft)