



## ESTATE AGENT



### Gladwell Road

Bromley, BR1 4DA

Guide price £375,000

\*\*\* Guide Price £375,000 - £390,000 \*\*\*

CHAIN FREE. Situated on a popular residential street in Plaistow is this two-bedroom Edwardian mid-terrace house.

The ground floor accommodation comprises an entrance hall with useful storage space, a separate kitchen, and a bright reception room with direct access to the private rear garden. Upstairs, the property offers two bedrooms and a recently updated three-piece bathroom.

Additional benefits include gas central heating via combi-boiler, attic space, and valid electrical and gas certificates.

Gladwell Road is a sought-after residential street in Bromley, BR1, ideally located for both Sundridge Park and Grove Park stations, providing excellent transport links into Central London. The property is also within easy reach of Sundridge Village and Bromley Town Centre, offering a wide range of shops, restaurants, bars, and leisure facilities.

Families will appreciate the proximity to several highly regarded local schools, including Parish Church of England Primary School, St Joseph's Catholic Primary School, and Burnt Ash Primary School. Green open spaces, including King's Meadow Playing Fields, are also just a short walk away.

- Chain Free
- Edwardian Mid-Terrace
- Upstairs Modern Bathroom
- Quiet Residential Street
- Ample Free Parking
- Valid Gas and Electrical Certificates
- Close to Sundridge Village
- Close to Transport Links

### Viewing

Please contact our Bromley Office on 020 3633 8620 if you wish to arrange a viewing appointment for this property or require further information.



## Floor Plan

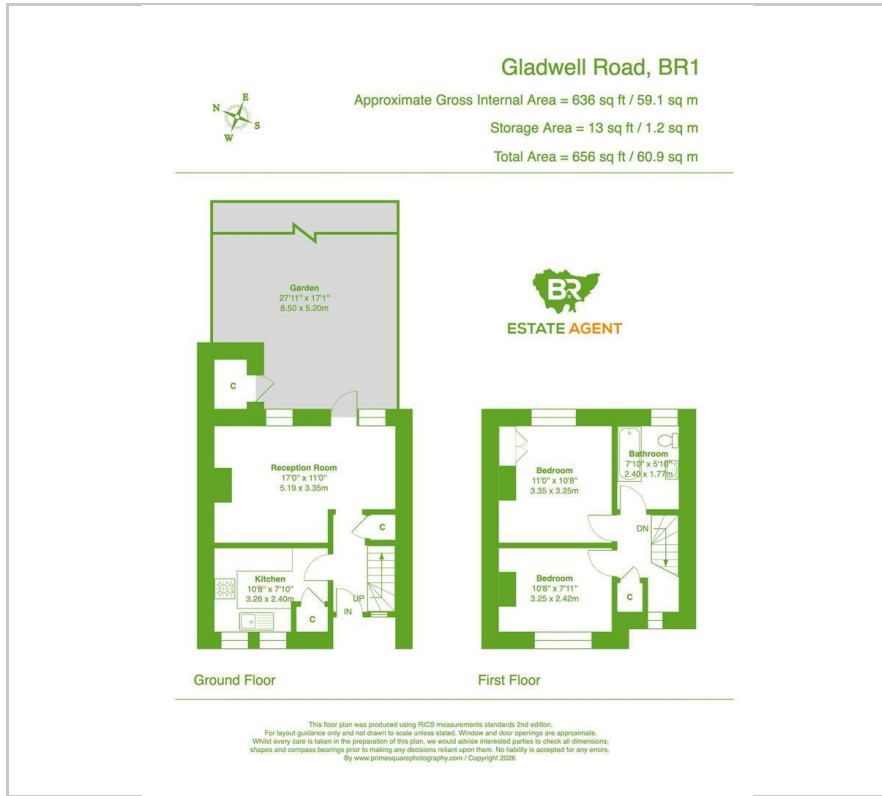

## Area Map



## Energy Efficiency Graph

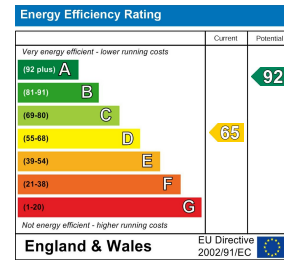

These particulars, whilst believed to be accurate are set out as a general outline only for guidance and do not constitute any part of an offer or contract. Intending purchasers should not rely on them as statements of representation of fact, but must satisfy themselves by inspection or otherwise as to their accuracy. No person in this firm's employment has the authority to make or give any representation or warranty in respect of the property.