



CROFTS ESTATE AGENTS

PASSIONATE ABOUT PROPERTY

CLEETHORPES
01472 200666

IMMINGHAM
01469 564294

LOUTH
01507 601550

SALES LETTINGS NEW HOME SALES LAND PROPERTY MANAGEMENT AUCTIONS FINANCIAL ADVICE AND MORTGAGES ENERGY PERFORMANCE PROVIDER



Links Drive

Humberston
DN36 4ZG

Offers in the Region Of £183,950

CLEETHORPES: 62 St Peters Avenue, Cleethorpes, DN35 8HP

IMMINGHAM: 21 Kennedy Way, Immingham, DN40 2AB

LOUTH: 3 Market Place, Louth, LN11 9NR

Email: Cleethorpes:

Email: Immingham :

Email: Louth :

info@croftsestateagents.co.uk

immingham@croftsestateagents.co.uk

louth@croftsestateagents.co.uk

www.croftsestateagents.co.uk



Property Introduction

Located on Links Drive in Humberston, this beautifully presented three-bedroom semi-detached home, constructed in 2020, offers stylish and comfortable living throughout. The property enjoys excellent kerb appeal with a smart frontage and two private parking spaces. The ground floor features a welcoming entrance hall, a spacious lounge, and an impressive open-plan kitchen diner – perfect for family living and entertaining. The kitchen is fitted with modern units and integrated appliances, with French doors opening out to the rear garden. A convenient ground-floor WC completes the layout. Upstairs, there are three well-proportioned bedrooms, including a master with an en-suite shower room, plus a contemporary family bathroom. Each room is tastefully decorated and well maintained, making the home ready to move straight into. Outside, the rear garden offers a fantastic outdoor space, featuring both a decked area and a paved patio – ideal for relaxing or hosting summer gatherings. Situated in a popular and well-connected location within easy reach of local schools, shops, and transport links, this modern family home combines practicality with modern comfort and style – an ideal choice for first-time buyers, families, or those seeking a well-kept property in a sought-after area.

Entrance

Entering the property reveals a radiator and vinyl flooring.

WC

The WC has an opaque window to the front elevation, a radiator, vinyl flooring, a WC and a basin.

Lounge

14' 3" x 12' 1" (4.35m x 3.68m)

The lounge has a window to the front elevation, a radiator and a carpeted floor. There is also access to the under stairs cupboard.

Kitchen/Diner

8' 9" x 15' 4" (2.67m x 4.67m)

The kitchen-diner has a window and French doors to the rear elevation, a radiator and vinyl flooring. There is also a modern fitted kitchen with a one and a half sink and drainer and plumbing for both a washing machine and dish washer. There is also an electric oven and gas hob with an extractor over and space for a dining table and chairs.

First Floor Landing

The first floor landing has access to the loft, a built in cupboard and a carpeted floor.

Bedroom One

9' 5" x 9' 9" (2.87m x 2.97m)

Bedroom one has a window to the front elevation, a radiator and a carpeted floor.

En-suite

5' 10" x 5' 4" (1.77m x 1.62m)

The en-suite has an opaque window to the front elevation, a radiator and vinyl flooring. There is also a white suite with a WC, basin and a shower cubicle with a mains shower.

Bedroom Two

7' 7" x 9' 1" (2.32m x 2.77m)

Bedroom two has a window to the rear elevation, a radiator and a carpeted floor.

Bedroom Three

7' 7" x 5' 11" (2.32m x 1.81m)

Bedroom three has a window to the rear elevation, a radiator and a carpeted floor.

Bathroom

5' 11" x 5' 7" (1.81m x 1.69m)

The bathroom has an opaque window to the side elevation, a radiator and vinyl flooring. There is also a white suite with a WC, basin and a bath.

Outside

To the front there are two parking spaces and then a gate to the side reveals access to the rear garden. The rear garden is enclosed by perimeter fencing with a lawn and both a decked and patio area which are both ideal for alfresco dining.

Tenure

Believed to be Freehold, awaiting solicitors' formal confirmation. All interested parties are advised to make their own enquiries.

Services

All mains services are understood to be connected, however Crofts have not inspected or tested any of the services or service installations & purchasers should rely on their own survey.

Broadband and Telecom Communications

Broadband and mobile speeds and availability can be assessed via the Ofcoms checker website.

<https://www.ofcom.org.uk/phones-and-broadband/coverage-and-speeds/ofcom-checker>

Viewings

Please contact the relevant marketing office, all viewings are strictly by appointment only please.

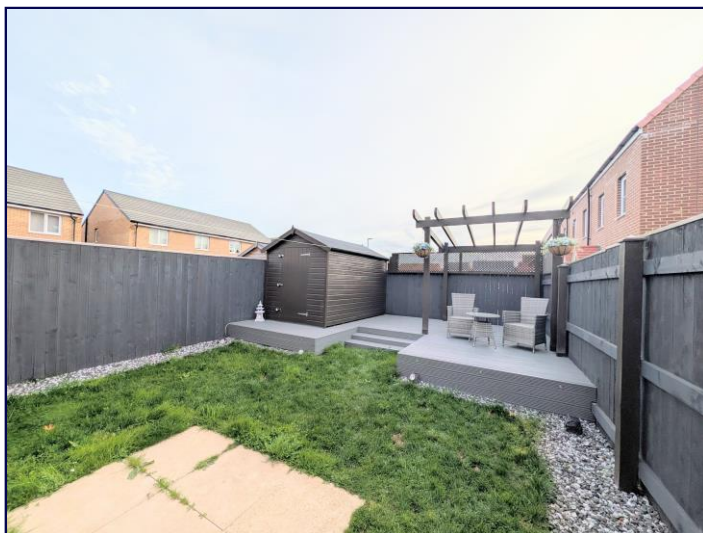

GROUND FLOOR
33.0 sq.m. (355 sq.ft.) approx.

1ST FLOOR
33.0 sq.m. (355 sq.ft.) approx.

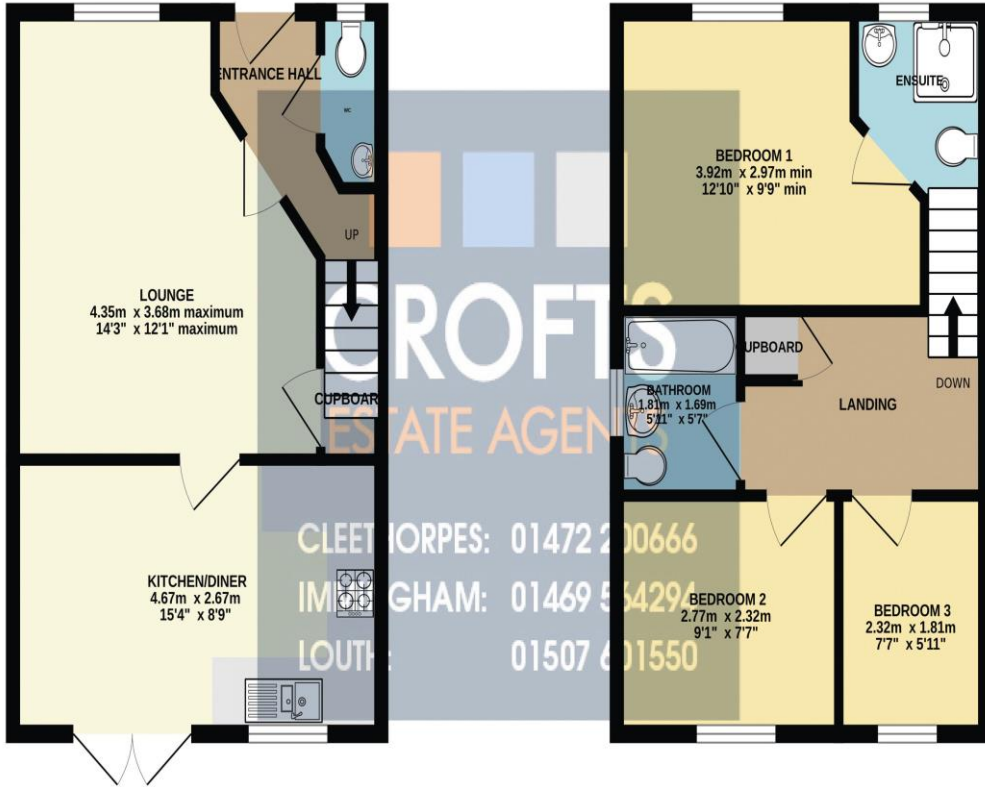

TOTAL FLOOR AREA: 65.9 sq.m. (709 sq.ft.) approx.

Whilst every attempt has been made to ensure the accuracy of the floorplan contained here, measurements of doors, windows, rooms and any other items are approximate and no responsibility is taken for any error, omission or mis-statement. This plan is for illustrative purposes only and should be used as such by any prospective purchaser. The services, systems and appliances shown have not been tested and no guarantee as to their operability or efficiency can be given.
Made with Metropix ©2025

Score	Energy rating	Current	Potential
92+	A		96 A
81-91	B	83 B	
69-80	C		
55-68	D		
39-54	E		
21-38	F		
1-20	G		

DISCLAIMER - IMPORTANT NOTICE REGARDING SALES PARTICULARS Although we have taken great care to insure the accuracy of the information contained in these particulars, we specifically deny liability for any mistakes, omissions or errors and strongly advise that all proposed purchasers should satisfy themselves by inspection or otherwise, as to their correctness, prior to entering into any commitment to purchase. In particular any information provided in respect of tenure, council tax, rateable values etc has been given in good faith and whilst believed to be correct, may be subject to amendment. Any references to the condition, use or appearance of the property are made for guidance only, and no warranties are given or implied by this information. It is not Crofts policy to check the position with regards to any planning permission or building regulation matters and as such all interested parties are advised to make their own enquires, in order to ensure that any necessary consents have been obtained. All measurements are approximate and are for guidance only and cannot be relied upon. Measurements are taken from wall to wall unless otherwise stated, with the metric conversion shown in brackets. Any plans or maps contained are for identification purpose only, and are not for any other use but guidance & illustration. Crofts have not tested any apparatus, equipment, fixtures, fittings or services including central heating systems and cannot therefore verify that they are in working order, or fit for their intended purpose. These details do not form any part of any contract, and unless specifically stated otherwise, furnishings and contents are not included within this sale.