



Old Church Road, Harborne Birmingham B17 0BB

welcome to

Old Church Road, Harborne Birmingham

****FANTASTIC HARBORNE LOCATION **CLOSE TO HARBORNE VILLAGE ** IN NEED OF SOME IMPROVEMENT ** WOULD MAKE A WONDERFUL BUY TO LET INVESTMENT OR FIRST HOME ** CLOSE TO QUEEN ELIZABETH HOSPITAL ** BIRMINGHAM UNIVERSITY ** PUBLIC TRANSPORT FACILITIES INTO BIRMINGHAM CITY ** CASH BUYERS ONLY ****

Agent Note

This property is council tax band D.
This property is a Grade11 listed building.

Lounge

15' 4" x 10' 2" (4.67m x 3.10m)
Entrance from front door into living room, Single glazed window, central heating radiator. Small walk through with Utility room one side and Cloakroom on the other side.

Cloakroom

2' 9" x 2' 2" (0.84m x 0.66m)
Coat hooks on the wall.

Utility Room

4' x 2' 9" (1.22m x 0.84m)
Plumbing for utilities.

Kitchen

15' 4" x 10' (4.67m x 3.05m)
Accessed via living room. Single glazed window, range of wall & base units with worktops over, integrated oven & hob with extractor over, washing machine, fridge freezer, sink & drainer, tiles to splash-prone areas, access to rear garden. Stairs to first floor.

Bedroom 1

14' 2" x 10' 2" (4.32m x 3.10m)
Single glazed window, central heating radiator.

Bedroom 2

10' 2" x 9' 5" (3.10m x 2.87m)
Single glazed window, central heating radiator.

Bathroom

10' 1" x 8' 1" (3.07m x 2.46m)
Single glazed frosted window, bath with shower over & glass screen, full height tiling around bath, wash hand basin, low level flush w/c.

Rear Garden

Fully bock paved - needs some maintenance. Fenced on side, fully enclosed, small storage cupboard.





view this property online shipways.co.uk/Property/HBN111976



welcome to

Old Church Road, Harborne Birmingham

- Semi detached Property Grade 11 listed building.
- Cottage Style
- Two Bedrooms
- Lounge
- Dining Kitchen

Tenure: Freehold EPC Rating: D
Council Tax Band: D

from
£210,000

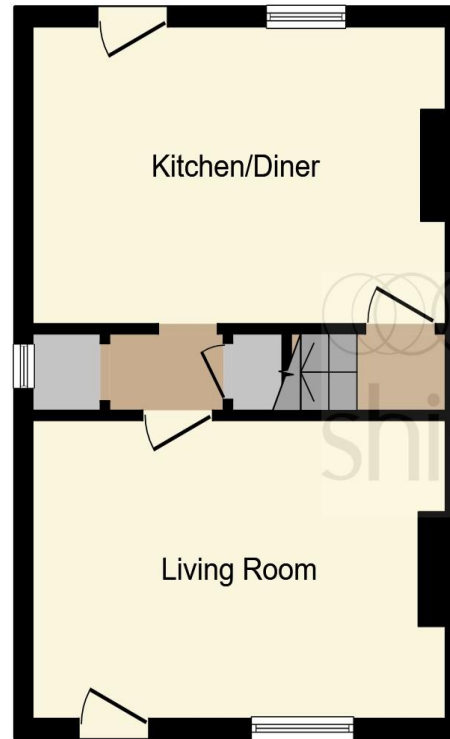

Ground Floor

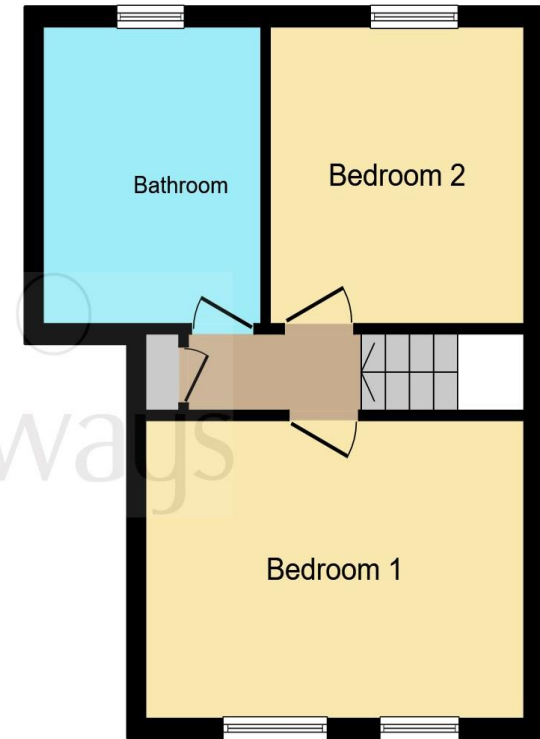

First Floor

This floor plan is for illustrative purposes only. It is not drawn to scale. Any measurements, floor areas (including any total floor area), openings and orientation are approximate. No details are guaranteed, they cannot be relied upon for any purpose and they do not form part of any agreement. No liability is taken for any error, omission or misstatement. A party must rely upon its own inspection(s). Powered by www.focalagent.com

view this property online shipways.co.uk/Property/HBN111976



Property Ref:
HBN111976 - 0026

1. MONEY LAUNDERING REGULATIONS Intending purchasers will be asked to produce identification documentation at a later stage and we would ask for your co-operation in order that there is no delay in agreeing the sale. 2. These particulars do not constitute part or all of an offer or contract. 3. The measurements indicated are supplied for guidance only and as such must be considered incorrect. Potential buyers are advised to recheck measurements before committing to any expense. 4. We have not tested any apparatus, equipment, fixtures or services and it is in the buyers interest to check the working condition of any appliances. 5. Where an EPC, or a Home Report (Scotland only) is held for this property, it is available for inspection at the branch by appointment. If you require a printed version of a Home Report, you will need to pay a reasonable production charge reflecting printing and other costs. 6. We are not able to offer an opinion either written or verbal on the content of these reports and this must be obtained from your legal representative. 7. Whilst we take care in preparing these reports, a buyer should ensure that his/her legal representative confirms as soon as possible all matters relating to title including the extent and boundaries of the property and other important matters before exchange of contracts.

Shipways is a trading name of Sequence (UK) Limited which is registered in England and Wales under company number 4268443, Registered Office is Cumbria House, 16-20 Hockliffe Street, Leighton Buzzard, Bedfordshire, LU7 1GN. VAT Registration Number is 500 2481 05.



0121 427 3264



harborne@shipways.co.uk



172 High Street, Harborne, BIRMINGHAM,
West Midlands, B17 9PP



shipways.co.uk