

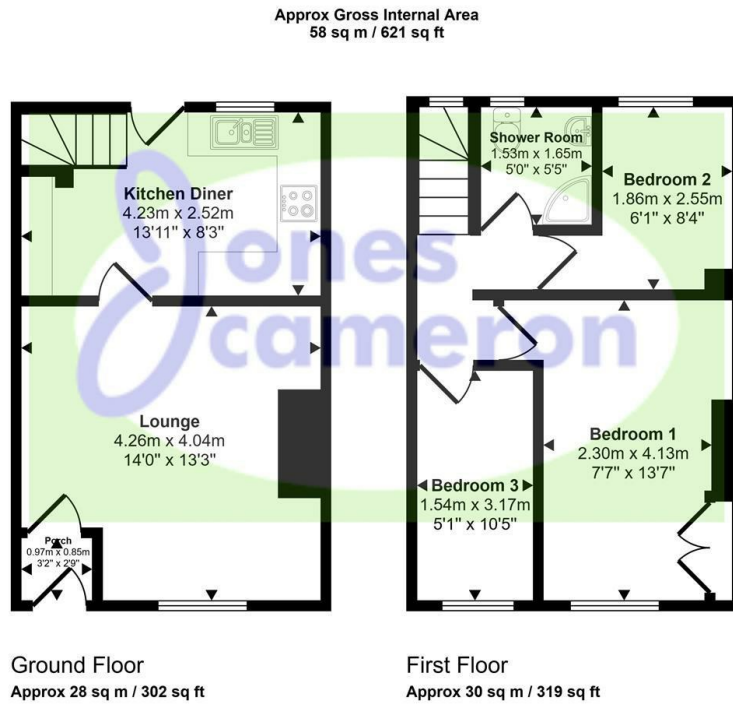

22 Old Lancaster Lane, Preston, PR1 7JU

Asking Price £120,000

- On Street Parking
- Recently Fitted Kitchen
- Gas Central Heating
- Double Glazed Throughout
- Idea First-Time Buy/Ideal Investment
- Three Bedrooms



This floorplan is only for illustrative purposes and is not to scale. Measurements of rooms, doors, windows, and any items are approximate and no responsibility is taken for any error, omission or mis-statement. Icons of items such as bathroom suites are representations only and may not look like the real items. Made with Made Snappy 360.

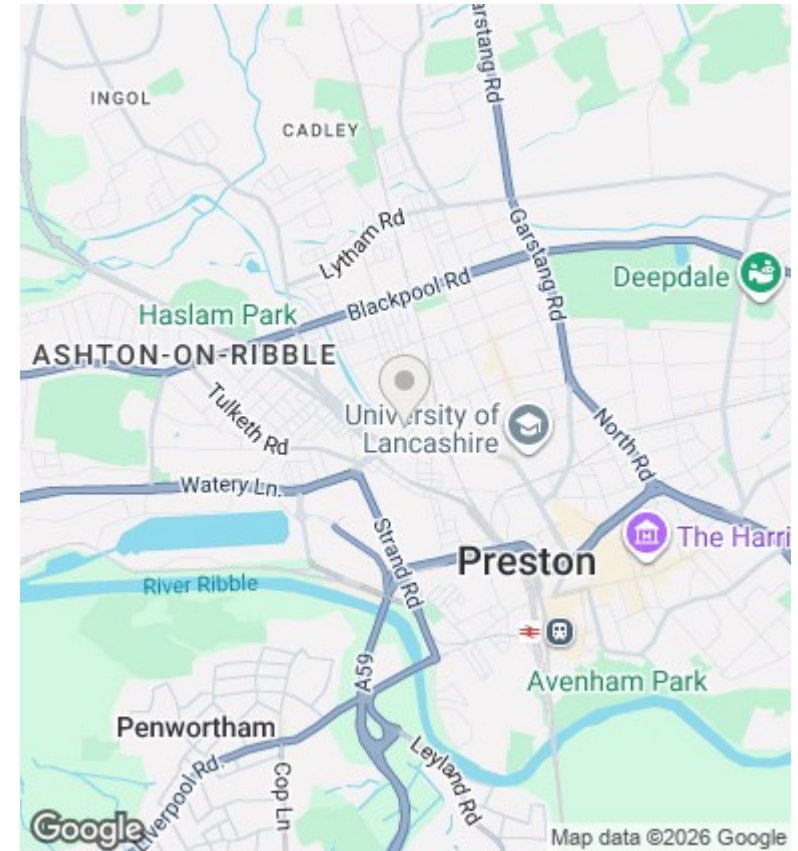

Directions

may take pets - higher deposit

Viewings

Viewings by arrangement only. Call 01772 888887 to make an appointment.

Council Tax Band

A

EPC Rating:

D

Energy Efficiency Rating		
	Current	Potential
<i>Very energy efficient - lower running costs</i>		
(92 plus) A		
(81-91) B		
(69-80) C		73
(55-68) D	55	
(39-54) E		
(21-38) F		
(1-20) G		
<i>Not energy efficient - higher running costs</i>		
England & Wales	EU Directive 2002/91/EC	