



Olton Road, Shirley, B90 3NW

Marketed by Tom Cooper powered by eXp





3



1



1



D

This semi detached home is unlike anything else on the market, blending character, creativity and personality throughout with a truly eclectic vintage inspired design that gives the property a warmth and atmosphere rarely found in modern homes. Every room has been thoughtfully styled, creating a home that feels both cosy and unforgettable from the moment you step inside.

To the front of the property there is driveway parking for two cars, while the entrance door opens into a welcoming hallway featuring timber constructed wall panelling and a useful space beneath the stairs for coats, shoes and everyday storage.

Positioned to the rear of the property is the stunning main lounge, a room filled with charm and character. Sliding doors frame views into the beautiful garden and allow natural light to pour into the space, while the feature hearth with electric log burner creates a cosy focal point perfect for evenings in.

To the front of the property sits the kitchen breakfast room, a wonderfully homely space with vintage inspired styling and timber panelling designed to complement the kitchen cupboards. There is space for a cooker, washing machine and fridge freezer, while the overall feel of the room makes it somewhere you genuinely want to spend time, whether that be morning coffee, family meals or entertaining friends. Just off the kitchen is access to the side passage along with a convenient downstairs toilet.

Upstairs, the property offers three bedrooms, including two spacious doubles, one of which benefits from built in wardrobe space. The third bedroom is a good size single room currently arranged as a home office, showing the versatility of the accommodation. The bathroom is fitted with a bath and shower over, along with a toilet and sink integrated neatly into a vanity unit.

To the rear of the property is a large and magical garden space that feels hidden away from the outside world. A patio seating area leads onto a lawn section surrounded by mature shrubs and trees, creating a peaceful and private environment with colour and greenery throughout the seasons.

However, it is the incredible outdoor spaces that truly make this property stand out.

The timber constructed garden office provides an ideal work from home setup or creative studio, while also benefiting from additional workshop and storage space, perfect for hobbies or practical use.

Beyond this sits the showpiece of the property, an extraordinary home pub that has been lovingly created and styled with remarkable attention to detail. Constructed from timber and designed to feel like an authentic vintage bar, this is far more than a simple garden room. Inside, the space is full of character with exposed timber beams, atmospheric lighting, stained glass style windows, quirky vintage signage, feature décor and multiple cosy seating areas designed for entertaining guests late into the evening. The handcrafted bar area creates a true pub atmosphere, while the separate lounge style sections give the space warmth and personality rarely seen in a residential setting. From relaxed family gatherings to full evenings hosting friends, this unique entertaining space offers an experience that feels more like stepping into a hidden countryside tavern than a garden outbuilding.

This is a home that must be viewed to fully appreciate the creativity, atmosphere and lifestyle it offers, combining practical family accommodation with one of the most unique garden entertainment spaces you are likely to find.

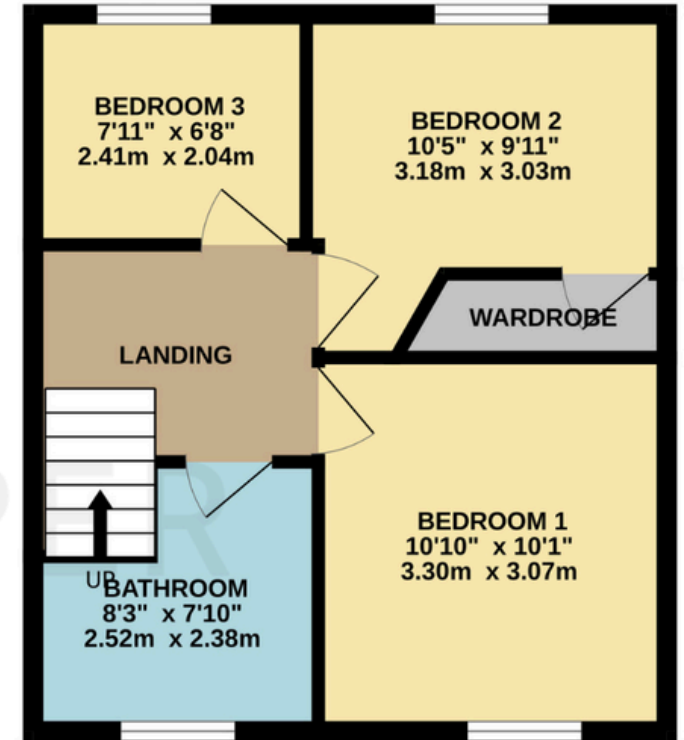
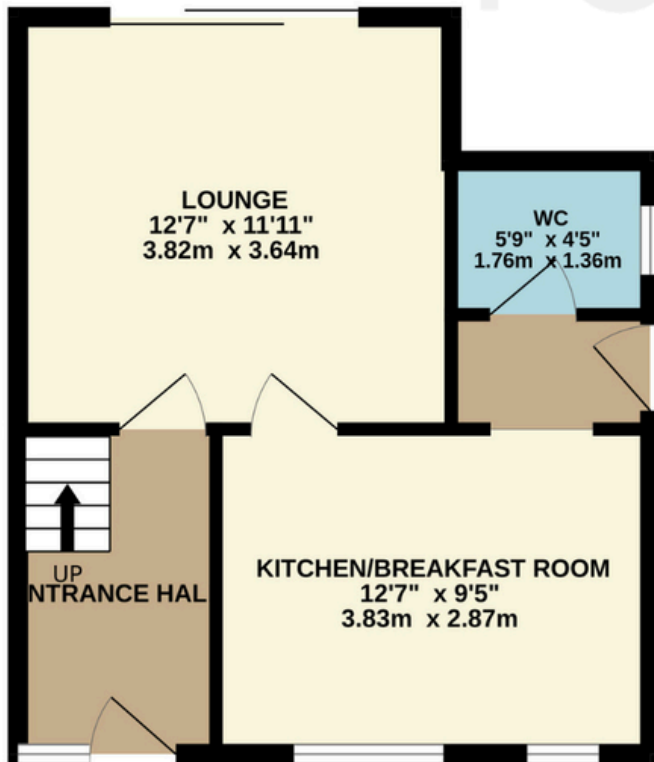
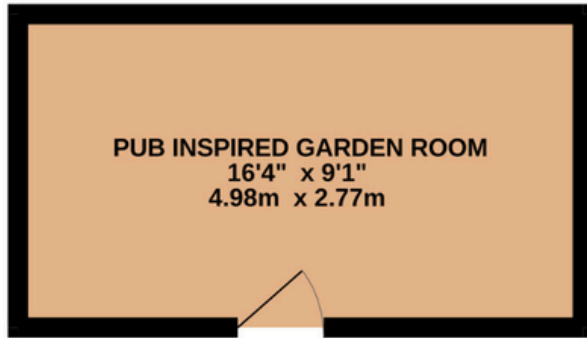







Why sell with Tom?

As an experienced estate agent covering Solihull, Birmingham, and Warwickshire, I take pride in delivering a fresh and innovative approach to buying and selling properties. With **over 10 years of experience**, I've built a bespoke agency that prioritizes a personal and modern service designed to make your property journey seamless and **stress-free**. Communication is key, which is why I offer a direct line for my clients to call, text, or WhatsApp me anytime with a guaranteed response. My services are available **seven days a week**, including evenings, ensuring you can reach me at a time that suits you. I operate on a **no sale, no fee** basis with no upfront commission or lengthy tie-in periods, giving you peace of mind and flexibility. I offer **professional photography**, detailed floor plans, and engaging video tours, all tailored to showcase your home at its best. Unlike traditional agencies, I don't believe in tying clients into long contracts. Instead, I focus on delivering results and providing a service that speaks for itself. Let me show you how selling your home should be done.

Get in touch to experience a modern, **hassle-free** way of moving.

TOM COOPER
exp[®]

