



51, Cartwright Way
Evesham
WR11 2RS

£230,000



CHRISTIAN
LEWIS
— PROPERTY —



51 Cartwright Way, Evesham, WR11 2RS

£230,000

An excellent opportunity to acquire this attractive semi-detached home. The ground floor accommodation comprises an entrance hall, kitchen, WC and a spacious lounge, while the first floor offers two well-proportioned bedrooms and a family bathroom.

Externally, the property benefits from a generous enclosed rear garden with gated side access, along with driveway parking.

Located within a sought-after modern residential development, the property enjoys convenient road links into the heart of Evesham, where a wide range of retail outlets, restaurants and leisure facilities can be found.

With its well-balanced living space, generous garden and desirable location, this property is expected to attract strong interest. Early viewing is highly recommended—contact us today to arrange your appointment.

Additional Information

Tenure: We understand that the property for sale is Freehold

Local Authority: Wychavon District Council

Council Tax Band: We understand that the Council Tax Band for the property is Band B

EPC Rating: B

Estate charges apply

Disclaimer

Whilst we make enquiries with the Seller to ensure the information provided is accurate, Christian Lewis makes no representations or warranties of any kind with respect to the statements contained in the particulars which should not be relied upon as representations of fact. All representations contained in the particulars are based on details supplied by the Seller. Your Conveyancer is legally responsible for ensuring any purchase agreement fully protects your position. Please inform us if you become aware of any information being inaccurate.



Floor Plans

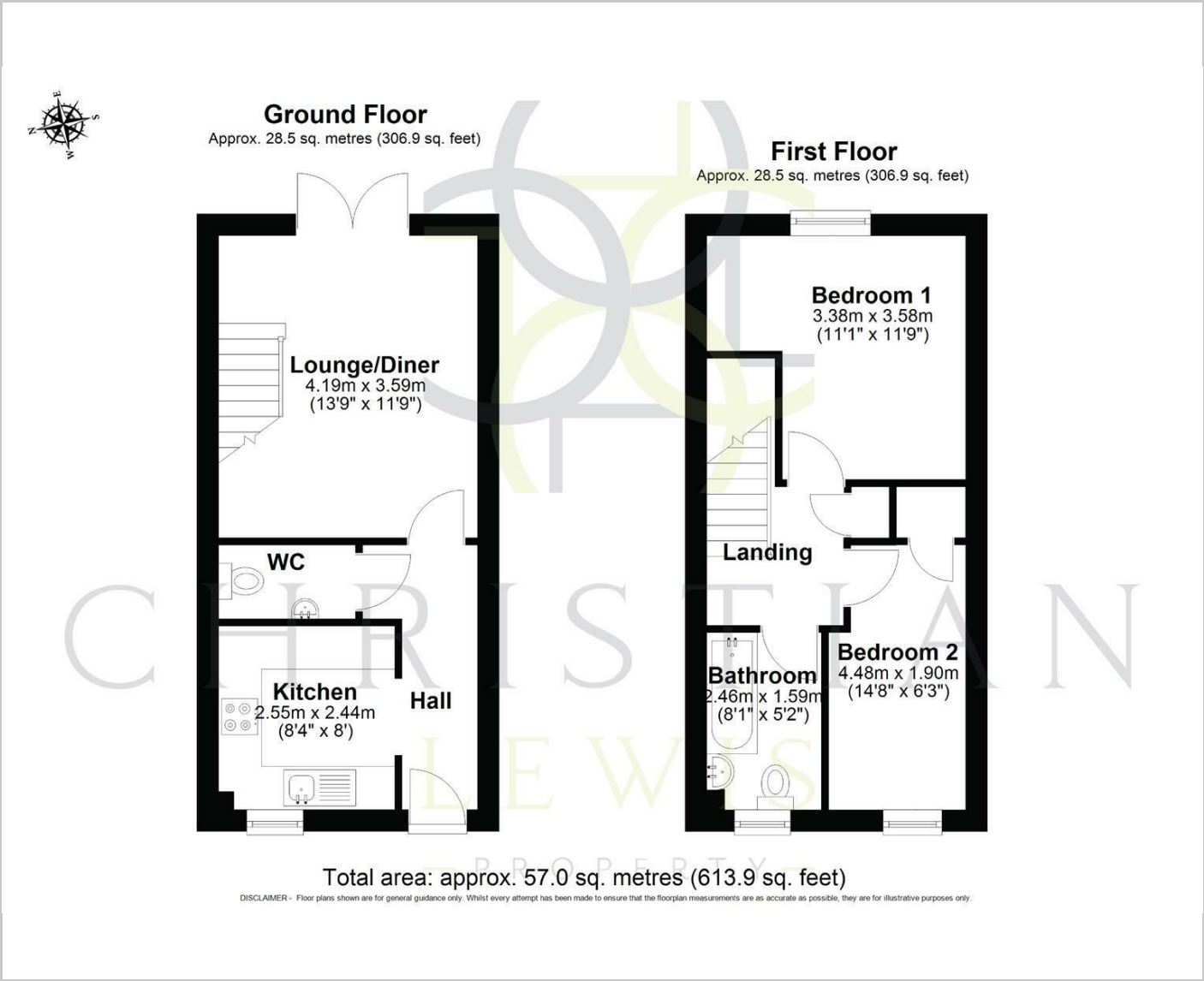

Area Map

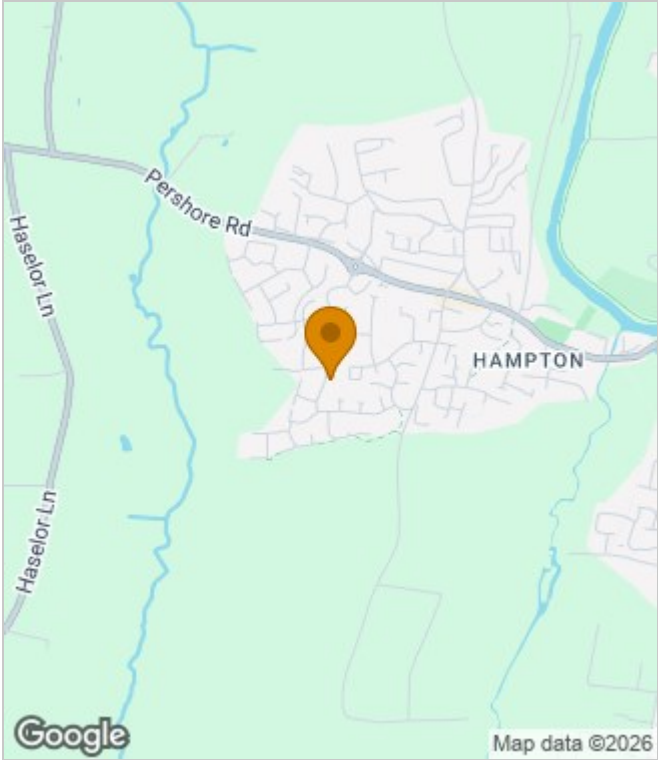

Energy Performance Graph

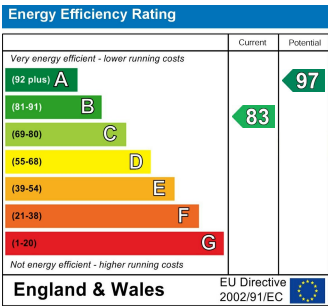

These particulars, whilst believed to be accurate are set out as a general outline only for guidance and do not constitute any part of an offer or contract. Intending purchasers should not rely on them as statements of representation of fact, but must satisfy themselves by inspection or otherwise as to their accuracy. No person in this firms employment has the authority to make or give any representation or warranty in respect of the property.