



# St. Davids Square

London, E14

Asking Price £475,000

An exceptional riverside residence in the highly sought-after St. Davids Square development, perfectly positioned along the River Thames in the Isle of Dogs.

**CHESTERTONS**



# St. Davids Square

## London, E14

- 2 bedrooms | 1 bathroom
- Top Floor (3rd) Apartment
- 622sq ft Internal Space
- Private Balcony and Roof Terrace



An exceptional riverside residence in the highly sought-after St. Davids Square development, perfectly positioned along the River Thames in the Isle of Dogs. This stylish apartment offers a superb blend of modern comfort, thoughtful design and views over the water, ideal for professionals, couples or investors seeking an outstanding London home. Step inside to discover a bright, open-plan living area featuring elegant wooden flooring throughout the main living space, creating a warm and inviting atmosphere for everyday life and entertaining. The contemporary kitchen is finished to a high standard with sleek integrated appliances that seamlessly complement the clean lines and modern aesthetic.

The sleeping quarters are designed for comfort and relaxation, with soft carpet underfoot in the bedrooms for added warmth and tranquillity. Both bedrooms enjoy generous proportions and excellent natural light. One of the highlights of this home is the private balcony, where you can soak up peaceful views over the Thames, perfect for your morning coffee or al fresco dining while watching the river activity unfold.

St. Davids Square combines a peaceful residential setting with convenient access to an array of local amenities. Within walking distance you'll find supermarkets, cafés, restaurants, and green spaces such as Millwall Park, while the vibrant retail, dining and leisure offerings of Canary Wharf are just a short stroll away.

**Tenure:** Leasehold 970 years approx. remaining

**Service Charge:** £4,314 pa approx.

**Ground Rent:** £350 pa

**Local Authority:** Tower Hamlets

**Council Tax Band:** E

Score	Energy rating	Current	Potential
92+	A		
81-91	B		
69-80	C	77 C	83 B
55-68	D		
39-54	E		
21-38	F		
1-20	G		

### *Chestertons Canary Wharf & Greenwich Sales*

Harbour Island

28 Harbour Exchange Square

London

E14 9GE

canarywharf@chestertons.co.uk

020 7510 8300

chestertons.co.uk

# St. Davids Square, E14

○ - Ceiling Height

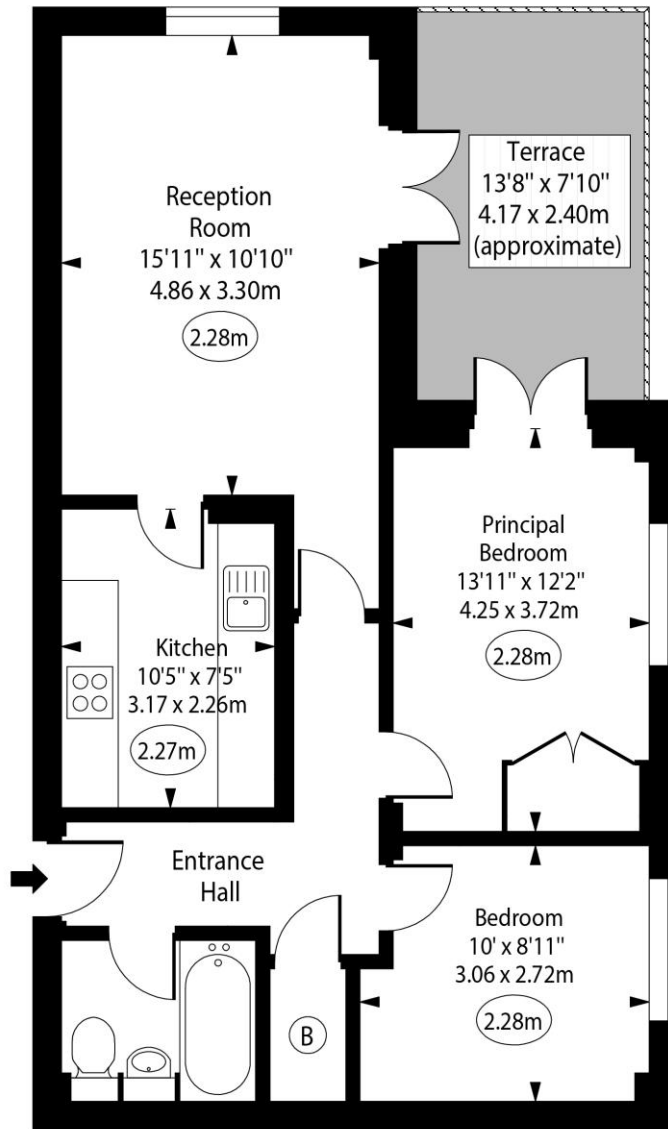
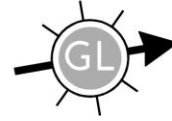

Third Floor

Approx Gross Internal Area      622 Sq Ft - 57.78 Sq M

Every attempt has been made to ensure the accuracy of the floor plan shown. However, all measurements, fixtures, fittings, and data shown are approximate interpretations and for illustrative purposes only. Measured according to the RICS. Not To Scale.

[www.goldlens.co.uk](http://www.goldlens.co.uk)

Ref. No. 030401J

