



Noble Close, Peterborough
£122,000 Leasehold

**Sharman
Quinney**

Key Features



50% Shared Ownership
£371.00 Rent pcm

Ask Agent Years remaining as of Ask Agent
£Ask Agent Ground Rent pcm
Review due: Ask Agent
£Ask Agent Service Charge pcm
Review due: 04/2026

- Three Bedrooms
- Kitchen/Diner
- En-Suite To Master
- Off Road Parking
- Enclosed Rear Garden

GROUND FLOOR

ENTRANCE HALL: Entrance door. Radiator. Built in under stairs cupboard. Stairs to first floor.



CLOAKROOM: UPVC Frosted double glazed window to front. Low level WC. Wash hand basin with mixer tap. Radiator.

KITCHEN/DINER: UPVC Double glazed window to front. Fitted with a range of base and wall units. Stainless steel sink and drainer with mixer tap. Built in oven and fitted hob with cooker hood over. Wall mounted boiler. Radiator.

LOUNGE: UPVC Double glazed French doors to rear. Two radiators.

FIRST FLOOR

LANDING: Loft access. Radiator. Built in airing cupboard.

BEDROOM: UPVC Double glazed window to rear. Radiator.

EN-SUITE: UPVC Double glazed window to side. Low level WC. Wash hand basin with mixer tap. Shower cubicle with mains shower. Heated towel rail.

BEDROOM: UPVC Double glazed window to front. Radiator.

BEDROOM: UPVC Double glazed window to rear. Radiator.



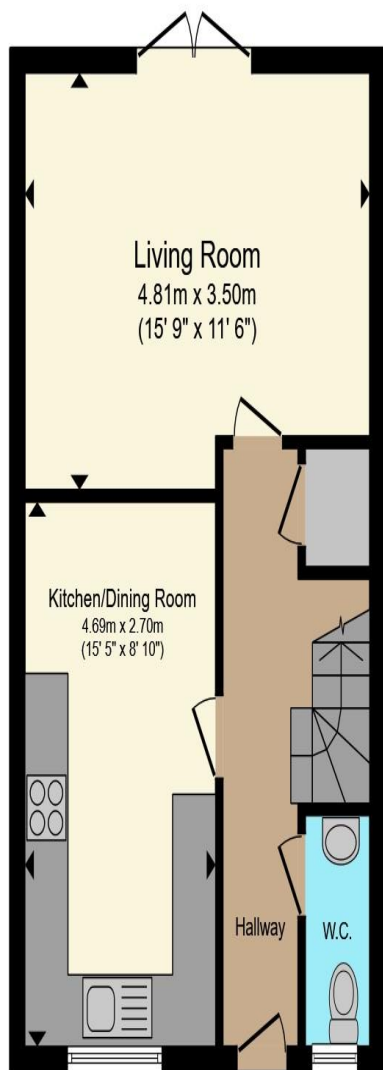

Ground Floor

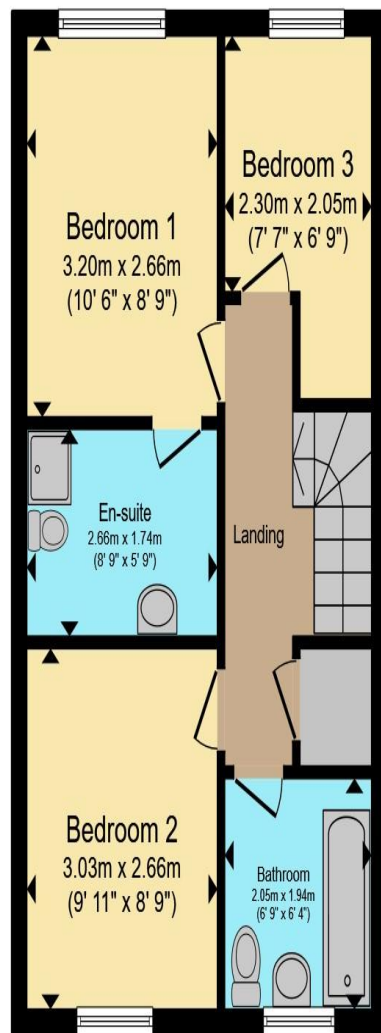

First Floor

Total floor area 78.6 m² (846 sq.ft.) approx

This floor plan is for illustrative purposes only. It is not drawn to scale. Any measurements, floor areas (including any total floor area), openings and orientation are approximate. No details are guaranteed, they cannot be relied upon for any purpose and they do not form part of any agreement. No liability is taken for any error, omission or misstatement. A party must rely upon its own inspection(s). Powered by www.propertybox.io

**Sharman
Quinney**

BATHROOM: UPVC Double glazed window to front. Low level WC. Wash hand basin with mixer tap. Bath with mixer tap and shower attachment. Radiator.

OUTSIDE

FRONT: Driveway providing off road parking.

REAR GARDEN: Enclosed by fencing. Patio area. Laid to lawn area.

NB: The property is 50% shared ownership, the vendor informs us the monthly rent payment to the housing association is £380.00.

All measurements are listed on the floor plan.

To view this property call Sharman Quinney on:
01733 575757

Selling your property?

Contact us to arrange a **FREE**
home valuation.

01733 575757

Loxley Centre, Werrington, Peterborough,
Cambridgeshire, PE4 5BW

werrington@sharmanquinney.co.uk

www.sharmanquinney.co.uk



Sharman Quinney Holdings Limited is registered in England and Wales under company number 4174227, Registered Office is Cumbria House, 16-20 Hockliffe Street, Leighton Buzzard, Bedfordshire, LU7 1GN. VAT Registration Number is 500 2481 05.

1: These particulars do not constitute part or all of an offer or contract. 2: The measurements indicated are supplied for guidance only and as such must be considered incorrect. 3: Potential buyers are advised to recheck the measurements before committing to any expense. 4: Sharman Quinney has not tested any apparatus, equipment, fixtures, fittings or services and it is the buyers interests to check the working condition of any appliances. 5: Sharman Quinney has not sought to verify the legal title of the property and buyers must obtain verification from their legal representative. 6: Intending purchasers will be asked to produce identification documentation at a later stage and we would ask your co-operation in order that there will be no delay in agreeing the sale. Ref:WER205788 -

0001

