



## St. George Wharf, SW8

£2,850 Per calendar month

A two bedroom apartment set in the iconic St. George Wharf development. The property offers a large double bedroom, a study/spare bedroom, a modern kitchen and a reception room with direct access to a balcony, that overlooks the River Thames.

The property is on the fifth floor with fantastic views and is located in this popular modern complex which offers coffee shops, river side restaurants and grocery shops.

### Features

- Overlooks River Thames
- One Double Bedroom
- Study / Spare Bedroom
- Modern Kitchen
- Fifth Floor Apartment
- Concierge

# St. George Wharf, London, SW8

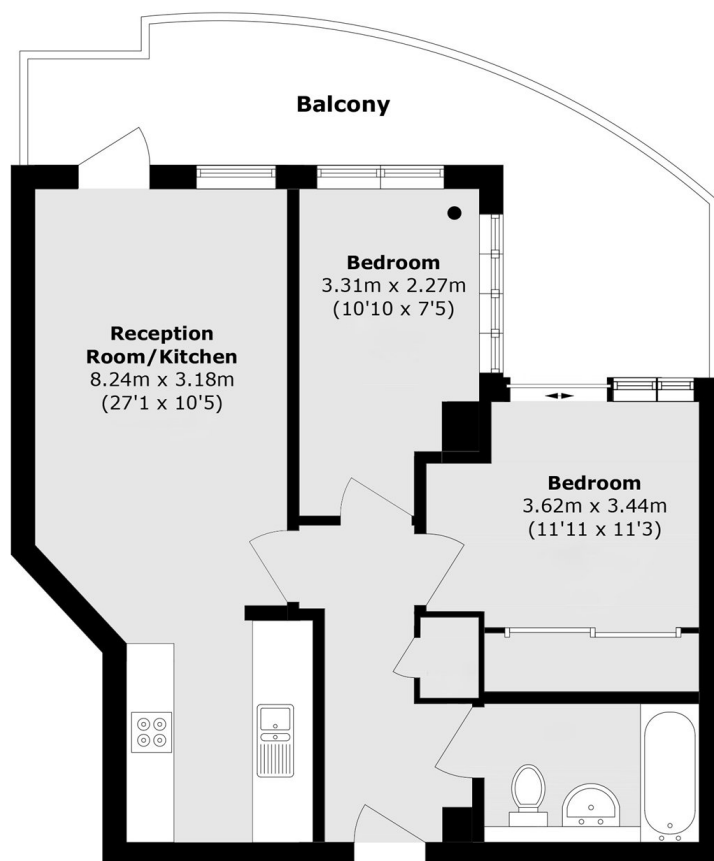

Total area (approx.): 57.9 sq. m (623.2 sq. ft)

Balcony area (approx.): 17.3 sq. m (186.2 sq. ft)