



HUNTERS[®]
HERE TO GET *you* THERE

5 Compton Place, Ellesmere Port,
Cheshire, CH65 8BG

5 Compton Place, Ellesmere Port, Cheshire, CH65 8BG

Asking Price £110,000

Here is one for the First Time Buyer or Landlord looking to add this viable terrace to their portfolio. Offered with no ongoing chain, this home presents well and has a unique feature for a terrace property and that is the large rear garden with the possibility of creating a private driveway.

The town centre of Ellesmere Port is within a reasonable distance and in turn, offers a range of amenities. Schools for all ages are catered for locally.

Do not hesitate and call us today for an early viewing.

Hunters Little Sutton Lettings 339 Chester Road, Little Sutton, CH66 3RG | 0151 339 2465
littlesutton@hunters.com | www.hunters.com

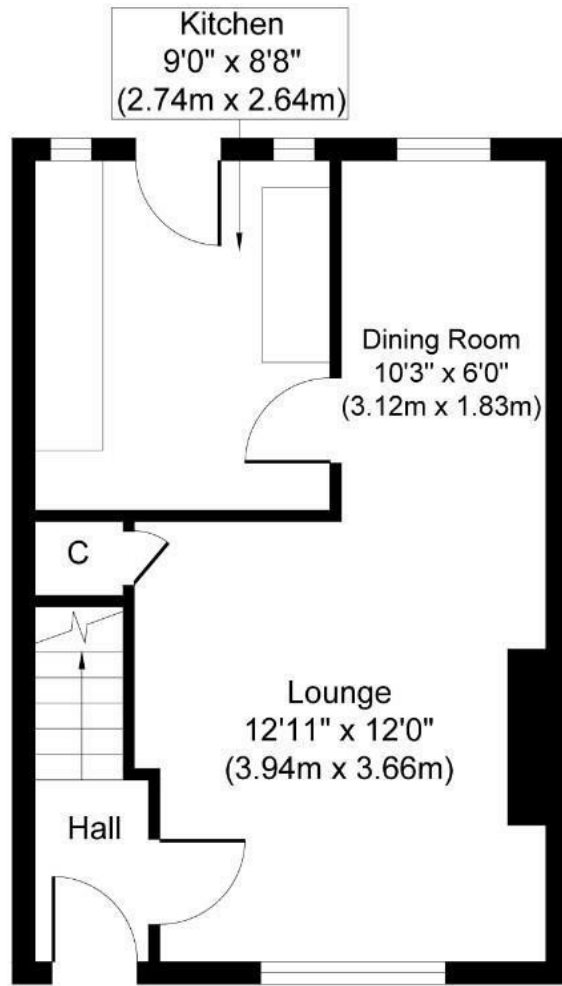

Ground Floor
Approximate Floor Area
353 sq. ft
(32.74 sq. m)

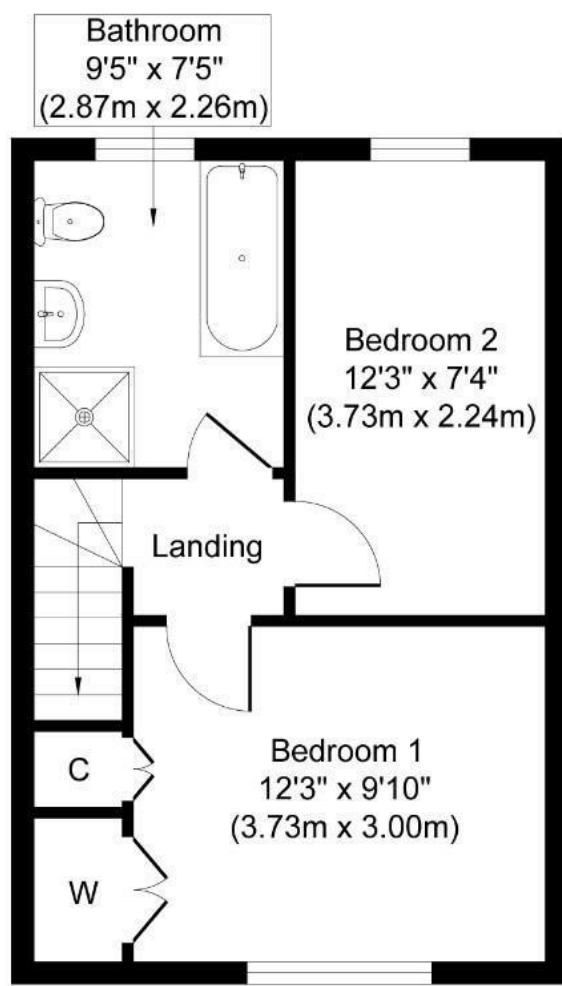

First Floor
Approximate Floor Area
353 sq. ft
(32.74 sq. m)

Whilst every attempt has been made to ensure the accuracy of the floor plan contained here, measurements of doors, windows, rooms and any other items are approximate and no responsibility is taken for any error, omission, or mis-statement. The measurements should not be relied upon for valuation, transaction and/or funding purposes. This plan is for illustrative purposes only and should be used as such by any prospective purchaser or tenant. The services, systems and appliances shown have not been tested and no guarantee as to their operability or efficiency can be given.

Entrance Hall

Laminate floor, stairs to first floor.

Lounge

12'11" x 12'0"

Laminate flooring, double glazed window with blinds to front elevation, under stairs storage, central heating radiator. Open plan design leads to:-

Dining Room

10'3" x 6'0"

Double glazed window with blinds to rear elevation, central heating radiator. Door into:-

Kitchen

9'0" x 8'8"

Fitted with a range of wall and base units in white, four burner gas hob with extractor above, fitted oven, one and a half bowl stainless steel sink unit, washing machine recess, fridge freezer recess, two double glazed windows with a central, double glazed door to the rear garden. Baxi wall mounted boiler, central heating radiator.

First Floor

Staircase leads from hall to first floor landing with loft access.

Bedroom One

12'3" x 9'10"

Fitted storage cupboards, central heating radiator, double glazed window to front elevation.

Bedroom Two

12'3" x 7'4"

Double glazed window with blinds to rear elevation, central heating radiator.

Bathroom

9'0" x 7'5"

Fitted suite in white to include panel bath, low-level WC, pedestal wash basin, separate walk-in shower cubicle, tiled floor, double glazed window with blinds to rear elevation, central heating radiator.

Outside

To the front there is a small enclosed area whilst to the rear is a sizable garden including patio and lawn areas. There may be an opportunity to create private off-road parking, similar to the neighbouring properties.

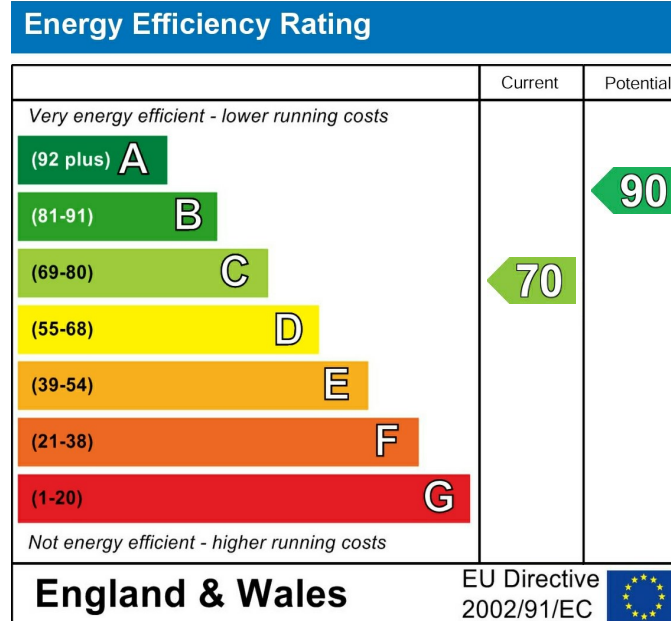

These particulars are intended to give a fair and reliable description of the property but no responsibility for any inaccuracy or error can be accepted and do not constitute an offer or contract. We have not tested any services or appliances (including central heating if fitted) referred to in these particulars and the purchasers are advised to satisfy themselves as to the working order and condition. If a property is unoccupied at any time there may be reconnection charges for any switched off/disconnected or drained services or appliances - All measurements are approximate. If you are thinking of selling your home or just curious to discover the value of your property, Hunters would be pleased to provide free, no obligation sales and marketing advice. Even if your home is outside the area covered by our local offices we can arrange a Market Appraisal through our national network of Hunters estate agents.





