



# Stuart Tower

105 Maida Vale, W9

£2,400 per month  
(£553.85 per week)

A bright 8th floor one bedroom apartment with good living space and its own private balcony. Stuart Tower is a smart portered building on Maida Vale, close to Warwick Avenue & Little Venice High Street.

**CHESTERTONS**



# Stuart Tower

## 105 Maida Vale, W9

- Bright 8th Floor One Bedroom Apartment
- Separate Kitchen
- Private Balcony
- 24 Hour Porter
- Bike Store
- Close to Warwick Avenue & Maida Vale Tube
- EPC C



A bright 8th floor one bedroom apartment with good living space and its own private balcony. Stuart Tower is a smart portered building on Maida Vale, close to Warwick Avenue and Little Venice High Street. EPC C

**Minimum Term:** 12 months  
**Deposit Required:** 5 weeks  
**Local Authority:** City Of Westminster  
**Council Tax Band:** D  
**EPC Rating:** E  
**Furnished**

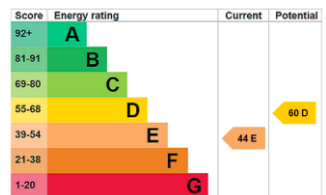

### *Chestertons Little Venice Lettings*

26 Clifton Road  
Maida Vale  
London  
W9 1SX  
littlevenicelettingsusers@chestertons.co.uk  
02072662369  
chestertons.co.uk

Additional tenant charges apply (fees apply to non-AST tenancies only)  
Tenancy Agreement Fee: £300  
References per Tenant/Guarantor: £60  
Inventory check (approx. £100 – £250 inc. VAT)  
chestertons.co.uk/property-to-rent/applicable-fees

# Stuart Tower, Maida Vale, W9

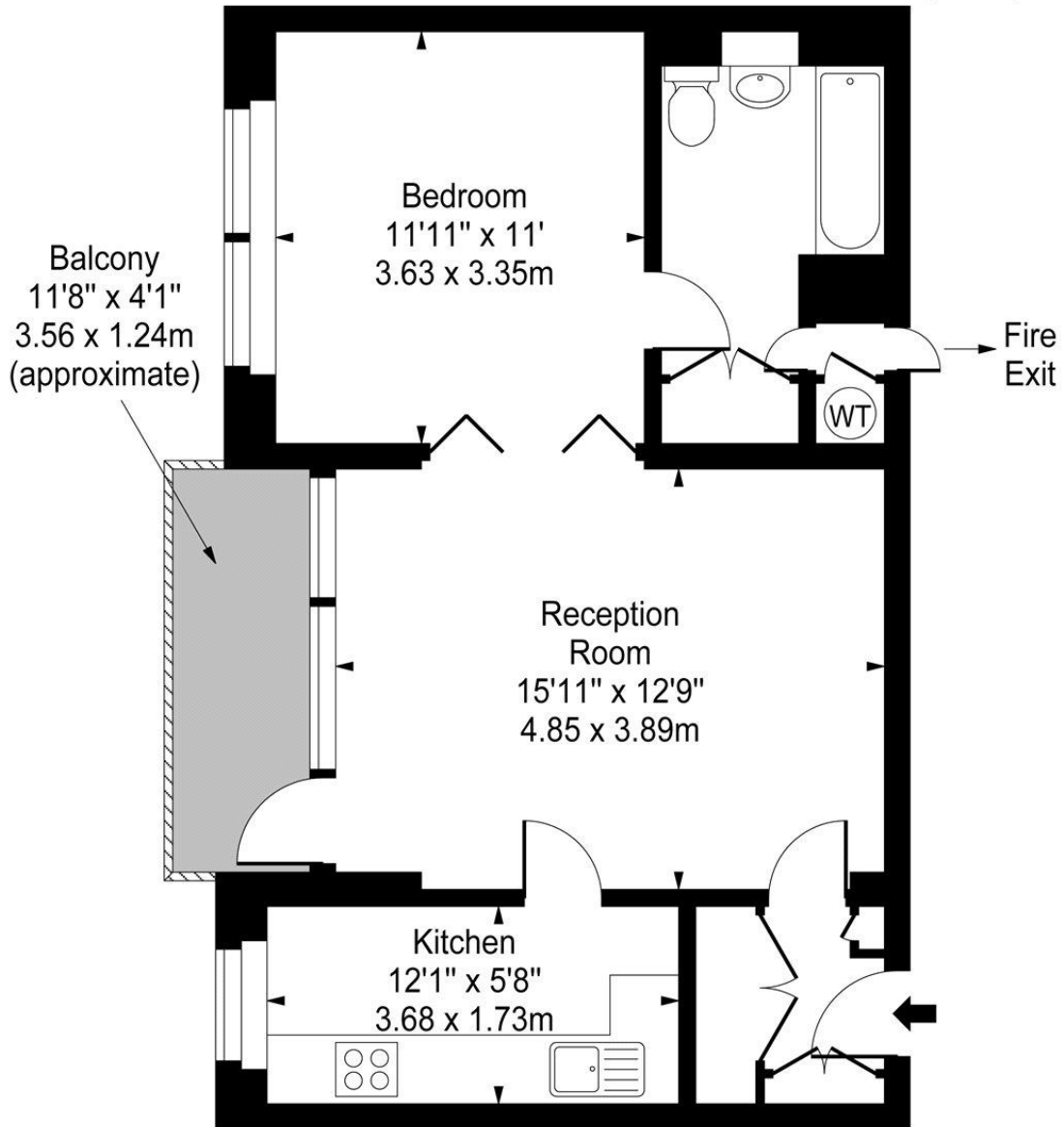
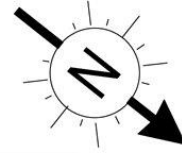

Eighth Floor

Approx Gross Internal Area **532 Sq Ft - 49.42 Sq M**

For Illustration Purposes Only - Not To Scale

[www.goldlens.co.uk](http://www.goldlens.co.uk)

Ref. No. 008947Ga

