



Waverley Court, Thorne, Doncaster



3



1



1

Offers in excess of £160,000

- Kitchen/Diner
- W.C
- Private Parking
- Close To Amenities
- Beautiful Garden With Shed
- Sought After Location
- Freehold
- EPC rating TBC



This neutrally decorated 3-bedroom house is ****for sale**** in the popular town of Thorne, near Doncaster, offering a practical layout and access to good local amenities.

Inside, the property provides one reception room with patio doors opening onto the rear garden, creating a pleasant connection between indoor and outdoor space. The kitchen includes dining space and integrated appliances, making it convenient for everyday cooking and mealtimes. A separate W.C adds useful flexibility to the layout. There are two double bedrooms and one single bedroom, alongside a bathroom. The home falls within Council Tax Band B.

Outside, the garden offers space for relaxation or play, with the added benefit of a garden shed for storage. The property also benefits from its own substantial private driveway.

Thorne benefits from a choice of supermarkets, independent shops, cafes and pubs, as well as local schools and medical facilities. Nearby parks and green spaces provide opportunities for walking and recreation.



Public transport links are a key feature of the area. Thorne North and Thorne South railway stations offer services towards Doncaster, Sheffield, Hull and beyond, with journeys to Doncaster typically around 15-20 minutes, giving straightforward access to wider rail connections. Local bus services further support travel into Doncaster and neighbouring towns, and road links to the M18 make commuting by car practical.

This 3-bedroom house ****for sale**** in Thorne offers a functional home with garden, parking and access to local amenities and transport.

Kitchen/Diner 5.36m(max) x 3.75m(max)

W.C 1.87m(max) x 1.67m(max)

Living Room 5.4m x 2.79m (17'8" x 9'2")

Stairs & Landing

Bathroom 2.43m x 1.79m (8'0" x 5'11")

Bedroom One 2.83m x 2.8m (9'4" x 9'2")

Bedroom Two 2.81m x 2.79m (9'2" x 9'2")

Bedroom Three 2.65m x 1.87m (8'8" x 6'1")



Disclaimer

Disclaimer Waverley Court - These details are intended to give a fair description only and their accuracy cannot be guaranteed nor are any floor plans (if included) exactly to scale. These details do not constitute part of any offer or contract and are not to be relied upon as statements of representation or fact. Intended purchasers are advised to recheck all measurements before committing to any expense and to verify the legal title of the property from their legal representative. Any contents shown in the images contained within these particulars will not be included in the sale unless otherwise stated or following individual negotiations with the vendor. Northwood have not tested any apparatus, equipment, fixtures or services so cannot confirm that they are in working order and the property is sold on this basis.

AML

Should you wish to make an offer on this property we will complete mandatory Anti Money Laundering (AML) checks on behalf of HMRC. We outsource this process to our partners, Coadjute. Coadjute charge a fee for this service.





Ground Floor



First Floor

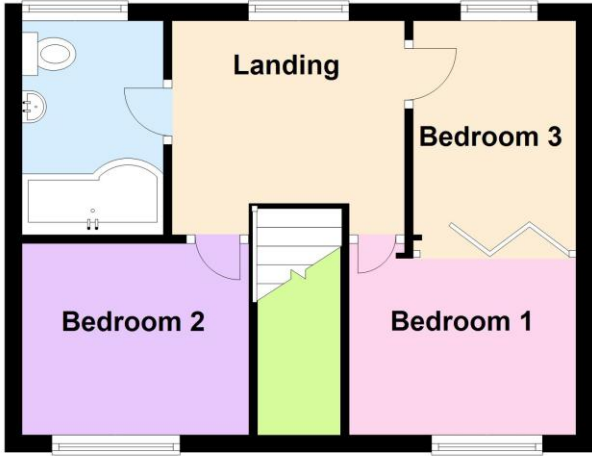

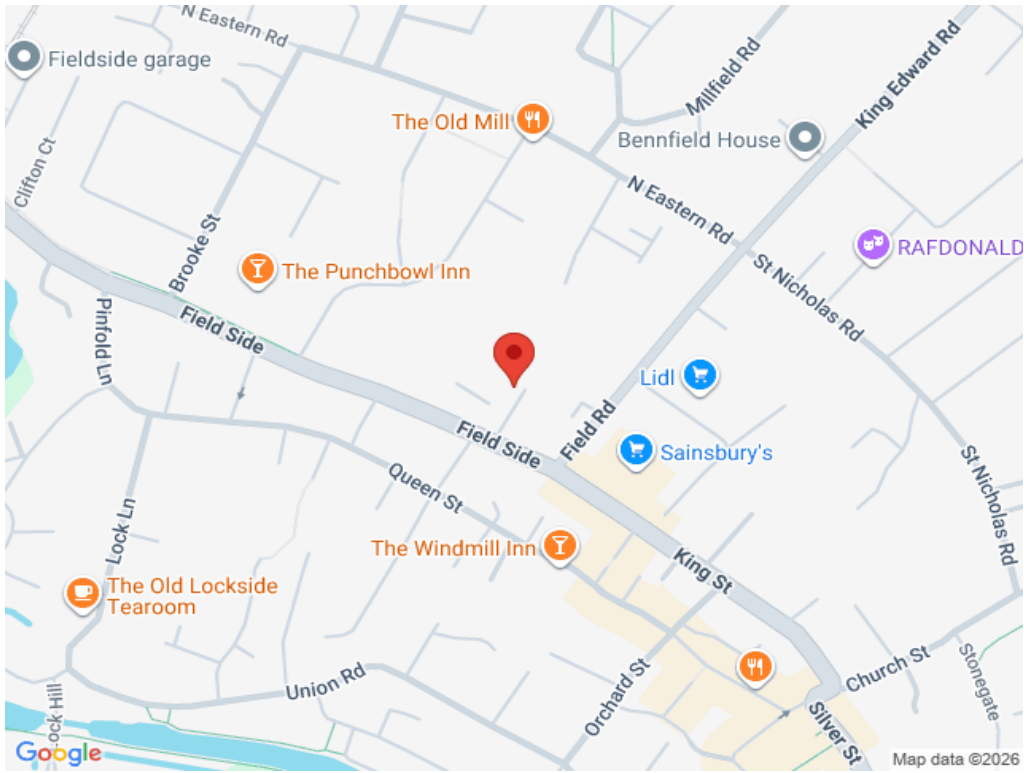

Northwood Thorne

01405 814999

thorne@northwooduk.com