



Bedford Place, BN1
£285,000 - £300,000

ASTON
VAUGHAN

INTRODUCING

Bedford Place, BN1

1 Bedrooms | 1 Bathroom | 1 Reception Room | Sq Ft

An exceptional opportunity awaits those seeking a prime central Brighton base with this well-presented one-bedroom flat, ideally situated on Bedford Place. This property combines convenience, comfort, and a highly sought-after location. A charming home ideal for first-time buyers, investors or those seeking a Brighton pied-à-terre.

The property is entered into a bright and welcoming open-plan living space, thoughtfully designed to maximise both comfort and functionality. The sitting area provides an inviting place to relax, while the dining space creates an ideal setting for entertaining or everyday living. The contemporary kitchen is fitted with a range of modern units, integrated appliances and practical storage, creating a sleek and sociable hub of the home.

The generous double bedroom is calm and spacious, beautifully decorated in neutral tones and offering ample room for wardrobes and additional furnishings. Natural light enhances the sense of space, while the overall presentation means the property is ready for immediate occupation.

A particular feature of this home is the private rear courtyard garden, complete with decked seating area and mature planting. Rarely found with one-bedroom flats in such a central location, this outdoor space provides an excellent extension of the living accommodation and is perfect for al fresco dining, morning coffee or relaxing in the warmer months.





ASTON
VAUGHAN



Education:

Brunswick Primary School

Hove Park, Cardinal Newman secondary schools

6th forms at BHASVIC, City College, BIMM

Private schools: Brighton College, Brighton & Hove Girls

Good To Know:

Between Regency Square and historic Brunswick Town this is a great place to be with almost instant access to the beach and fashionable Western Road. Both the squares and Hove Lawns have a friendly community and hold events during festivals so you won't feel isolated if you are new to the city. Tucked away from tourists it is quieter than its fashionable location would suggest, local schools are good and this sought- after location has fashionable shopping, restaurants, clubs, cinemas and theatres. Close to the commercial districts and cultural heart of the city, the whole of Brighton and Hove is easy to reach and both Brighton Station's direct trains to Gatwick and London is a 20 min walk, or 7 mins by cab

Bedford Place

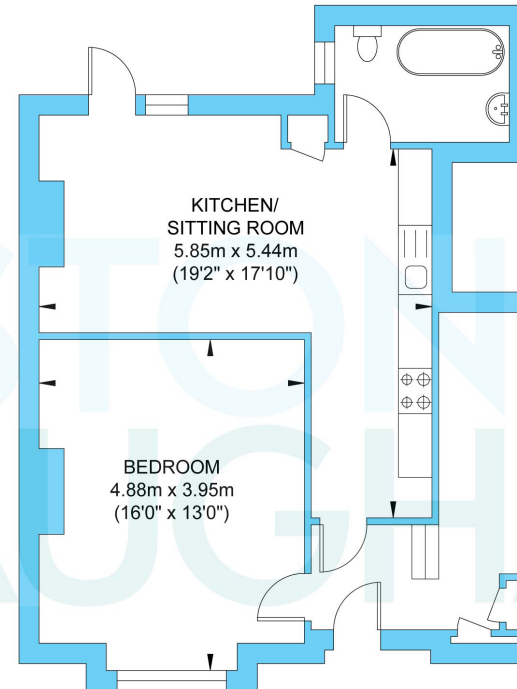

Lower Ground Floor
Approximate Floor Area
603.31 sq ft
(56.05 sq m)

Approximate Gross Internal Area = 56.05 sq m / 603.31 sq ft
Illustration for identification purposes only, measurements are approximate, not to scale.