



CHRISTOPHER WOOD POWERED BY **exp**™ UK

@ christopher.wood@exp.uk.com

christopherwood.exp.uk.com

☎ 01494 623 101

# Darvell Drive, Chesham, HP5

Guide Price £315,000

🛏️ 2 🚿 1 🚗 1



- 2 double bedroom 1st floor maisonette
- Bathroom with bath/shower
- Sitting room with space for dining table and feature fire place
- Loft for storage
- Beautiful views over Countryside
- Garden with patio area
- Single garage in a block
- Long lease



A share of freehold, bright and spacious two double bedroom first floor maisonette, in a peaceful Chesham location, offering stunning countryside views....

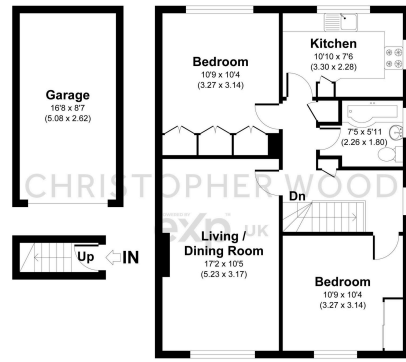

Ground Floor

First Floor

Darvell Drive, HP5

APPROXIMATE GROSS INTERNAL AREA 800 SQ FT / 75.19 SQ M INC. GARAGE  
CHRISWOOD: THIS IMAGE IS ILLUSTRATIVE ONLY - NOT TO SCALE. COPYRIGHT THE IMAGE TALKER LTD. 2025

13062025\_1100

Energy performance certificate (EPC) - Find an energy certificate - GOV.UK

Energy performance certificate (EPC)		
35 Darvell Drive CHESHAM HP5 2QJ	Energy rating <b>C</b>	Valid until: 3 June 2035 Certificate number: 6241-3051-8208-0095-1209
Property type	Top floor maisonette	
Total floor area	63 square metres	

**Rules on letting this property**

Properties can be let if they have an energy rating from A to E.

You can read [guidance for landlords on the regulations and exemptions](https://www.gov.uk/guidance/energy-ratings-for-landlords) (<https://www.gov.uk/guidance/energy-ratings-for-landlords>).

**Energy rating and score**

This property's energy rating is C. It has the potential to be C.

[See how to improve this property's energy efficiency.](#)

The graph shows this property's current and potential energy rating.

Properties get a rating from A (best) to G (worst) and a score. The better the rating and score, the lower your energy bills are likely to be.

For properties in England and Wales:

the average energy rating is D  
the average energy score is 60

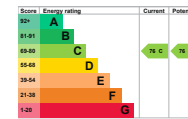

<https://find-energy-certificate.service.gov.uk/energy-certificates/6241-3051-8208-0095-1209/print>

14

eXp World UK Ltd is a registered company at Level 37, 25 Canada Square, London, E14 5LQ.

Registered company number is 12016573. VAT Registration Number is 327 4120 29