



SELHURST CLOSE, SW19

£1,650 per month

One bedroom
Top floor
Allocated parking
Fitted wardrobes
Unfurnished
Energy rating: c

@marshandparsons
marshandparsons.co.uk

MARSH &
PARSONS



ABOUT THE PROPERTY

A one bedroom top floor apartment offering a spacious lounge, separate kitchen, one double bedroom with fitted wardrobes, bathroom with bath and separate shower cubicle. The property also offers one allocated parking space.

The property is within a popular development adjacent to Wimbledon Common.



STEP INSIDE SELHURST CLOSE

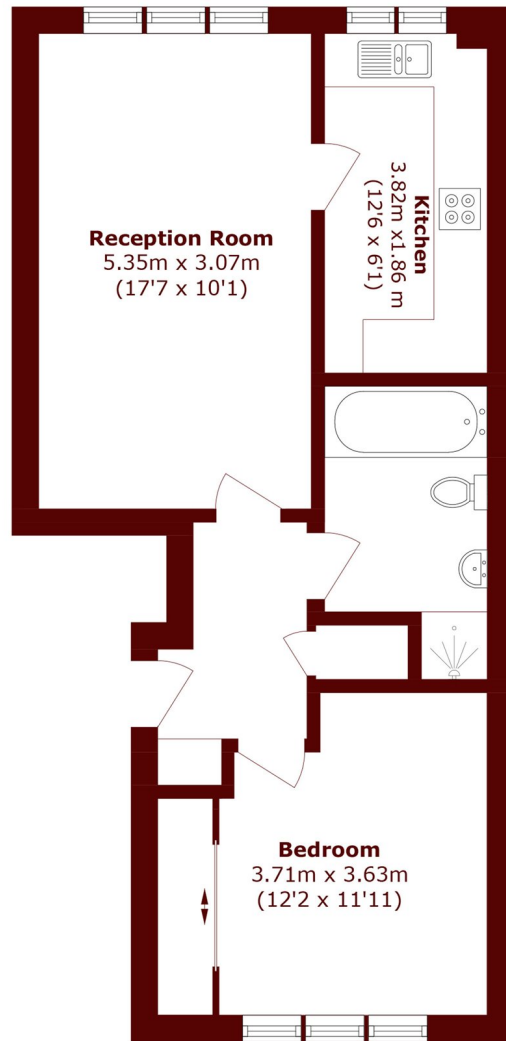

Total area (approx.): 47.5 sq. m (511.2 sq. ft)

Wimbledon
020 8879 6661

Energy Rating: C We aim to make our particulars both accurate and reliable. However, they are not guaranteed; nor do they form part of an offer or contract. If you require clarification on any points then please contact us, especially if you're traveling some distance to view. Please note that appliances and heating systems have not been tested and therefore no warranties can be given as to their good working order

MARSH &
PARSONS