



10 Pilot Street, King's Lynn, PE30 1QL

£325,000

Bedrooms: 4 | Bathrooms: 2 | Receptions: 2

Set along one of King's Lynn's most historic and picturesque streets, this distinguished four-bedroom terraced residence offers a rare chance to become part of the town's rich and enduring story. With the town centre just moments from your door, the setting is as convenient as it is captivating, further enhanced by charming views of a charming nearby church and easy links to the train station and local amenities.

From the very first glance, the home exudes timeless elegance. Inside, a wealth of period features unfolds, from soaring ceilings to tall sash-style windows that bathe each room in natural light. Characterful fireplaces provide beautiful focal points, evoking a sense of warmth and heritage that runs throughout.

The journey begins in a welcoming tiled entrance hall, an inviting space that hints at the charm beyond. To the left, the living room offers a refined yet comfortable retreat, perfect for quiet evenings or entertaining guests. Beyond, the dining room is a particularly special space, rich in character and atmosphere, where gatherings feel both intimate and memorable. From here, the home flows naturally into the kitchen, accompanied by a pantry, a potential versatile utility space, and a well-appointed ground floor shower room, all designed to support modern living while respecting the home's historic character.

A door tucked beneath the stairs reveals practical storage and leads through to an exceptional 28ft garage, an uncommon and valuable feature in such a central location. Whether retained as secure parking, a workshop, or reimagined entirely (subject to the necessary permissions), this space offers exciting possibilities.

Upstairs, the sense of light and proportion continues. Three generous double bedrooms provide elegant and restful accommodation, while a fourth, smaller room lends itself perfectly as a nursery, study, or dressing room. The family bathroom serves this level, complemented by a beautiful landing space where natural light pours in, creating a calm and airy atmosphere.

Outside, the property offers a secure courtyard garden, an ideal spot for morning coffee or evening relaxation, alongside a handy brick-built outbuilding that adds further flexibility.

Altogether, this is more than just a home; it is a piece of King's Lynn's heritage, thoughtfully offering space, character, and an enviable lifestyle in one of its most treasured settings.

Book your viewing now!

Tenure: Freehold

Property Type: Terraced House

- Terraced House
- Four Generous Bedrooms
- A Unique Opportunity to Own a Character-Filled Home in A Desirable Historic Setting
- 28ft Garage
- Set on a Picturesque Street in King's Lynn
- Spacious and Versatile Accommodation
- Sought After Location - Town Centre on Your Doorstep
- No Onward Chain
- Walking Distance to Train Station and Amenities
- Conservation Area

Disclaimer

1. To meet money-laundering regulations, all buyers will need to complete an ID check. We'll ask you to provide the necessary documents, and there's a small fee of £20.50 per client for this service.
2. We do our best to make sure our property details are fair, accurate, and up to date, but they're meant as a general guide only. If there's anything particularly important to you, please get in touch - we'll be happy to look into it further.
3. All measurements are provided as a guide and may not be exact.
4. We haven't tested any of the property's services, equipment, or appliances. We recommend that buyers arrange their own survey or service checks before making a final offer.
5. These details are provided in good faith, but they don't form part of any offer or contract. Buyers should verify any points that are important to them before proceeding.



The perfect space for a pantry

GROUND FLOOR
1038 sq.ft. (96.4 sq.m.) approx.

1ST FLOOR
803 sq.ft. (74.6 sq.m.) approx.

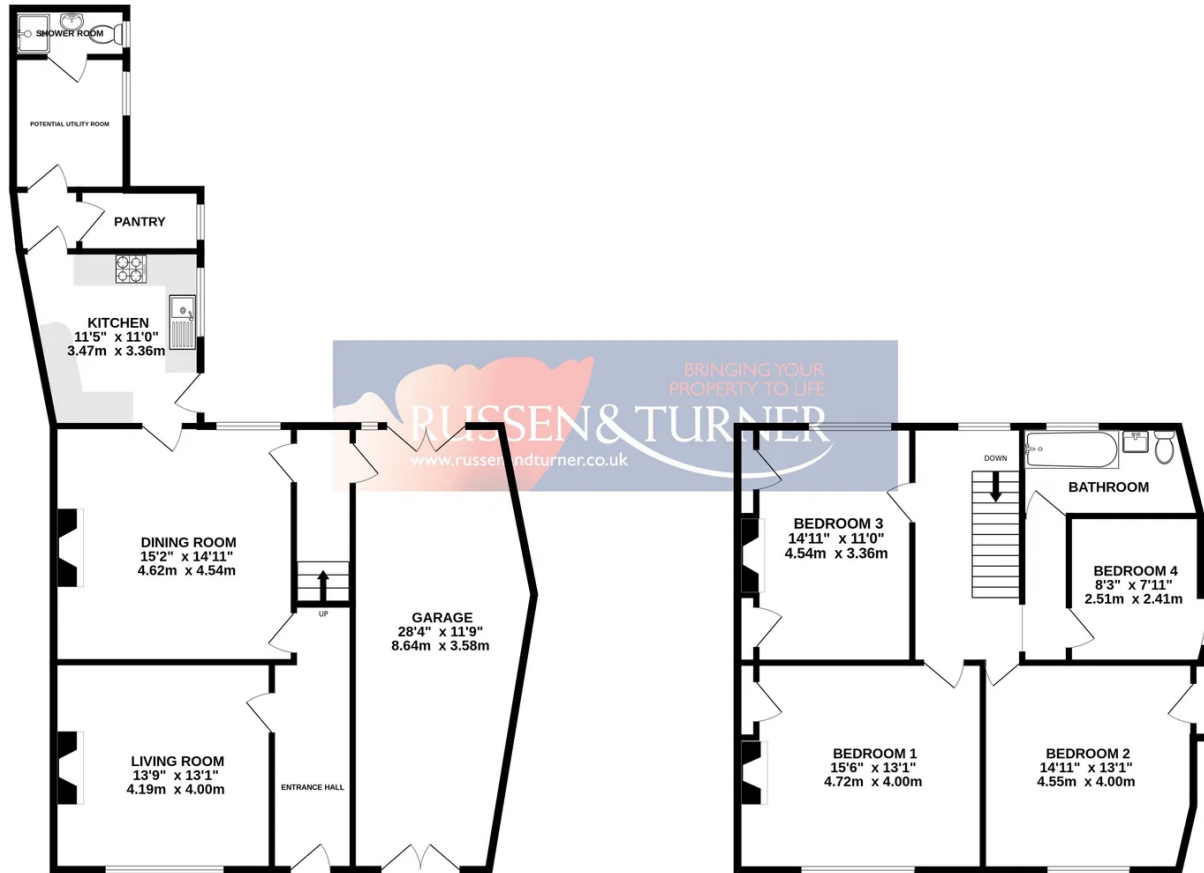

TOTAL FLOOR AREA : 1841 sq.ft. (171.0 sq.m.) approx.

Whilst every attempt has been made to ensure the accuracy of the floorplan contained here, measurements of doors, windows, rooms and any other items are approximate and no responsibility is taken for any error, omission or mis-statement. This plan is for illustrative purposes only and should be used as such by any prospective purchaser. The services, systems and appliances shown have not been tested and no guarantee as to their operability or efficiency can be given.
Made with Metropix ©2026