



MILE



Pember Road, London NW10

£600,000 Leasehold

Welcome to Pember Road – a charming two-bedroom garden flat positioned on one of Kensal Rise’s most peaceful residential roads. Set within a characterful building and lovingly cared for by the current owners, this well-presented home extends to 637 sq ft and offers warmth and charm throughout. To the rear, a south-facing private garden provides the perfect spot to enjoy sunlight throughout the day. Pember Road enjoys a particularly special position on the southern side of Kensal, creating a quieter, more tucked-away setting while still placing you within easy reach of the area's most loved destinations. It offers excellent access towards Notting Hill, Ladbroke Grove and the iconic Portobello Road Market, making it a fantastic option for buyers looking to enjoy the best of Kensal Rise while staying connected to neighbouring hotspots. As the road isn't used as a cut-through or rat run, there's a genuine village atmosphere here – a close-knit community feel that's increasingly hard to find in London. A much-loved home in a fantastic location, offering charm, lifestyle and that sought-after Kensal balance of quiet living with vibrant surroundings close by.

- **Great garden apartment**
- **Two double bedrooms**
- **Great south facing garden**
- **Excellent condition**
- **Period conversion**
- **Quiet residential road**
- **Separate kitchen**
- **Double glazed windows**
- **Fantastic location**
- **Close to shops and transports**

# Pember Road, NW10 5LR

Approximate Gross Internal Area 637 sq ft / 59.2 sq m

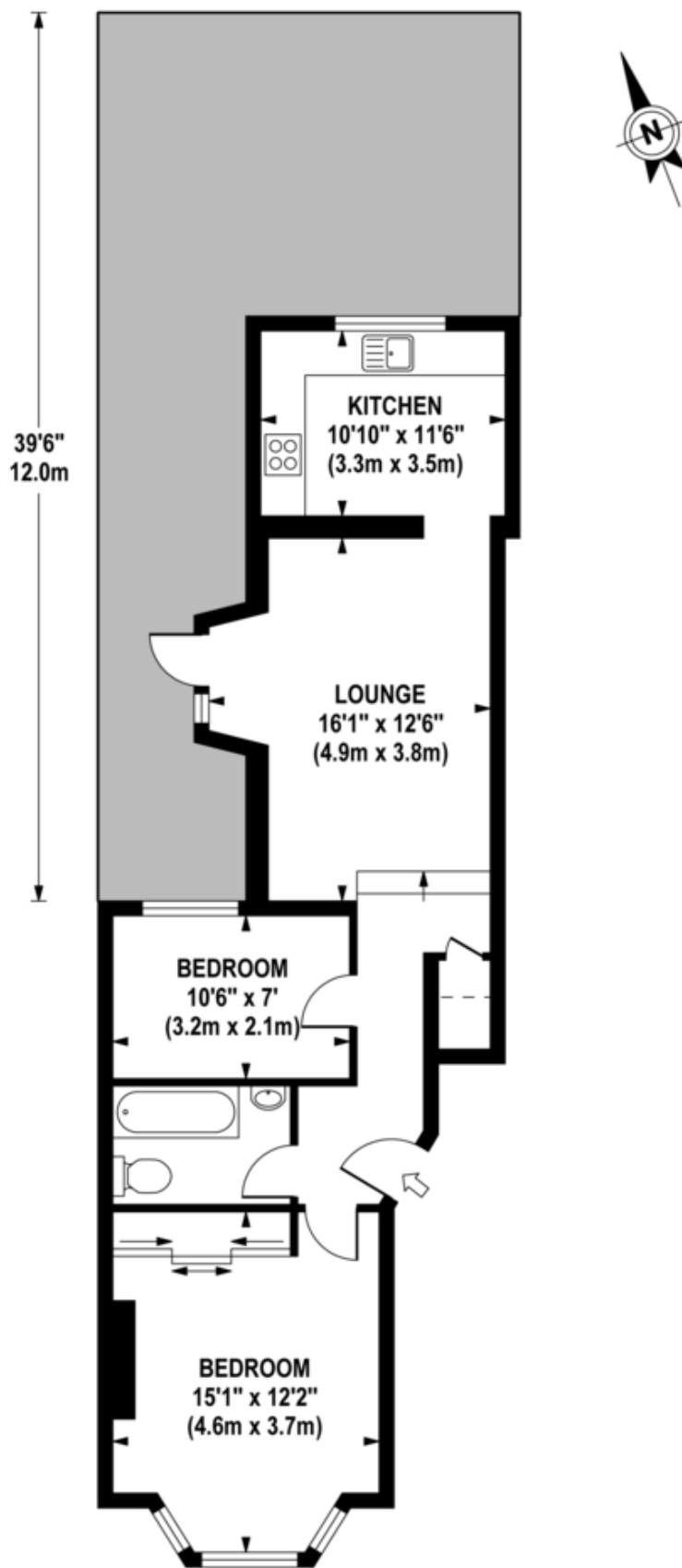

**GROUND FLOOR  
GROSS INTERNAL  
FLOOR AREA 637 SQ FT**

*Although every attempt has been made to ensure accuracy, all measurements are approximate.*

**MONEY LAUNDERING REGULATIONS 2003:** Intending purchasers will be asked to produce identification documentation at a later stage and we would ask for your co-operation in order that there will be no delay in agreeing the sale.

**General:** While we endeavour to make our sales particulars fair, accurate and reliable, they are only a general guide to the property and, accordingly, if there is any point which is of particular importance to you, please contact the office and we will be pleased to check the position for you, especially if you are contemplating travelling some distance to view the property.

**Measurements:** These approximate room sizes are only intended as general guidance. You must verify the dimensions carefully before ordering carpets or any built-in furniture.

**Services:** Please note we have not tested the services or any of the equipment or appliances in this property, accordingly we strongly advise prospective buyers to commission their own survey or service reports before finalising their offer to purchase.