



127 South Road Taunton TA1 3ED



A rare opportunity to acquire a classic 5 double bedroomed Victorian townhouse arranged over 3 floors, recently updated throughout within 1 mile of the town centre providing flexible accommodation combining period character with practical modern living with 2 reception rooms, superb open plan Kitchen / Dining / Glass Room, enclosed established walled garden to rear and ample driveway parking. No onward chain.





Features

- Entrance Porch
- Entrance Hall
- Living Room with gas fire
- Family Room with woodburner and French doors to Glass Room
- Fitted Kitchen / Dining Room with Velux windows and bi-fold doors to Glass Room
- Glass Room with door to garden
- Cloakroom
- Master Bedroom with fitted wardrobes and Ensuite Shower Room
- 2 further double Bedrooms on 1st floor
- Family Bathroom
- 2 further double Bedrooms on 2nd floor
- Shower Room
- Enclosed established walled garden to rear with useful shed
- Ample driveway parking with EV charging point
- Gas central heating
- Double glazing
- Original period features
- Council tax band E
- What3words:
///divisions.dish.always







South Road is situated close to local amenities and within a few minutes' walk of the centre of Taunton, the County Town of Somerset.

The town is a bustling, forward-looking town with excellent amenities, a good selection of independent and high street shops, distinctive restaurants, cafés, a wealth of history and sporting facilities including the County Cricket Ground.

Taunton benefits from a main line railway station linking to London Paddington in less than 2 hours and excellent communications for the M5 motorway at junction 25, situated on the eastern side of the town.

Taunton also offers a good selection of both state and independent schools including Bishops Fox's School, Taunton School, King's and Queen's Colleges and Richard Huish Sixth Form College.



127 South Road, Taunton, TA1 3ED

Approximate Area = 2199 sq ft / 204.2 sq m

For identification only - Not to scale

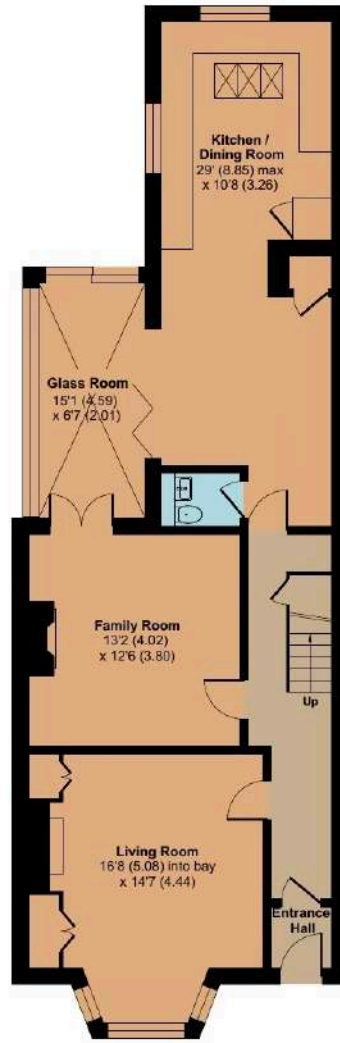

GROUND FLOOR



FIRST FLOOR

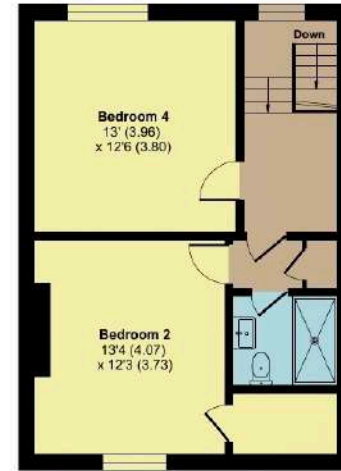

SECOND FLOOR

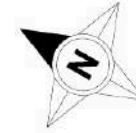

Viewing strictly through the selling agents:

Robert Cooney

Corporation Street, Taunton,
Somerset TA1 4AW

Telephone 01823 230 230

E-mail taunton@robertcooney.co.uk

Website robertcooney.co.uk

Floor plan produced in accordance with RICS Property Measurement 2nd Edition, Incorporating International Property Measurement Standards (IPMS2 Residential). © n4cheom 2026. Produced for Robert Cooney. REF: 1456345.

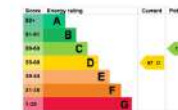

For clarification, we wish to inform prospective purchasers that these particulars are set out as a general outline only for the guidance of intended purchasers, and do not constitute, nor constitute part of, an offer or contract; all descriptions, dimensions, references to condition and necessary permission for use and occupation, and other details, are given without responsibility and any intending purchasers should not rely on them as statements or representation of fact, but must satisfy themselves by inspection or otherwise as to the correctness of each of them; no person in the employment of Robert Cooney has any authority to make or give any representation or warranty whatever in relation to this property; we have not carried out a detailed survey nor tested the services, appliances and specific fittings.

**robert
cooney**

