



14 Rivington Drive, Burscough

Ormskirk

Guide Price £220,000

# 14 Rivington Drive

Burscough, Ormskirk

Three-bedroom semi-detached on Rivington Drive, Burscough. No chain. Garage, driveway, gardens, kitchen diner, gas central heating, double glazing. Great potential in a sought-after area. Council Tax band: C

Tenure: Freehold

EPC Energy Efficiency Rating: C

EPC Environmental Impact Rating: C

- No onward chain
- Three-bedroom semi-detached home
- Popular residential location in Burscough
- Bright and spacious living accommodation
- Kitchen diner
- Integral garage with internal access





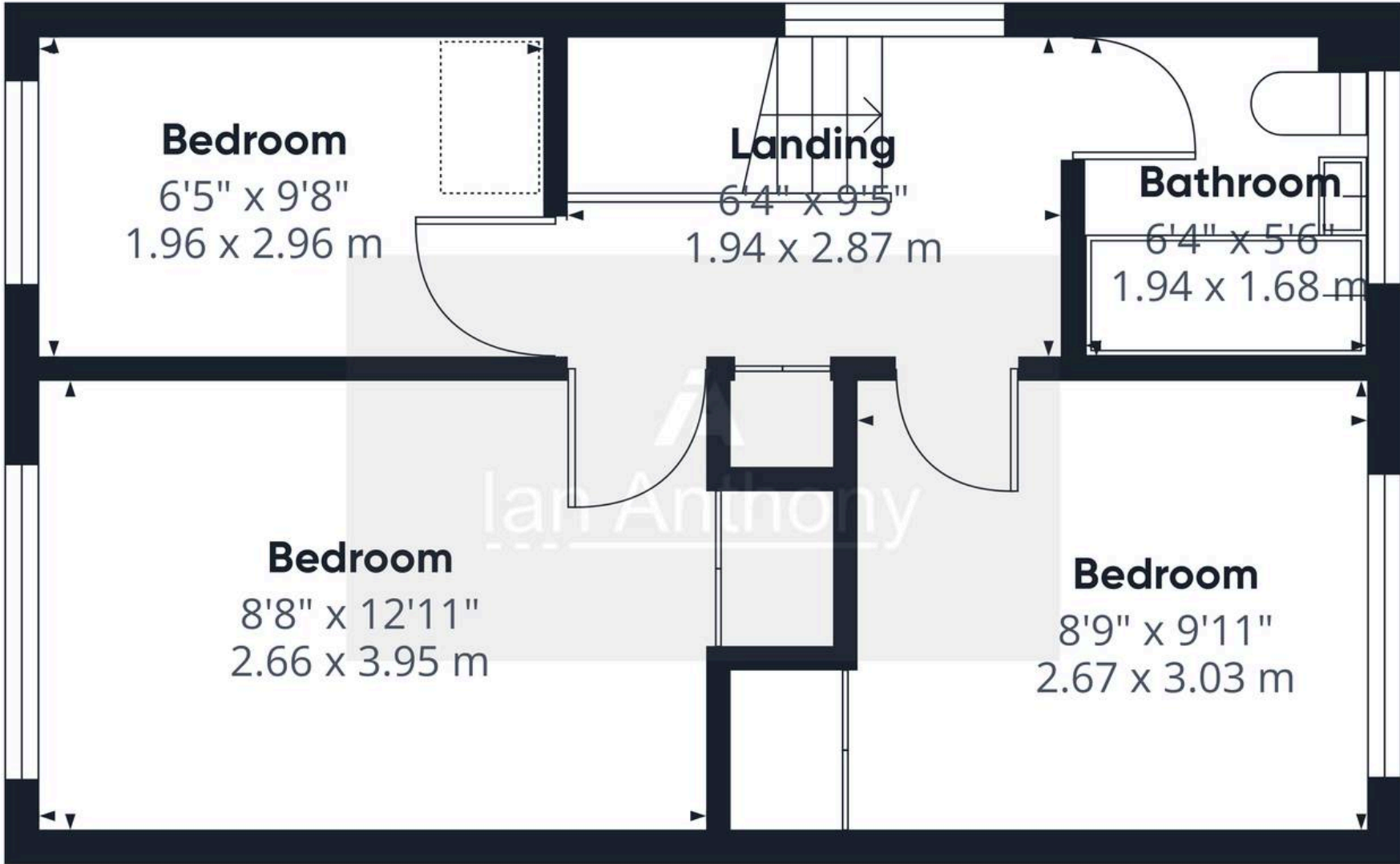

Approximate total area<sup>(1)</sup>

360 ft<sup>2</sup>  
33.5 m<sup>2</sup>

(1) Excluding balconies and terraces

Calculations reference the RICS IPMS 3C standard. Measurements are approximate and not to scale. This floor plan is intended for illustration only.

GIRAFFE360



Floor 1



## IAN ANTHONY

5 Burscough Street, Ormskirk - L39 2EG

01695580888

[enquiries@iananthonyestates.co.uk](mailto:enquiries@iananthonyestates.co.uk)

[iananthonyestates.co.uk/](http://iananthonyestates.co.uk/)

