

# Kensington House

West Drayton • Middlesex • UB7 9DG

PCM: £1,300 PCM



coopers  
est 1986

A beautiful one double bedroom apartment, located in Park West in West Drayton. This property is located a walking distance from West Drayton high street, and it is a short drive to Uxbridge shopping center. London is just twenty five minutes away on a train.

Accommodation; One double bedroom, Lounge, Fitted kitchen with appliances, Bathroom. Benefits; Electric heating, Double glazing, Secure undercroft parking, Beautiful communal grounds, Entry-phone system. PART FURNISHED.

Conceirge

Manhattan style apartment

Gymnasium

Allocated Parking

Beautiful Communal Gardens

Close to Stockley Business Park

Walking Distance to West Drayton High Street

Easy access to M4/M25

Fully fitted kitchen

Well Presented

**Available Date**

13th April 2026

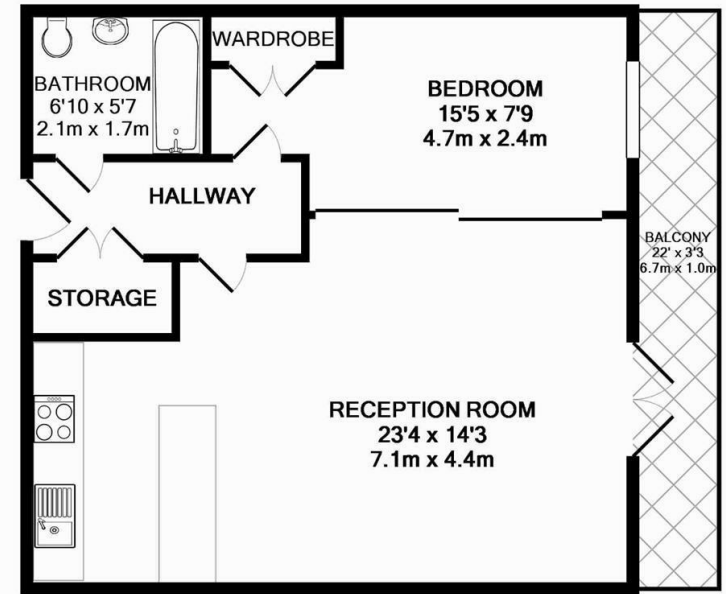

TOTAL APPROX. FLOOR AREA 508 SQ.FT. (47.2 SQ.M.)

Whilst every attempt has been made to ensure the accuracy of the floor plan contained here, measurements of doors, windows, rooms and any other items are approximate and no responsibility is taken for any error, omission, or mis-statement. This plan is for illustrative purposes only and should be used as such by any prospective purchaser. The services, systems and appliances shown have not been tested and no guarantee as to their operability or efficiency can be given  
Made with Metropix ©2015



**01895 230 103**

109 Hillingdon Hill, Hillingdon Village,  
Middlesex, UB10 0JQ  
propertymanagement@coopersresidential.co.uk

**CoopersResidential.co.uk**

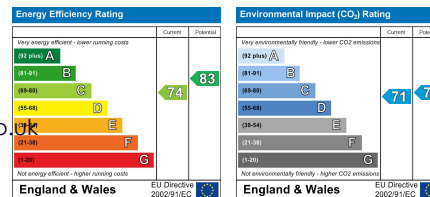

Important Notice: These particulars, whilst believed to be accurate are set out as a general outline only for guidance and do not constitute any part of an offer or contract. Intending purchasers should not rely on them as statements or representation of fact, but must satisfy themselves by inspection or otherwise has the authority to make or give any representation or warranty in respect of the property.

**coopers**  
est 1986