



Dawley Crescent, Marston Green Birmingham B37 7RU

welcome to

Dawley Crescent, Marston Green Birmingham

****SOUGHT AFTER LOCATION**MAISONETTE**GROUND FLOOR**LOUNGE**REFITTED KITCHEN**ONE BEDROOM**SHOWER ROOM**ALLOCATED PARKING SPACE**FRONT AND REAR GARDENS****



Entrance Porch

Double-glazed windows to side, storage cupboard and doors to bathroom, bedroom and lounge.

Entrance Hall

Radiator, ceiling light point, two doors, three storage cupboards.

Lounge

Double-glazed door, radiator, ceiling light point and media wall.

Kitchen

Double-glazed window to rear, cupboards drawers and base units, roll top work surface, sink and drainer, integrated washer/dryer, dishwasher, fridge freezer, hob, oven, cooker hood and concealed central heating boiler.

Bedroom One

Double-glazed window to front, radiator, ceiling light point and fitted wardrobes.

Shower Room

Double-glazed window to front, heated towel rail, walk in shower, vanity sink unit, low level w.c., spotlights, tiled walls and panelled walls.

Rear Garden

Paved area to rear garden, artificial grass, water tap, electricity point, brick shed, and gate for side access.

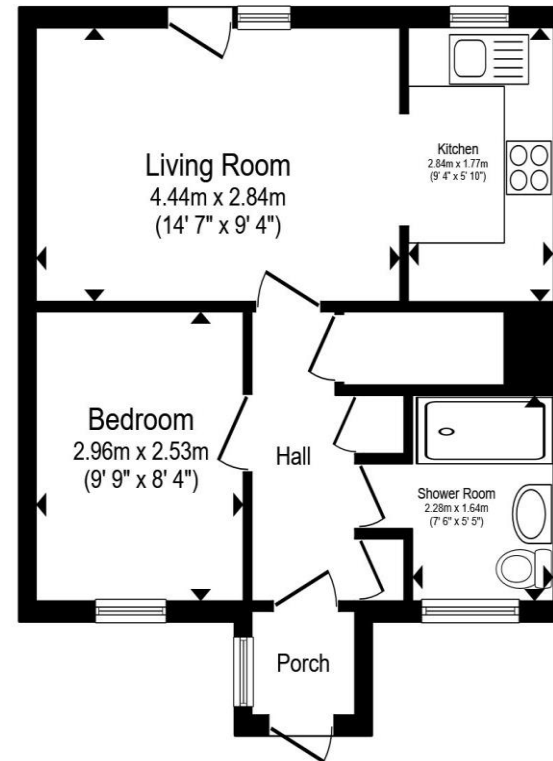

Total floor area 38.4 m² (414 sq.ft.) approx

This floor plan is for illustrative purposes only. It is not drawn to scale. Any measurements, floor areas (including any total floor area), openings and orientation are approximate. No details are guaranteed, they cannot be relied upon for any purpose and they do not form part of any agreement. No liability is taken for any error, omission or misstatement. A party must rely upon its own inspection(s). Powered by www.propertybox.io



view this property online shipways.co.uk/Property/CAB112421



welcome to

Dawley Crescent, Marston Green Birmingham

- GROUND FLOOR MAISONETTE
- ONE BEDROOM
- FULLY RE FURBISHED WITH NEW KITCHEN AND SHOWER ROOM
- SMALL REAR GARDEN
- ALLOCATED PARKING

Tenure: Leasehold EPC Rating: C

Council Tax Band: A Service Charge: Ask Agent

Ground Rent: Ask Agent

This is a Leasehold property with details as follows; Term of Lease 999 years from 01 Jan 1994. Should you require further information please contact the branch. Please Note additional fees could be incurred for items such as Leasehold packs.

offers over



Please note the marker reflects the postcode not the actual property

view this property online shipways.co.uk/Property/CAB112421



Property Ref:
CAB112421 - 0003

1. MONEY LAUNDERING REGULATIONS Intending purchasers will be asked to produce identification documentation at a later stage and we would ask for your co-operation in order that there is no delay in agreeing the sale. 2. These particulars do not constitute part or all of an offer or contract. 3. The measurements indicated are supplied for guidance only and as such must be considered incorrect. Potential buyers are advised to recheck measurements before committing to any expense. 4. We have not tested any apparatus, equipment, fixtures or services and it is in the buyers interest to check the working condition of any appliances. 5. Where an EPC, or a Home Report (Scotland only) is held for this property, it is available for inspection at the branch by appointment. If you require a printed version of a Home Report, you will need to pay a reasonable production charge reflecting printing and other costs. 6. We are not able to offer an opinion either written or verbal on the content of these reports and this must be obtained from your legal representative. 7. Whilst we take care in preparing these reports, a buyer should ensure that his/her legal representative confirms as soon as possible all matters relating to title including the extent and boundaries of the property and other important matters before exchange of contracts.

Shipways is a trading name of Sequence (UK) Limited which is registered in England and Wales under company number 4268443, Registered Office is Cumbria House, 16-20 Hockliffe Street, Leighton Buzzard, Bedfordshire, LU7 1GN. VAT Registration Number is 500 2481 05.

shipways



0121 747 4722



castlebromwich@shipways.co.uk



258 Chester Road, Castle Bromwich,
BIRMINGHAM, West Midlands, B36 0JE



shipways.co.uk