

## St. Anns Chapel, Gunnislake, PL18

Guide Price £290,000

2 1 2



A charming detached country cottage, set on a generous plot within a sought-after village in the Tamar Valley. This delightful home offers a peaceful rural lifestyle, complemented by a private driveway, detached garage and no onward chain.

Situated in the village of St Ann's Chapel, the property lies approximately 4 miles from Callington and 6 miles from Tavistock. Local amenities include a convenience store with petrol station, primary schools, public houses, and a train station offering regular services to and from Plymouth. The surrounding area boasts a wealth of scenic countryside walks, with Cotehele Estate and House, Kit Hill, and the Tamar Valley all close by.

## Key Features

- TO ARRANGE A VIEWING PLEASE QUOTE BL0650
- Two/Three Bedrooms
- Reception Room With Wood Burning Stove
- Generous-Sized Plot
- Popular Village Location
- Detached Cottage
- Private Driveway, Detached Garage & Garden Pod
- South Facing Front Garden
- Shower Room & Downstairs Cloakroom
- Freehold

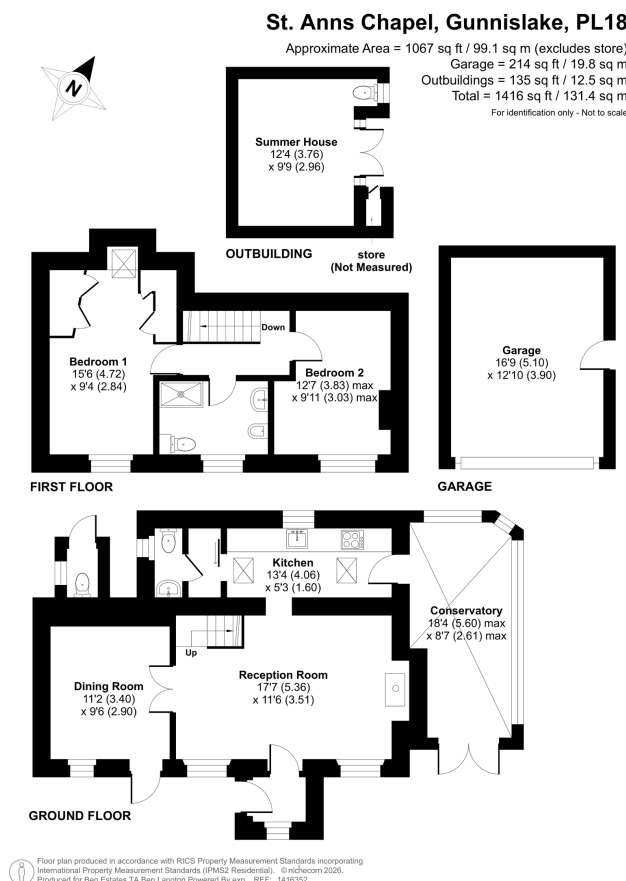

Floor plan produced in accordance with RICS Property Measurement Standards incorporating International Property Measurement Standards (IPMS2 Residential). © nrichcom 2020. Produced for Ben Estates TA Ben Langton Powered By exp. REF: 1416352