



**POOLE
TOWNSEND**

Wordsworth Street, Barrow-in-furness, LA14 5RF

£95,000

🛏️ 2 🚿 1 🛋️ 2



- 2 Bed Terraced House
- Offering Two Reception Rooms
- Two Double Bedrooms
- Modern Four-Piece Bathroom
- Convenient Roadside Parking
- Close to Local amenities
- Situated Within Easy Reach Of The Town Centre
- Providing A Comfortable Living Space
- Has Potential For Personalisation



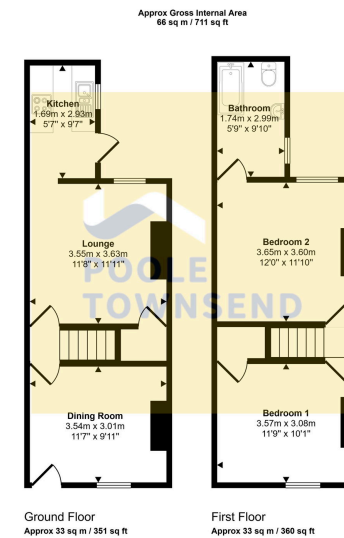

This floorplan is only for illustrative purposes and is not to scale. Measurements of rooms, doors, windows, and any items are approximate and no responsibility is taken for any error, omission or mis-statement. Icons of items such as bathroom suites are representations only and may not look like the real items. Made with Made Snappy 360.

This charming terraced home offers two reception rooms, a fitted kitchen, two double bedrooms, and a modern four-piece bathroom. The property benefits from a gas central heating system, double glazing, and convenient roadside parking. Situated within easy reach of the town centre, local amenities, and transport links, it provides a comfortable living space with potential for personalisation.

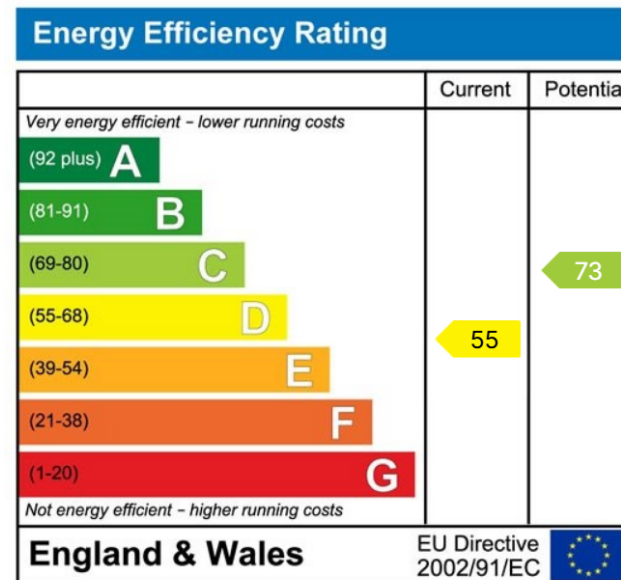

Visit us at
www.pooletownsend.co.uk
enquiries@pooletownsend.co.uk

We are open
 Monday – Friday 9.00 – 5.00
 Saturday 9.00 – 1.00

Barrow 01229 811811
 Ulverston 01229 588111
 Grange 015395 33316
 Kendal 01539 734455
 Milnthorpe 015395 62044