

Newbridge Road

ST ANNE'S PARK

APPROXIMATE FLOOR AREA
146.7 SQM / 1579 SQFT



GROUND FLOOR
735 sq.ft. (68.2 sq.m.) approx.

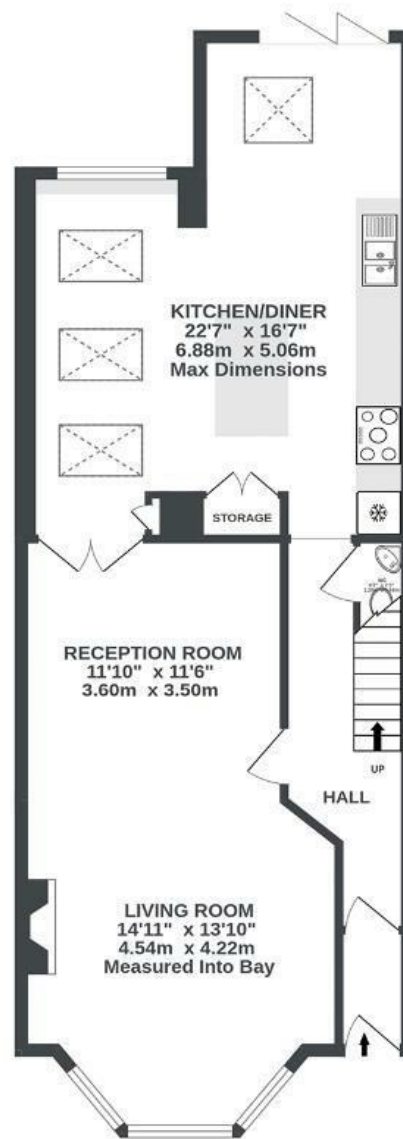

1ST FLOOR
558 sq.ft. (51.8 sq.m.) approx.



2ND FLOOR
286 sq.ft. (26.6 sq.m.) approx.

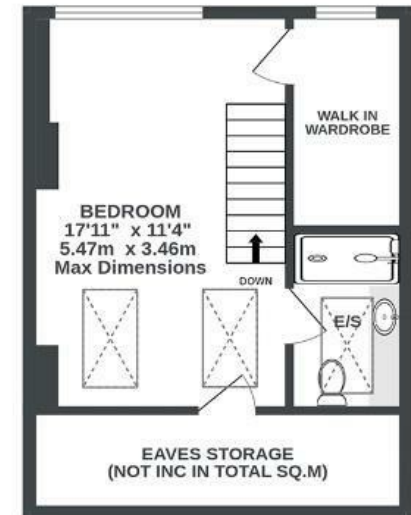

Illustrations are for reference purposes only, measurements are approximate, not to scale.

Boardwalk

Newbridge Road , BRISTOL



£575,000



4 Bedrooms



BS4 4DS



3 Bathrooms

"We love waking up in our peaceful loft room, with trees and greenery framing both the front and back windows. Although, most of our time is spent in the kitchen, bright and spacious and the perfect space for gathering friends and family. St Anne's is a hidden gem, it has a village-like quality, surrounded by the nature of the river, woods and park, but in twenty minutes you can be in the city centre."

