

London Road, South Stifford, RM20 4AD

£1,450 Per Month

Council Tax Band: B

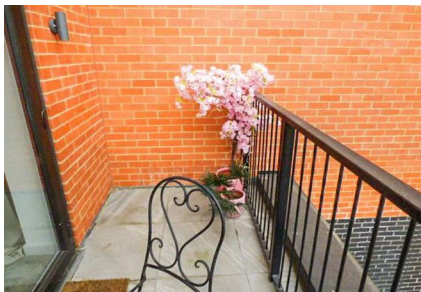

Modern One-Bedroom Apartment in Grays

Open House is delighted to present this newly built one-bedroom apartment, soon available for occupancy. Perfect for a young professional or couple, this contemporary home combines comfort, style, and convenience.

Key Features

- Modern Open-Plan Layout:** Bright and spacious lounge with a contemporary fitted kitchen, creating an inviting and versatile living space.
- Private Balcony:** A well-positioned balcony offering excellent natural light and a calm extension of the living area.
- Stylish Interiors:** Finished to a high standard throughout, including a sleek family bathroom and a generously sized double bedroom.
- Year-Round Comfort:** Double glazing and central heating ensure a warm and efficient home in every season.
- Fully Equipped Kitchen:** Includes fridge-freezer, oven with hob, extractor fan, and washing machine for everyday convenience.
- Allocated Parking:** Dedicated parking space included.
- Excellent Location:** Within walking distance of the station—ideal for commuters—with easy access to the A13, M25, and Lakeside Shopping Centre.
- Ready Soon:** Register your interest now to secure an early viewing.

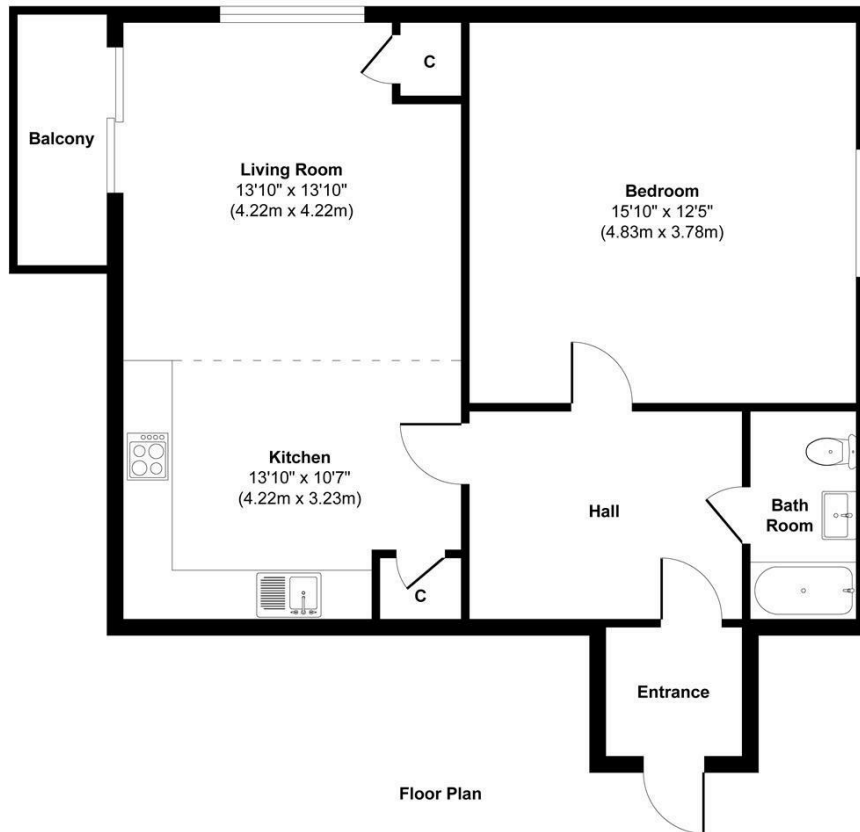

Approx. Gross Internal Floor Area 763 sq. ft / 70.88 sq. m
 Illustration for identification purposes only, measurements are approximate, not to scale.
 Produced by Elements Property



Open House Brentwood

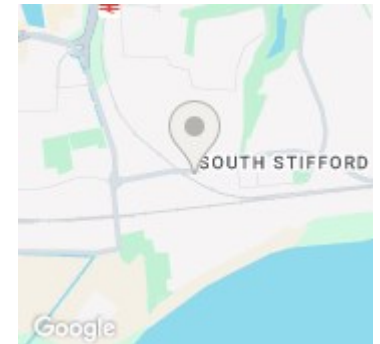

Energy Efficiency Rating		
	Current	Potential
Very energy efficient - lower running costs		
(92 plus) A		
(81-91) B	85	85
(69-80) C		
(55-68) D		
(39-54) E		
(21-38) F		
(1-20) G		
Not energy efficient - higher running costs		
England & Wales	EU Directive 2002/91/EC	