



Napier Road, Southsea, PO5 2RB

£284,999

Whether you're an investor buyer or family home buyer, this property is for you!

This property is being sold as either a four bedroom HMO or a family home in the great, sought after location of Napier Road in Southsea.

Perfectly situated between shops, cafes, bars, restaurants, bus routes and Southsea seafront, this property really does have everything to offer.

Currently a four bedroom HMO, this property would suit any investor with a high yield of 9.24%.

This property would also be perfect for a family wanting a three bedroom terrace house, with a garden, close to the sea.

The bedrooms are well proportioned doubles and the property boasts a spacious kitchen, looking out onto the garden. There is a large reception room with a large bay window, perfect for entertaining or for quiet, cosy nights in.

This property really would suit any kind of buyer and is an opportunity not to be missed.

Napier Road, Southsea, PO5 2RB

Ground Floor

Approx. 47.3 sq. metres (509.6 sq. feet)

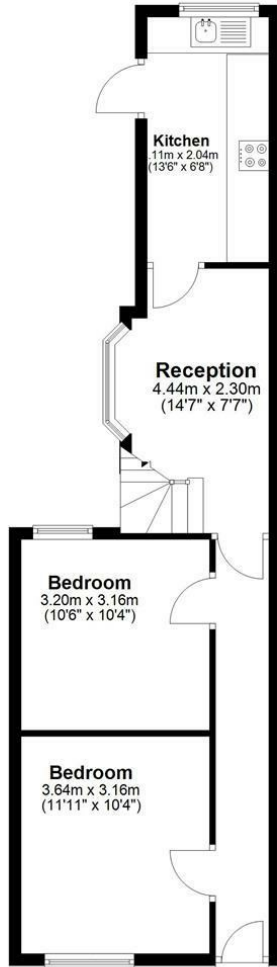

First Floor

Approx. 33.4 sq. metres (359.5 sq. feet)

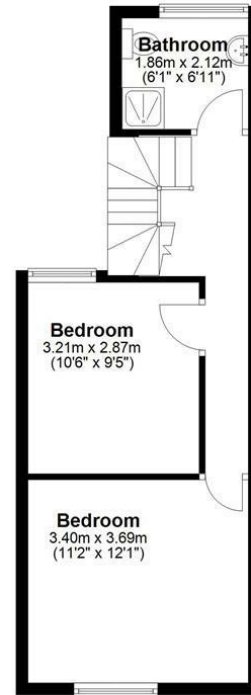

Total area: approx. 80.8 sq. metres (869.2 sq. feet)

