



Millbrooke
ESTATE AGENTS

32 Ashford Avenue, Worsley
£350,000

32 Ashford Avenue

Worsley, Manchester

Council Tax band: C

Tenure: Freehold

EPC Energy Efficiency Rating: C

EPC Environmental Impact Rating:

- Stunning Semi-Detached Bungalow
- Three Generous Bedrooms
- Two Reception Rooms
- Extended Dining / Kitchen with Integrated High-End Appliances
- Stylish, Contemporary Shower Room
- South Facing Private Garden
- Driveway & Detached Garage
- Sought After Boothstown Location
- Freehold Property
- No Onward Chain







Ashford Aveue

Total Approx. Floor Area 1260 Sq.ft. (117.1 Sq.M.)

Surveyed and drawn by Lens Media for illustrative purposes only. Not to scale. Whilst every attempt was made to ensure the accuracy of the floor plan, all measurements are approximate and no responsibility is taken for any error.

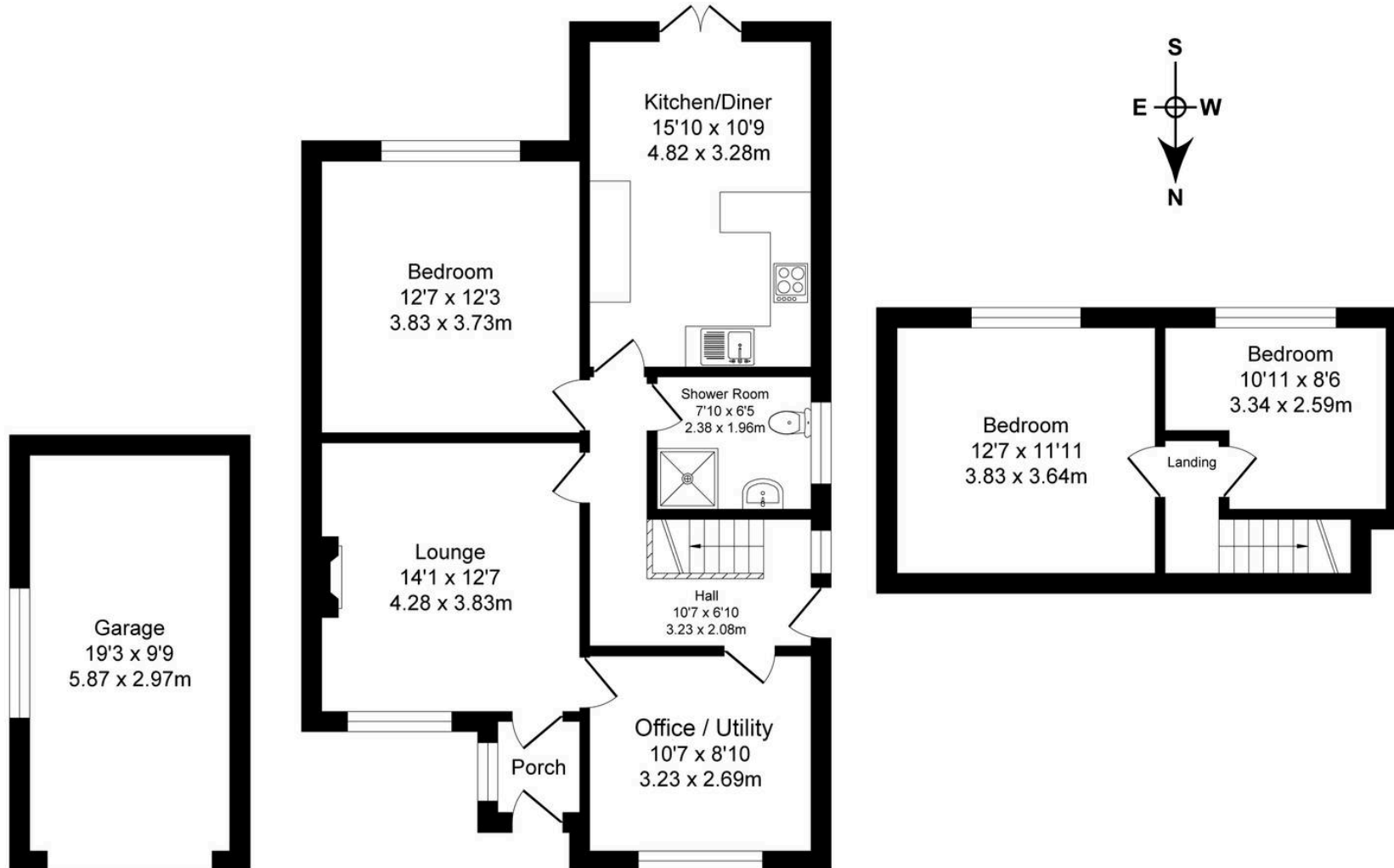

Garage
Approx. Floor Area 187 Sq.Ft (17.4 Sq.M.)

Ground Floor
Approx. Floor Area 794 Sq.Ft (73.8 Sq.M.)

First Floor
Approx. Floor Area 279 Sq.Ft (25.9 Sq.M.)



Millbrooke Estate Agents

271 Mosley Common Road, Worsley, Manchester - M28 1BZ

0161 790 5154 • hello@millbrooke.co • millbrooke.co

