



Pretty Drive, Scole Diss IP21 4DG

welcome to

Pretty Drive, Scole Diss

A three-bedroom semi detached home in the peaceful village of Scole. The home also offers a lounge with a separate kitchen space with three bedrooms upstairs and a bathroom. Also has the offering of off road parking and good size rear garden, and the added benefit of being close to amenities.

Lounge

16' 3" x 12' 7" (4.95m x 3.84m)

The lounge offers a large space which has stairs access to the bedrooms upstairs and to offer some natural lighting coming in from a window from the side aspect of the house.

Parking

Off road parking for 2 cars.

Kitchen

12' 6" x 8' 1" (3.81m x 2.46m)

Wall and base units for storage and with a stainless steel built in sink. Also offering natural lighting coming from the window that is at the side aspect of the property.

Landing

Doors leading to all bedrooms and having access to an airing cupboard.

Bedroom 1

12' 7" x 8' 2" (3.84m x 2.49m)

Carpet flooring, radiator and a window to the side aspect of the property.

Bedroom 2

12' 6" x 8' 2" (3.81m x 2.49m)

Carpet flooring, dual aspect windows to the side and rear aspect, built in cupboard for extra storage.

Bedroom 3

7' 7" x 5' 4" (2.31m x 1.63m)

Carpet flooring, window to side aspect, radiator.

Bathroom

Hard flooring, window to side aspect of the property, W/C, hand wash basin, bath with an over head shower.

Rear Garden

Small patio with a fully turfed garden.

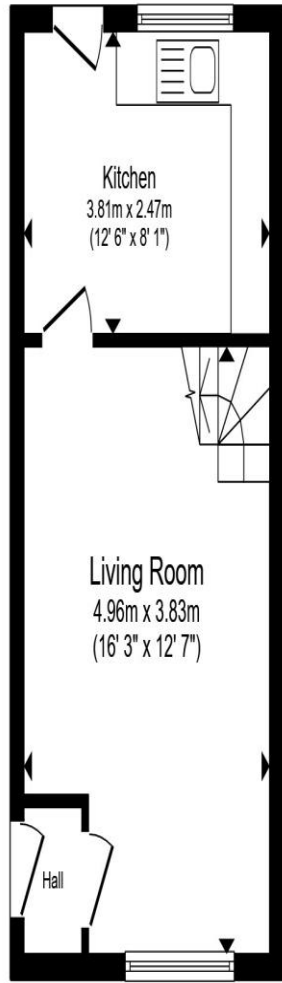

Ground Floor

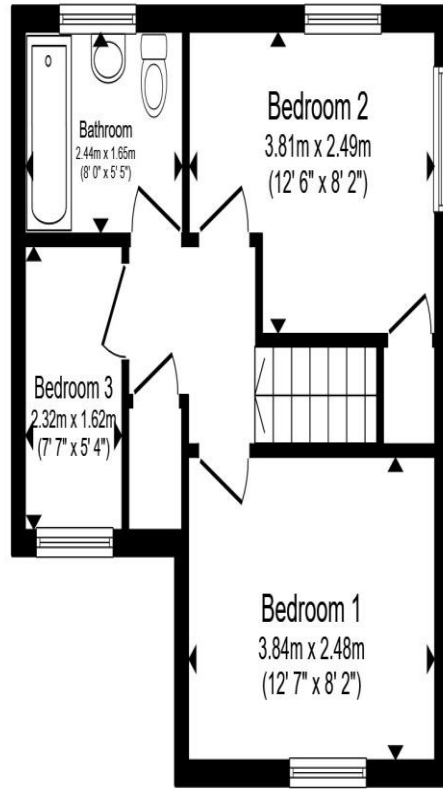

First Floor

Total floor area 61.7 m² (664 sq.ft.) approx

This floor plan is for illustrative purposes only. It is not drawn to scale. Any measurements, floor areas (including any total floor area), openings and orientation are approximate. No details are guaranteed, they cannot be relied upon for any purpose and they do not form part of any agreement. No liability is taken for any error, omission or misstatement. A party must rely upon its own inspection(s). Powered by www.propertybox.io



welcome to
Pretty Drive,
Scale Diss

- No Onward Chain
- Three-bedroom semi detached home
- Great sized rear garden
- Off Road Parking for 2 cars
- Perfect for FIRST TIME BUYERS

Tenure: Freehold EPC Rating: D
Council Tax Band: B

£200,000



view this property online williamhbrown.co.uk/Property/DSS111415



Property Ref:
DSS111415 - 0004

1. MONEY LAUNDERING REGULATIONS Intending purchasers will be asked to produce identification documentation at a later stage and we would ask for your co-operation in order that there is no delay in agreeing the sale. 2. These particulars do not constitute part or all of an offer or contract. 3. The measurements indicated are supplied for guidance only and as such must be considered incorrect. Potential buyers are advised to recheck measurements before committing to any expense. 4. We have not tested any apparatus, equipment, fixtures or services and it is in the buyers interest to check the working condition of any appliances. 5. Where an EPC, or a Home Report (Scotland only) is held for this property, it is available for inspection at the branch by appointment. If you require a printed version of a Home Report, you will need to pay a reasonable production charge reflecting printing and other costs. 6. We are not able to offer an opinion either written or verbal on the content of these reports and this must be obtained from your legal representative. 7. Whilst we take care in preparing these reports, a buyer should ensure that his/her legal representative confirms as soon as possible all matters relating to title including the extent and boundaries of the property and other important matters before exchange of contracts.

William H Brown is a trading name of Sequence (UK) Limited which is registered in England and Wales under company number 4268443, Registered Office is Cumbria House, 16-20 Hockliffe Street, Leighton Buzzard, Bedfordshire, LU7 1GN. VAT Registration Number is 500 2481 05.



william h brown



01379 644719



Diss@williamhbrown.co.uk



1 Navire House Mere Street, DISS, Norfolk,
IP22 4AG



williamhbrown.co.uk