



BOUNDARIES ROAD, SW12

£625,000

Two double bedrooms
Two bathrooms
Secure/Gated
Two private balconies
Communal gardens
0.2 Miles from station

@marshandparsons
marshandparsons.co.uk

MARSH &
PARSONS



ABOUT THE PROPERTY

Situated in a desirable gated development this two double bedroom, two bathroom apartment offers so much more than the standard modern build. With tasteful styling throughout, this flat has a spacious living room and two private balconies.

Penrose Court is a quiet gated development, tucked away in the heart of Balham. Balham station is just 0.2 miles away, offering frequent National Rail and Northern line services. There is an incredible local buzz with a wide range of local restaurants, coffee shops and pubs to choose from.



STEP INSIDE BOUNDARIES ROAD

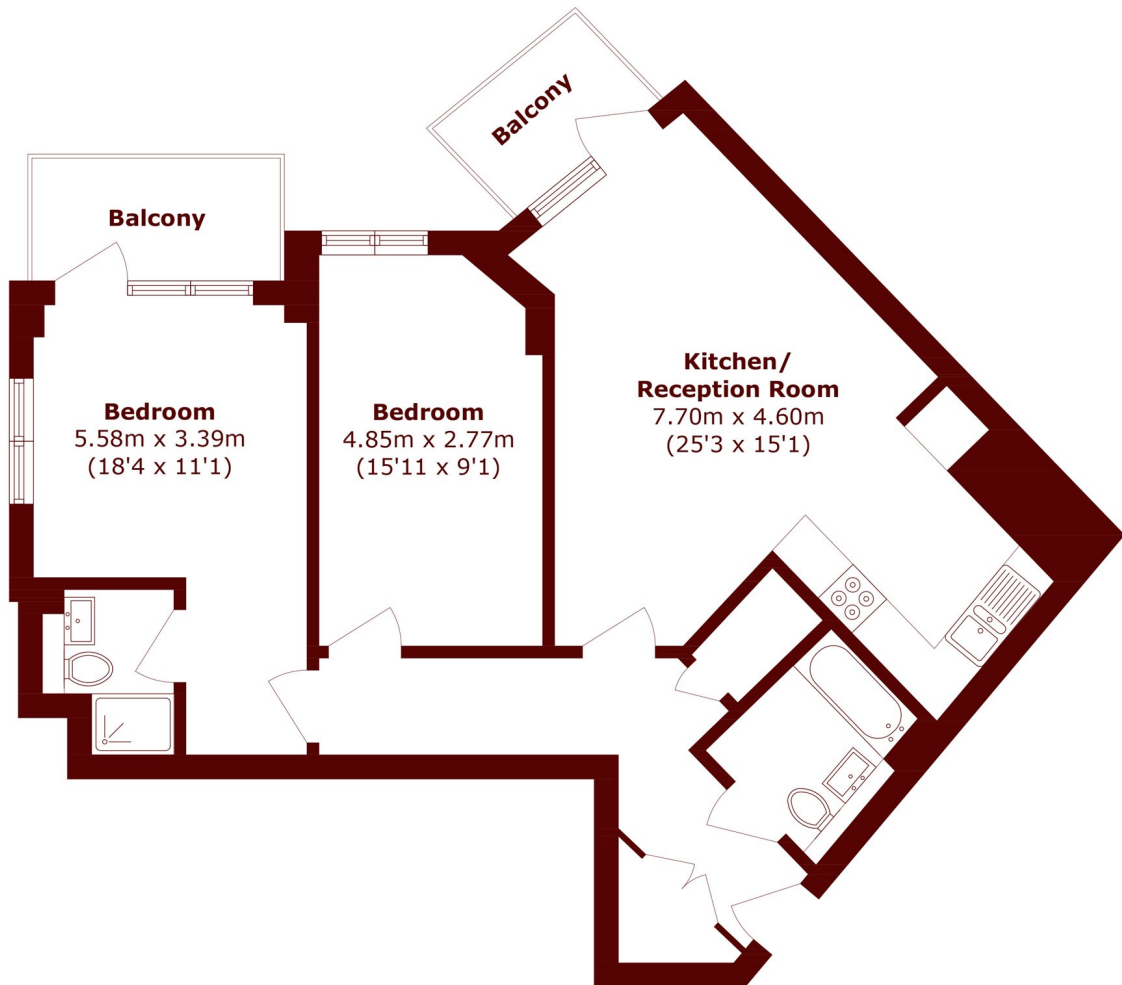

Total area (approx.): 79.4 sq. m (854.7 sq. ft)

Balcony area (approx.): 8.42 sq. m (90.6 sq. ft)

Balham & Clapham South
020 7326 9920

Energy Rating: B We aim to make our particulars both accurate and reliable. However, they are not guaranteed; nor do they form part of an offer or contract. If you require clarification on any points then please contact us, especially if you're traveling some distance to view. Please note that appliances and heating systems have not been tested and therefore no warranties can be given as to their good working order

**MARSH &
PARSONS**