



# Bridgewater Close, Nottingham

Two-bedroom  
ground floor apartment  
available to buy through  
shared ownership

“

A home of your  
own at a price  
you can afford

”

 ncha

# Specifications

## Kitchen

- Fitted modern kitchen
- Integrated appliances
- Angled extractor hood
- Contemporary mixer taps
- Luxury vinyl flooring

## Bathroom

- Porcelanosa white suite with chrome fittings
- Tiling to ceiling around the bath
- Shower over bath
- Glass shower screen
- Luxury vinyl flooring

## Heating

- Gas fired central heating
- Thermostatic radiator valves
- Double glazed windows

## External

- EV charger
- Allocated off-street parking
- Cycle store

## Decoration

- White emulsion walls and ceilings
- White gloss painted woodwork

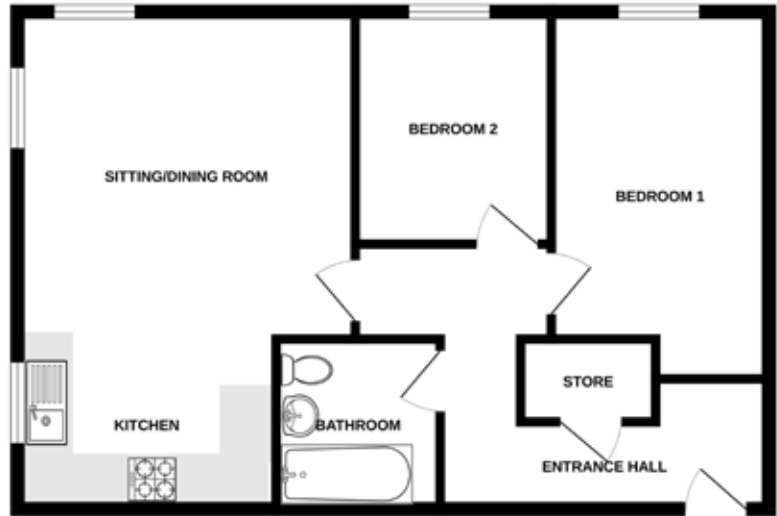

Floor plan

## Energy assessment

- Predicted energy assessment – B

## Key dimensions

Room	Dimensions
Living dining	4201mm x 4487mm
Kitchen	3203mm x 2134mm
Bedroom 1	5009mm x 2690mm
Bedroom 2	3185mm x 2482mm

Any measurements quoted are approximate and must be checked on site and against the layout, which may vary due to unforeseen circumstances. Floor plans may be mirror handed. These details have been produced for illustrative purposes only and does not form any part of a contract or constitute an offer. Actual specification may vary from that shown in floor plan.

## How to find us

The development is located on Bridgewater Close, off Trent Lane in Nottingham. If using a SatNav, the postcode is NG2 4RT.

## Buying more shares

This apartment is sold on a standard shared ownership lease. You can staircase up to 100%, at which point the leasehold title remains in your name, but your shared ownership obligations fall away.



0345 650 1204  
nchasales@ncha.org.uk  
www.ncha.org.uk

@NCHASalesTeam  
@NCHASales