



35a Burford Road, Carterton OX18 3AQ

Draft details - may be subject to alterations.

A 1 bedroom first floor apartment, with spacious rooms and its own front door. Set in a small development of 6 similar properties, with mature communal gardens, and a parking space. Accommodation includes a hall, living/dining/kitchen, a bedroom and bathroom, double glazing and electric heating. The property is situated within walking distance of Carterton town centre, and would offer an excellent first-time purchase.

**THOMAS
MERRIFIELD**

SALES LETTINGS

e. witney@thomasmerrifield.co.uk

t. 01993 772000

Price £159,950

www.thomasmerrifield.co.uk



35a Burford Road, Carterton, Oxfordshire OX18 3AQ

- Own Front Door Entrance
- Entrance Hall
- Living/Dining Room/Kitchen
- Bedroom
- Bathroom
- Double Glazing & Electric Heating
- Communal Gardens
- Parking Space
- No Onward Chain
- Walking Distance Of Town Centre

Directions - From Carterton town centre proceed along Burford Road and the apartment will be found on the left hand side

35A Burford Road
 Total Approx. Floor Area 685 Sq.Ft. (63.60 Sq.M.)
 All items illustrated on this plan are included in the "Total Approx Floor Area"

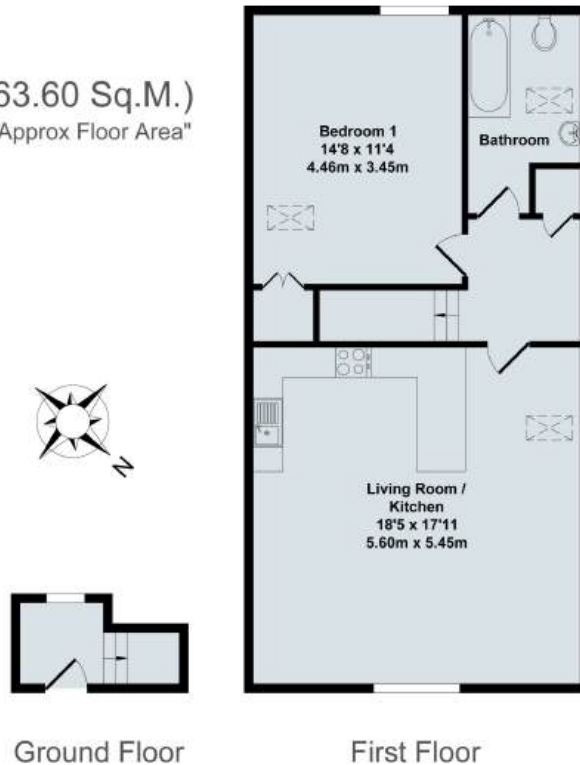

Local Authority:

WODC Tax Band B / EPC Rating: 68/D

Contact:

52 Market Square, Witney,
Oxfordshire, OX28 6AF

Material Information - sourced from Ofcom:

All mains services are connected except gas.
Ultrafast broadband is available. Mobile & Data
Signals - Outdoor: good for EE, O2 & Vodafone.
Indoor: good for EE, O2 & Vodafone.

Tenure:

Leasehold - Upon sale the sellers plan to create a new 999 year lease
with zero ground rent, and an appropriate service charge to be decided.

Tel: 01993 772000

Email: witney@thomasmerrifield.co.uk

Important Notice

Thomas Merrifield for themselves and their clients give notice that:-

1. They are not authorised to make or give representation or warranty in relation to this property, either on their own behalf or on behalf of the Seller. They assume no responsibility for any statement made in these particulars. These particulars do not form part of any offer or contract and must not be relied upon as statements or representations of fact.
2. Whilst every attempt has been made to ensure the accuracy of the floorplan contained here, measurements of doors, windows, rooms and any other items are approximate and no responsibility is taken for any error, omission, or mis- statement.
3. All areas, measurements or distances are approximate. The particulars are intended for guidance only and are not necessarily comprehensive. A wide angle lens may have been used in photography. Thomas Merrifield have not tested appliances or services and it should not be assumed that the property has all necessary planning, building regulation and other consents. Buyers must satisfy themselves with the property by inspection or otherwise.
4. Reference to any mechanical or electrical equipment does not constitute a representation that such equipment is capable of fulfilling its function and prospective Buyers must make their own enquiries.
5. They have no responsibility for any expenses or costs incurred by prospective Buyers in inspecting properties which have been sold, let or withdrawn. Applicants are advised to contact the Agent to check availability and any other information of particular importance to them, prior to inspecting the property, particularly if travelling some distance.