



## 70 Long Row, Ditherington, Shrewsbury, Shropshire, SY1 4DD

**Offers in the Region Of £200,000**

**A much-loved 3-bedroom semi-detached house which has been in the family for over 50 years, with the rare benefit of a generous driveway and garage.**



This much-loved family home has been well cared for by one family for over 50 years. Located at the far end of Long Row, close to Mount Pleasant Road, the semi-detached house enjoys the rare addition of a garage and ample driveway parking. Entering the property through an enclosed porch, which leads to the entrance hall, and the living room, which is situated to the front of the house, and to the rear is a generous kitchen/dining room with a walk-in pantry. From the kitchen, a door leads to the utility room with an adjoining garden WC. The garage is also accessed from the porch. Upstairs there are two double bedrooms and good size third bedroom, along with a modern, refitted bathroom. To the rear of the property is an enclosed garden with a variety of patios and shrubs. We are sure you will agree that this is a good value for money, a 3-bedroom family home that is worthy of your consideration. No upward chain.

Approx Gross Internal Area  
98 sq m / 1054 sq ft

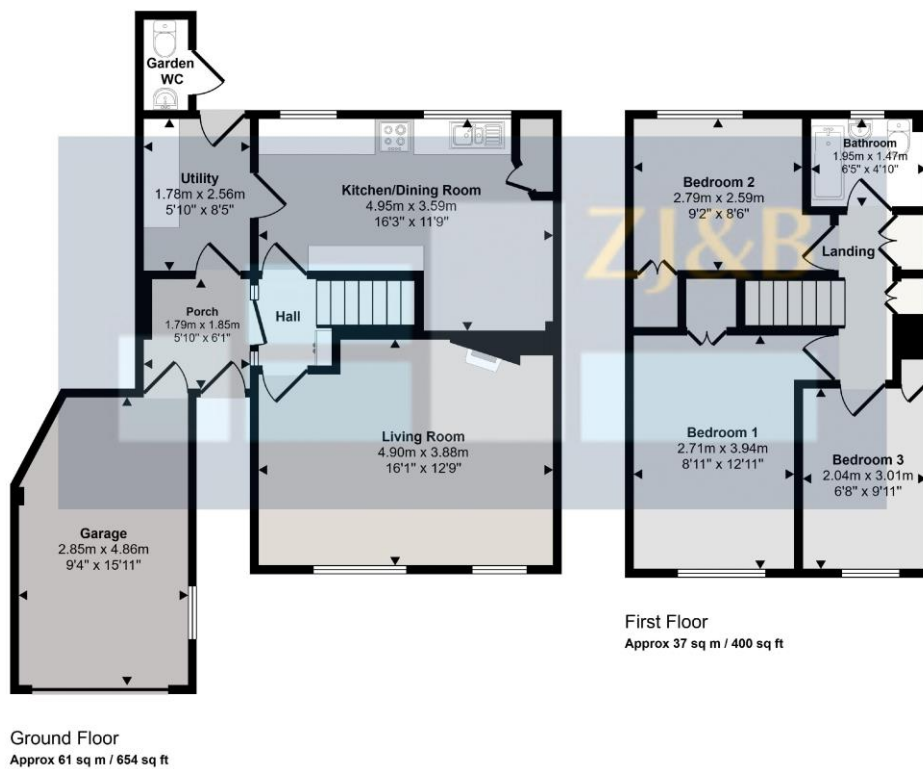

This floorplan is only for illustrative purposes and is not to scale. Measurements of rooms, doors, windows, and any items are approximate and no responsibility is taken for any error, omission or mis-statement. Icons of items such as bathroom suites are representations only and may not look like the real items. Made with Made Snappy 360.

FLOOR PLANS FOR GUIDANCE ONLY

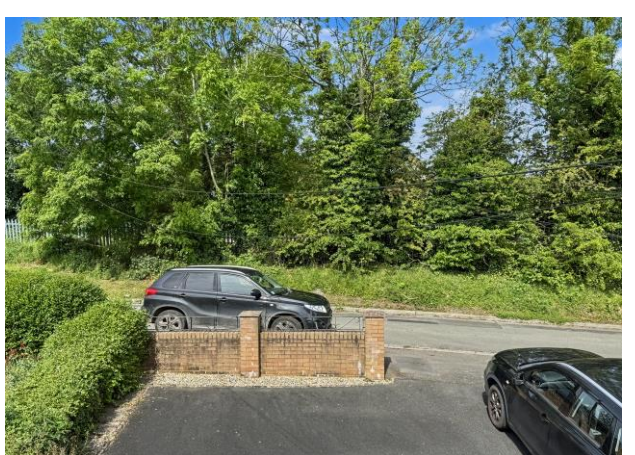

### **Council Tax Band B**

**Tenure:** Our client advises us that the property is Freehold. Should you proceed with the purchase of the property, these details must be verified by your solicitor.

**NB:** The mention of any appliances and/or services within these sales particulars does not imply that they are in full and efficient working order.

**Viewing:** To arrange a viewing call in at our office or telephone **01743 248351**

### **FREE MORTGAGE ADVICE**

Whether you are a first-time buyer, moving home, buying as an investor or looking to save on your mortgage payments, you could benefit from some **free** no obligation mortgage advice.

Contact **Stephen Bath** of Bee Mortgages, who is based at our office

**01743 248351**

**Whole of Market** clear and relevant tailored to your individual needs and circumstances.

**Your home may be repossessed if you do not keep up repayments on your mortgage**