



15 Broadoaks Close, Chesterfield

£185,000 Freehold

Three bedroom end-terrace in Broadoaks Close, Chesterfield. Spacious reception, kitchen with dining space, shower room, driveway for two cars, enclosed garden. Close to amenities.

Council Tax band: A

Tenure: Freehold

NESTLED IN THE CHARMING AREA OF BROADOAKS CLOSE, CHESTERFIELD, THIS DELIGHTFUL END-TERRACE HOUSE OFFERS A PERFECT BLEND OF COMFORT AND CONVENIENCE. AN OPPORTUNITY NOT TO BE MISSED...

Spanning an inviting 796 square feet, the property features three well-proportioned bedrooms, making it an ideal choice for families or those seeking extra space.

Upon entering, you are welcomed into a spacious reception room that provides a warm and inviting atmosphere, perfect for both relaxation and entertaining. The layout is thoughtfully designed to maximise space and light, creating a homely feel throughout, with built in storage.

The property boasts a well-appointed shower room, ensuring that all your daily needs are met with ease. The kitchen is the focal point in homes of this nature, offering ample opportunity for culinary creativity and space for a dining table.

Outside, you will find block paved driveway parking available for two vehicles, adding to the convenience of this lovely home. To the rear is an enclosed landscaped garden with lawn, patio and shed. The location in Chesterfield is particularly appealing, with local amenities, schools, and parks within easy reach, making it a desirable area for families and professionals alike.

In summary, this end-terrace house on Broadoaks Close presents a wonderful opportunity for those looking to settle in a friendly community. With its three bedrooms, spacious reception area, and practical parking, it is a property that promises both comfort and functionality. Do not miss the chance to make this charming house your new home.

VIDEO TOUR AVAILABLE - TAKE A LOOK AROUND

Call Pinewood Properties for more information and to book a viewing





LOUNGE

11' 1" x 16' 9" (3.39m x 5.11m)

This lovely room has a huge amount of space, feature fireplace and a fitted carpet, completed by the large uPVC window and central heating radiator beneath it.

KITCHEN / DINER

12' 11" x 13' 5" (3.94m x 4.08m)

The kitchen/diner features laminate flooring, laminate worktops and striking red tiled splash back creating a unique and spacious room, perfect for entertaining guests or feeding the family. It also features a sink and drainer, space for a dishwasher and a large uPVC window overlooking the front.

BEDROOM 1

12' 11" x 10' 2" (3.94m x 3.11m)

The principal bedroom features a lovely fitted carpet, a central heating radiator and a uPVC window.

BEDROOM 2

11' 1" x 10' 2" (3.38m x 3.11m)

The second bedroom is a double bedroom, featuring a fitted carpet, central heating radiator and a UPVC window overlooking the rear of the property.

BEDROOM 3

7' 9" x 6' 1" (2.36m x 1.86m)

The smallest room is a single bedroom featuring a fitted carpet, central heating radiator and a uPVC window.

SHOWER ROOM

8' 0" x 6' 3" (2.45m x 1.90m)





LOUNGE

11' 1" x 16' 9" (3.39m x 5.11m)

This lovely room has a huge amount of space, feature fireplace and a fitted carpet, completed by the large uPVC window and central heating radiator beneath it.

KITCHEN / DINER

12' 11" x 13' 5" (3.94m x 4.08m)

The kitchen/diner features laminate flooring, laminate worktops and striking red tiled splash back creating a unique and spacious room, perfect for entertaining guests or feeding the family. It also features a sink and drainer, space for a dishwasher and a large uPVC window overlooking the front.

BEDROOM 1

12' 11" x 10' 2" (3.94m x 3.11m)

The principal bedroom features a lovely fitted carpet, a central heating radiator and a uPVC window.

BEDROOM 2

11' 1" x 10' 2" (3.38m x 3.11m)

The second bedroom is a double bedroom, featuring a fitted carpet, central heating radiator and a UPVC window overlooking the rear of the property.

BEDROOM 3

7' 9" x 6' 1" (2.36m x 1.86m)

The smallest room is a single bedroom featuring a fitted carpet, central heating radiator and a uPVC window.

SHOWER ROOM

8' 0" x 6' 3" (2.45m x 1.90m)





GROUND FLOOR
36.8 sq.m. (396 sq.ft.) approx.

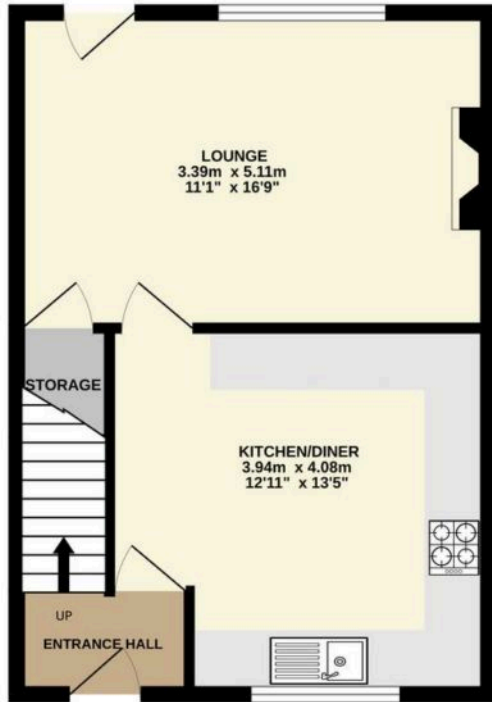

1ST FLOOR
37.2 sq.m. (400 sq.ft.) approx.

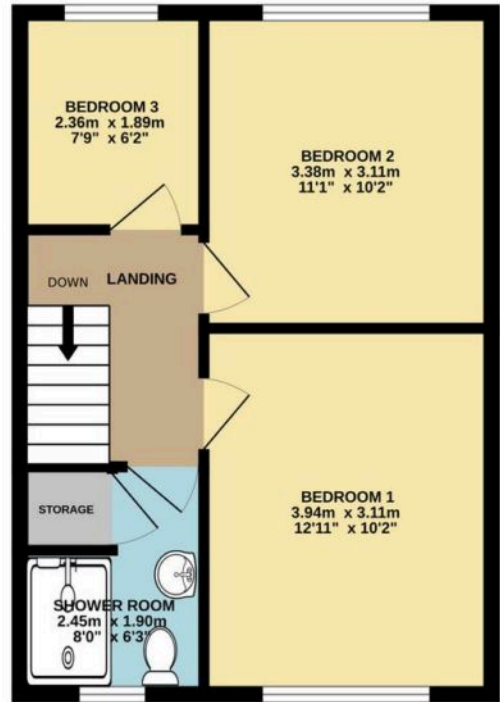

TOTAL FLOOR AREA: 74.0 sq.m. (796 sq.ft.) approx.

Whilst every attempt has been made to ensure the accuracy of the floorplan contained here, measurements of doors, windows, rooms and any other items are approximate and no responsibility is taken for any error, omission or mis-statement. This plan is for illustrative purposes only and should be used as such by any prospective purchaser. The services, systems and appliances shown have not been tested and no guarantee as to their operability or efficiency can be given.
Made with Metropix ©2025

You can include any text here. The text can be modified upon generating your brochure.

Council Tax band: A

Tenure: Freehold

EPC Energy Efficiency Rating: D

EPC Environmental Impact Rating: D

