



*Jordan fishwick*

Robinsway

# Robinsway, WA14 3ER

Offers In Excess Of £365,000



## The Property

A beautifully renovated two-bedroom semi-detached freehold home, ideally positioned on the ever-popular Robins Way in Bowdon. This stylish property has been thoughtfully updated throughout, offering modern living accommodation perfect for first-time buyers, young families, or those looking to downsize without compromise.

The home benefits from a private driveway providing off-road parking, along with a well-maintained rear garden ideal for entertaining, relaxing, or family use. Internally, the home has a large living room and separate kitchen. On the second floor there are two generous double bedrooms with a stylish family bathroom. The property has undergone recent renovation works, creating a fresh and contemporary finish ready for immediate occupation.

Situated within catchment for several highly regarded local schools, including St Vincent's Catholic Primary School, Well Green Primary School, and Altrincham College, the property is also conveniently located for access to Hale village, Altrincham town centre, local amenities, and excellent transport links.

Early viewing is highly recommended to appreciate the quality of accommodation and sought-after location on offer.

## Directions

WA14 3ER



- No Onward Chain
- Off Road Parking
- South Facing Rear Garden
- Two Double Bedrooms
- Modernised Throughout
- Freehold
- Lounge Diner
- Catchment for Highly Regarded Schools
- Walking Distance to Local Amenities
- Easy Access to Motorway Links

Postcode - WA14 3ER

EPC Rating -

Floor Area - 819.00 sq ft

Local Authority -

Council Tax - A



# 7, Robins Way, Bowdon

## Total Approx. Floor Area 819 Sq.ft. (76.1 Sq.M.)

Surveyed and drawn by Lens Media for illustrative purposes only. Not to scale. Whilst every attempt was made to ensure the accuracy of the floor plan, all measurements are approximate and no responsibility is taken for any error.

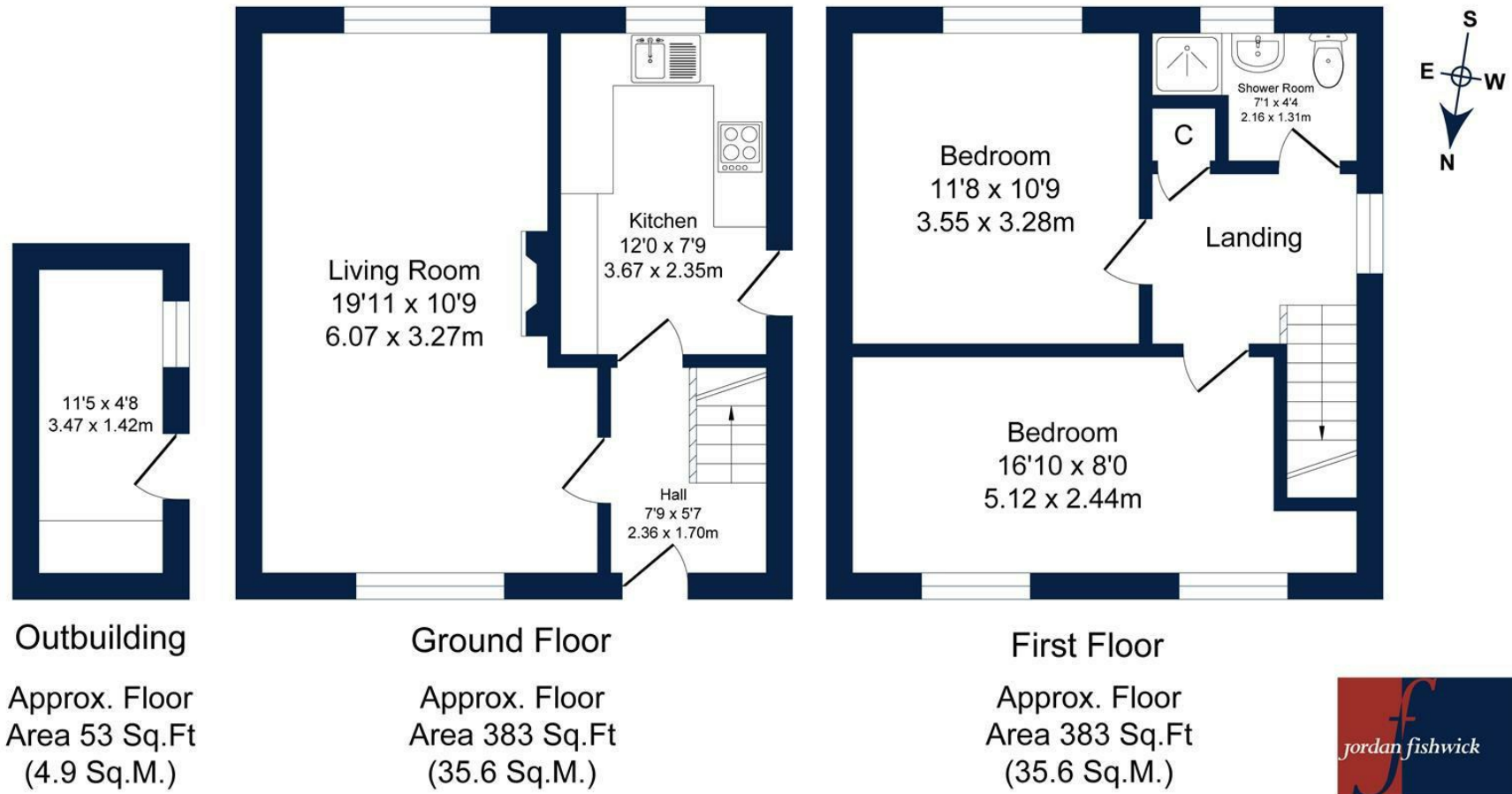

These particulars are believed to be accurate but they are not guaranteed and do not form a contract. Neither Jordan Fishwick nor the vendor or lessor accept any responsibility in respect of these particulars, which are not intended to be statements or representations of fact and any intending purchaser or lessee must satisfy himself by inspection or otherwise as to the correctness of each of the statements contained in these particulars. Any floorplans on this brochure are for illustrative purposes only and are not necessarily to scale.

Offices at: Chorlton, Didsbury, Disley, Hale, Glossop, Macclesfield, Manchester Deansgate, Manchester Whitworth Street, New Mills, Sale, Wilmslow and Withington

0161 929 9797

[hale@jordanfishwick.co.uk](mailto:hale@jordanfishwick.co.uk)  
[www.jordanfishwick.co.uk](http://www.jordanfishwick.co.uk)

