



Cumberland Street, Latchford, Warrington

Offers Over £140,000

🛏️ 2 🚿 1 🚗 2



Offering to the market this traditional two-bedroom mid-terrace property, presenting an ideal opportunity for first-time buyers and investors alike, situated in the ever-popular area of Latchford.

Conveniently positioned close to a wide range of local amenities, the property also benefits from excellent access to both Latchford Village and Warrington town centre, making it a fantastic choice for commuters and families alike.

Benefiting from gas central heating and uPVC double glazing throughout, the accommodation briefly comprises a welcoming living room, separate dining room featuring an attractive open-plan staircase, a fitted kitchen offering a range of wall and base units, rear hallway with useful storage cupboard, and a family bathroom.

To the first floor are two generous bedrooms, whilst externally the property enjoys a low-maintenance rear yard.

Early viewing is highly recommended to appreciate the potential and convenient location this property has to offer.



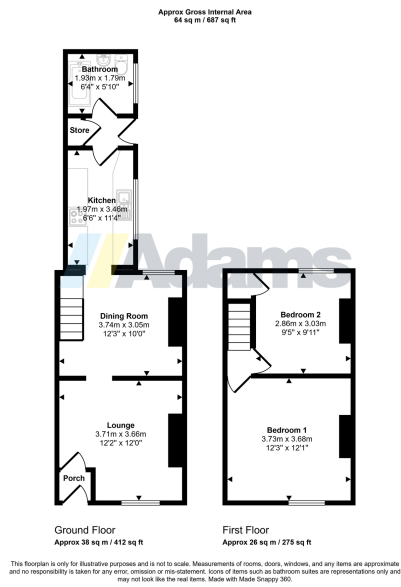

- Two Bedroom
- Two Reception Rooms
- Ideal Investment or First Time Buy
- Council Tax: A. EPC: D.
- Traditional Terrace
- Conveniently Located
- Leasehold Tenure

